

SPECIFICATION FOR APPROVAL

REF :

PAGE: 1

PROD. NAME	SHIELDED SMD POWER INDUCTOR	ABC'S DWG NO.	SE1509□□□□L□
		ABC'S ITEM NO.	

I . CONFIGURATION & DIMENSIONS :

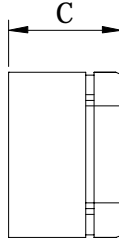
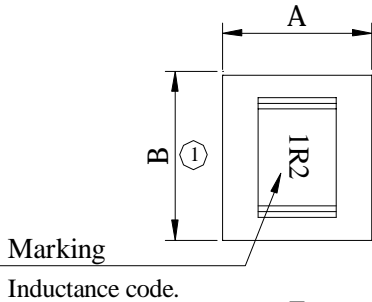

A : 15.0±0.4	m/m
B : 15.0±0.4	m/m
C : 9.5±0.5	m/m
D : 7.8±0.5	m/m
E : 4.0±0.25	m/m
F : 10.0 ref.	m/m
G : 15.6 ref.	m/m
H : 8.6 ref.	m/m
I : 2.8 ref.	m/m
J : 4.4 ref.	m/m
K : 3.2 ref.	m/m
M : 2.8 ref.	m/m
N : 9.2 ref.	m/m

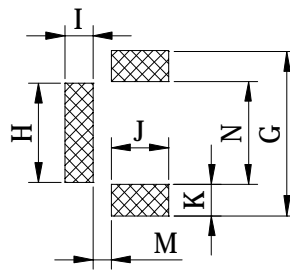
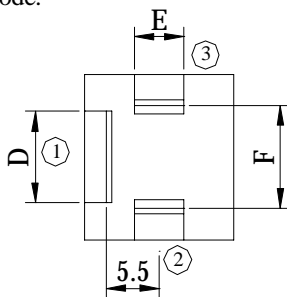

(PCB Pattern)

II . SCHEMATIC DIAGRAM :



III . MATERIALS LIST :

- a . Core : Ferrite core EPC14.5-A
- b . Bobbin : Nylon 46 EPC14.6 bobbin
- c . Base : PM-9630 EPC 14.6 base
- d . Wire : Tinned copper foil (Sn 100%)
- e . Tape : KAPTON & Mylar

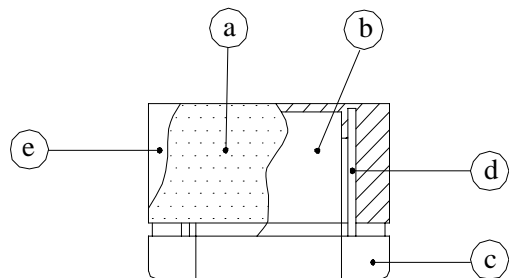

Peak Temp : 260°C max.
 Max time above 230°C : 50sec max.
 Max time above 200°C : 70sec max.

IV . GENERAL SPECIFICATION :

- a . Temp. rise : 40°C max.
- b . Irms base on temp. rise & ΔL/L0A=10% max.
- c . Storage temp. : -40°C ~ +125°C
- d . Operating temp. : -40°C ~ +105°C
- e . Resistance to solder heat : 260°C, 10 sec.

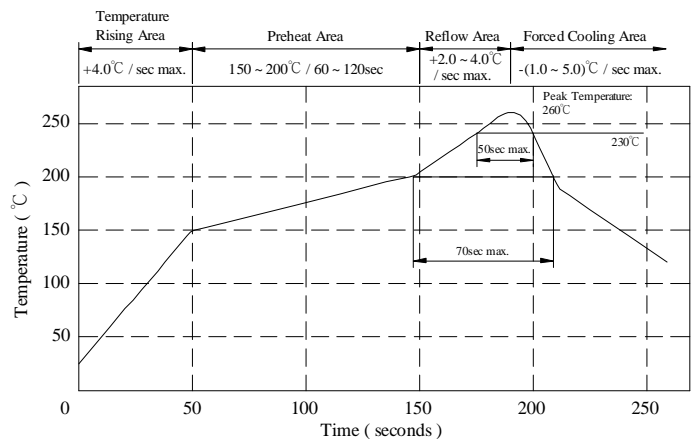

AE-001A

SPECIFICATION FOR APPROVAL

REF :

PAGE: 2

PROD. NAME	SHIELDED SMD POWER INDUCTOR	ABC'S DWG NO. ABC'S ITEM NO.	SE1509□□□□L□
---------------	--------------------------------	---------------------------------	--------------

V . ELECTRICAL CHARACTERISTICS :

DWG. No.	Inductance (uH)	RDC (mΩ) max.	Irms (A) (ΔT=40°C max.) max.	Isat (A) (ΔL/L0A=20%) typ.
SE15091R2ML□	1.20±20%	2.0	16.0	19.0
SE15091R4ML□	1.40±20%	2.0	15.0	18.0
SE15091R8ML□	1.80±20%	3.0	14.0	18.0
SE15092R0ML□	2.00±20%	3.0	13.0	16.0
SE15092R5ML□	2.50±20%	3.4	12.0	14.5
SE15092R8ML□	2.80±20%	3.4	12.0	14.0
SE15093R0ML□	3.00±20%	4.3	10.0	13.0
SE15093R6ML□	3.60±20%	4.3	10.0	12.0
SE15093R9ML□	3.90±20%	6.5	9.0	11.5
SE15094R5ML□	4.50±20%	6.5	8.0	10.5
SE15094R8ML□	4.80±20%	7.2	7.0	10.0
SE15095R6ML□	5.60±20%	7.2	6.0	9.0

- 1). □ : Packaging information ... [A] : Bulk [B] : Taping Reel
- 2). Inductance Test Freq. : 100KHz, 1V
- 3). Irms base on temp. rise at 40°C max. and inductance drop 10% max.
- 4). Isat base on ΔL/L0A=20% typ.

@ Inductance VS. DC Superposition Characteristics

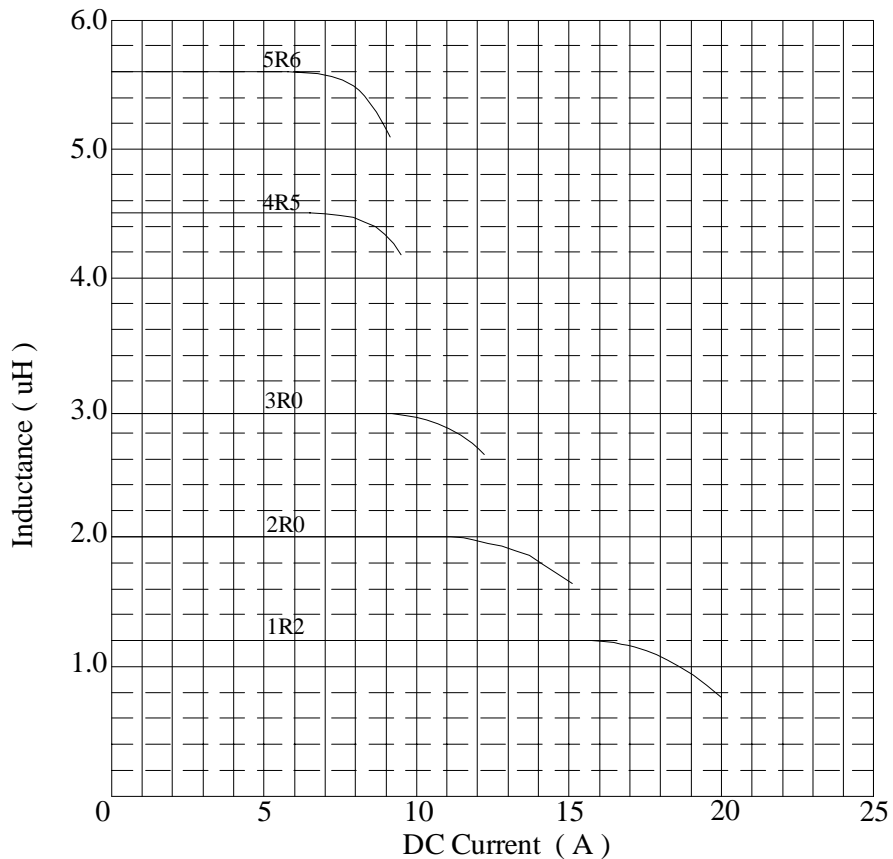

AE-001A

SPECIFICATION FOR APPROVAL

REF :

PAGE: 3

PROD. NAME	SHIELDED SMD POWER INDUCTOR	ABC'S DWG NO.	SE1509□□□□L□
		ABC'S ITEM NO.	

VI . PACKAGING INFORMATION :

(1) Configuration

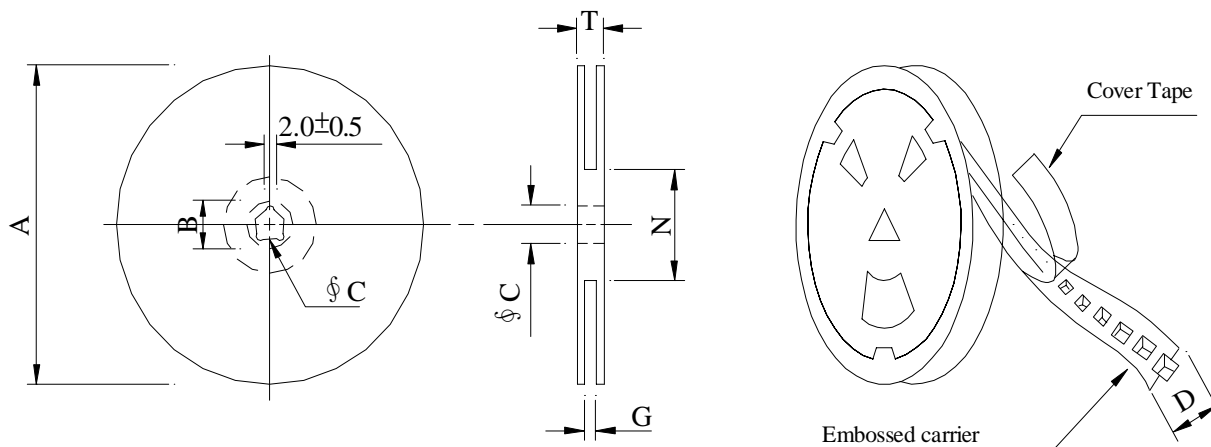

※Carrier tape width : D

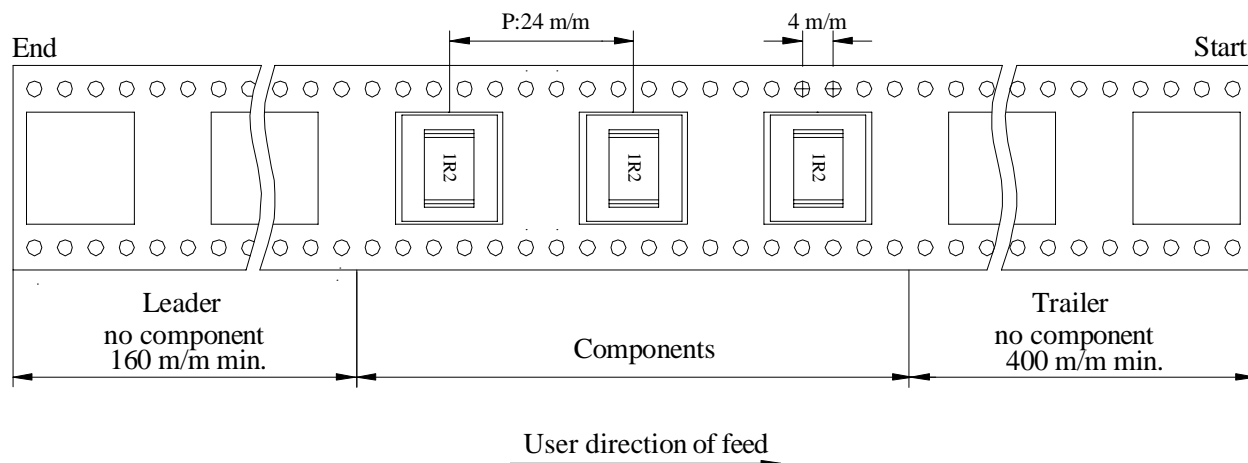

(2) Dimensions

Unit:m/m

Style	A	B	C	D	G	N	T
13 - 32	330	21±0.8	13	32	34 ⁺⁰	100 ⁻⁰	38.4

(3) Q'TY & G.W. Per package

Series	Inner : Reel			Outer : Carton		
	Q'TY (pcs)	G.W. (gw)	Style	Q'TY (pcs)	G.W. (Kg)	Size (cm)
SE1509	200	1,370	13 - 32	800	6.8	40 x 40 x 24

AE-001A

SPECIFICATION FOR APPROVAL

REF :

PAGE: 4

PROD. NAME	SHIELDED SMD POWER INDUCTOR	ABC'S DWG NO. ABC'S ITEM NO.	SE1509□□□□L□
---------------	--------------------------------	---------------------------------	--------------

VII . DWG EXPRESSION :

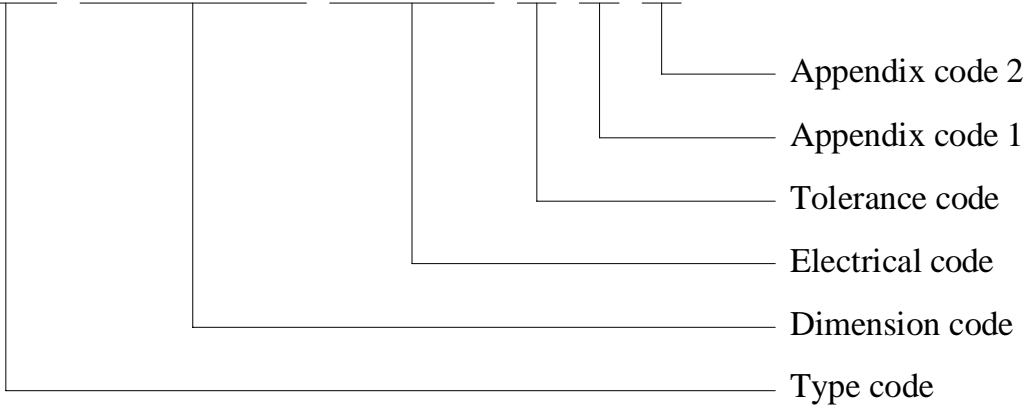
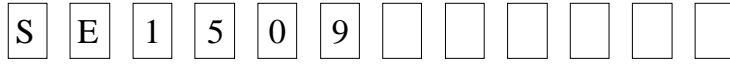

- Appendix code 1 : S : Standard products
 A~K , M~R , T~Z : Special products
 L : Standard Lead Free products
 1 ~ 9 : Special Lead Free products

Appendix code 2 :

Code	Inner package	Inner package Q'TY	Remark
A	Empty	Empty	
B	T/R (Reel package)	200 pcs	

SPECIFICATION FOR APPROVAL

REF :

PAGE: 5

PROD. NAME	SHIELDED SMD POWER INDUCTOR	ABC'S DWG NO. ABC'S ITEM NO.	SE1509□□□□L□
---------------	--------------------------------	---------------------------------	--------------

VIII . RELIABILITY TEST :

Test item	Specification	Test condition						
Solderability	More than 90% of the terminal electrode shall be covered With fresh solder.	Preheat : $150 \pm 25^{\circ}\text{C}$ for 60 seconds Solder : Sn96.5 / Ag3 / Cu0.5 or equivalent Solder temp. : $260 \pm 5^{\circ}\text{C}$ Flux : Rosin Dip time : 4 ± 1 seconds						
Thermal shock test (Temp. cycle)	Inductance shall not change more than $\pm 20\%$	<table style="width: 100%; border: none;"> <tr> <td style="text-align: center;">Room temp. 15 minutes</td> <td style="text-align: center;">—————></td> <td style="text-align: center;">$-25 \pm 2^{\circ}\text{C}$ 30 minutes</td> </tr> <tr> <td style="text-align: center;">Room temp. 15 minutes</td> <td style="text-align: center;">—————></td> <td style="text-align: center;">$85 \pm 2^{\circ}\text{C}$ 30 minutes</td> </tr> </table> <p>Total : 50 cycles</p>	Room temp. 15 minutes	—————>	$-25 \pm 2^{\circ}\text{C}$ 30 minutes	Room temp. 15 minutes	—————>	$85 \pm 2^{\circ}\text{C}$ 30 minutes
Room temp. 15 minutes	—————>	$-25 \pm 2^{\circ}\text{C}$ 30 minutes						
Room temp. 15 minutes	—————>	$85 \pm 2^{\circ}\text{C}$ 30 minutes						
Humidity Resistance test		Temperature : $40 \pm 2^{\circ}\text{C}$ Humidity : 90 ~ 95% Applied current : Per spec. Time : 500 hours						
High temp. Resistance test		Temperature : $85 \pm 2^{\circ}\text{C}$ Applied current : Per spec. Time : 500 hours						

SPECIFICATION FOR APPROVAL

REF :

PAGE: 6

PROD. NAME	SHIELDED SMD POWER INDUCTOR	ABC'S DWG NO.	SE1509□□□□L□
		ABC'S ITEM NO.	

IX . UL CARD :

QMFZ2		January 15, 1991									
Component-Plastics											
SUMITOMO BAKELITE CO LTD		E41429 (M)									
		(11-cont. from I card)									
PM-9630	BK	0.40	94V-0	150	150	150	—	—	—	—	—
		0.51	94V-0	150	150	150	0	0	—	—	—
		3.18	94V-0	150	150	150	0	1	0	4	3
PM-8315	BK	0.50	94V-0	150	150	150	3	0	0	—	—
PM-8315J	BN	0.71	94V-0	150	150	150	2	0	0	—	—
		1.47	94V-0	150	150	150	0	2	0	—	—
		3.05	94V-0	150	150	150	0	1	0	5	4
		6.10	94V-0	150	150	150	0	1	0	5	4
PM-8315K	BK	0.78	94V-1	150	150	150	—	—	—	—	—
		1.52	94V-0	150	150	150	—	—	—	—	—
PM-8320J	BK	0.71	94HB	150	150	150	—	—	—	—	—
PM-8330	BK	0.71	94V-1	150	150	150	—	—	—	—	—
		1.57	94V-0	150	150	150	—	—	—	—	—
PM-8400	BK	0.71	94HB	150	150	150	—	—	—	—	—
PM-9830	BK	0.69	94V-0	150	150	150	0	0	—	—	—
		3.18	94V-0	150	150	150	0	0	0	4	3

Reports: March 29, 1985; May 14, 1974; September 16, 1971; September 16, 1971;
September 16, 1971; September 16, 1971; March 29, 1985.

Replaces E4142911 dated February 28, 1990. (Cont. on J card)
683540014 N7047 Underwriters Laboratories Inc. ® D11/0043416

OANZ2		August 7, 1989									
Component-Insulating Tape											
FOUR PILLARS ENTERPRISE CO LTD		E50292 (S)									
NO 18 HENGYANG RD , TAIPEI TAIWAN		(A card)									
<p>Flame retardant polyvinyl chloride tape, Cat. No. 33047+.</p> <p>Polyester film tape, Cat. No. 35660⁺ rated 130C.</p> <p>Flame retardant double sided acrylic tape, Cat. No. DS31+.</p> <p>Arme paper tape, Cat. No. NMI30⁺ rated 155C.</p> <p>Glass cloth backing with silicone adhesive, Cat. No. GL06⁺ rated 180C.</p> <p>Glass cloth backing with acrylic adhesive, Cat. No. GL15 rated 155C.</p> <p>Glass cloth backing with rubber adhesive, Cat. No. GL27 rated 130C.</p> <p>Polyesterfilm insulating tape with acrylic adhesive, Cat. No. MY130 rated 130C.</p> <p>Polyesterfilm insulating tape with silicone base adhesive, Cat. No. KA180⁺ rated 180C.</p> <p>Acetate cloth backing with acrylic base adhesive, Cat. No. AC0 rated 130C.</p>											
<p>Reports: March 25, 1985; March 26, 1985; March 27, 1985; March 7, 1986; July 2, 1987; July 2, 1987; July 2, 1987; March 9, 1989; March 10, 1989; August 15, 1989.</p>											
<p>Replaces E50292A dated Febuary 28, 1989.</p> <p>369021002 Underwriters Laboratories Inc.®</p>		<p>(Cont. on B card)</p> <p>D11/0114874</p> <p>51</p>									