

SPECIFICATION FOR APPROVAL

REF :

PAGE: 1

PROD. NAME	SMD LINE FILTER	ABC'S DWG NO.	SF0602□□□□L□
		ABC'S ITEM NO.	

CONFIGURATION & DIMENSIONS :

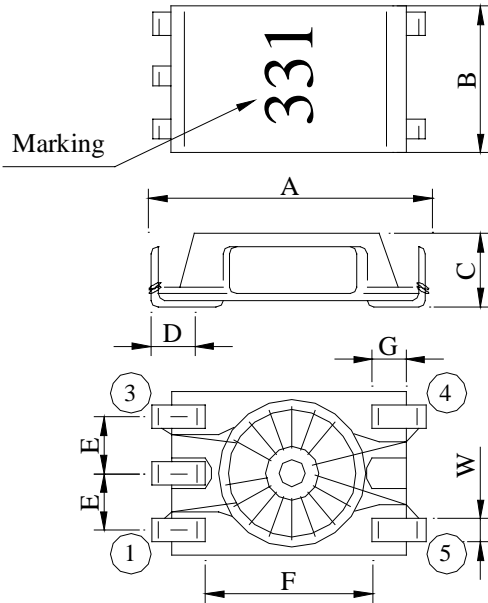

A :	6.50 max.	m / m
B :	3.60±0.15	m / m
C :	1.65±0.15	m / m
D :	0.90 min.	m / m
E :	1.25±0.1	m / m
F :	3.40±0.2	m / m
G :	0.8 max.	m / m
W :	0.55±0.1	m / m

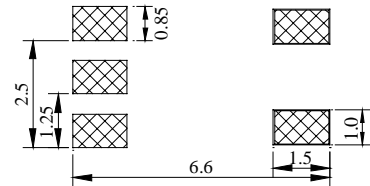

(PCB Pattern)

SCHEMATIC DIAGRAM :

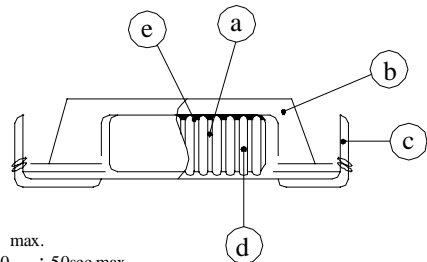
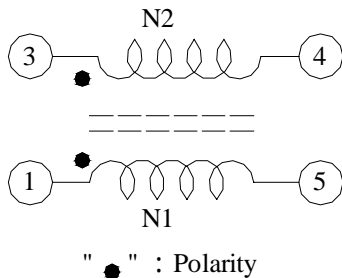

Peak Temp : 260 max.
 Max time above 230 : 50sec max.
 Max time above 200 : 70sec max.

MATERIALS :

- a . Core : Ferrite toroidal core
- b . Base : LCP
- c . Terminal : Cu/Ni/Sn
- d . Wire : Enamelled copper wire (class F)
- e . Adhesive : Epoxy resin

GENERAL SPECIFICATION :

- a . Temp. rise : 20 max. at rated current
- b . Storage temp. : -40 ----+85
- c . Operating temp. : -40 ----+85
- d . Resistance to solder heat : 260 .10 secs.

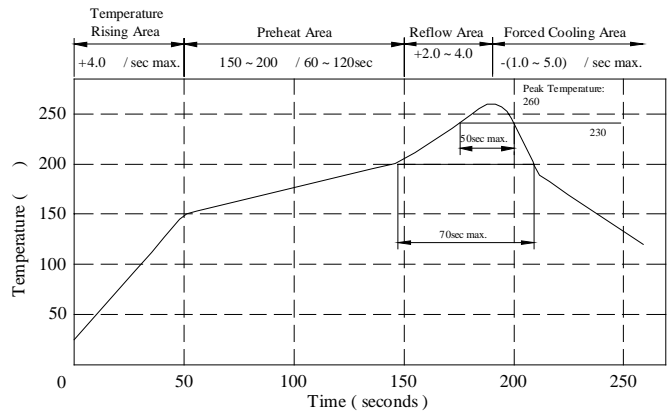

AE-001A

SPECIFICATION FOR APPROVAL

REF :

PAGE: 2

PROD. NAME	SMD LINE FILTER	ABC'S DWG NO. ABC'S ITEM NO.	SF0602□□□□L□
---------------	-----------------	---------------------------------	--------------

. ELECTRICAL CHARACTERISTICS :

DWG No.	L (uH)	L-L (uH) max.	RDC (Ω) max. N1=N2	Rated current (mA)	HI-POT Test	Impedance (Z)	
						Freq. range MHz	min (Ω)
SF0602100YL□	10±50%	1.0	0.24	300	250 Vac 60 Hz 3 mA 1 minute	35 ~ 570	600
SF0602470YL□	47±50%	4.0	0.16	300		4 ~ 1600	140
SF0602820YL□	82±50%	4.0	0.20	300		3 ~ 850	220
SF0602101YL□	100±50%	8.0	0.22	300		3 ~ 660	260
SF0602181YL□	180±50%	8.0	0.25	300		3 ~ 250	500
SF0602221YL□	220±50%	10.0	0.28	300		3 ~ 210	600
SF0602331YL□	330±50%	10.0	0.30	300		3 ~ 120	900

- 1). Test equipment : Inductance (HP-4274A , 2mV/10KHz)
RDC (CH-502AC)
Impedance (HP-4291A)
- 2). Nominal voltage : 60Vdc
- 3). Rated current : Base on series both winding.

. IMPEDANCE VS . FREQUENCY :

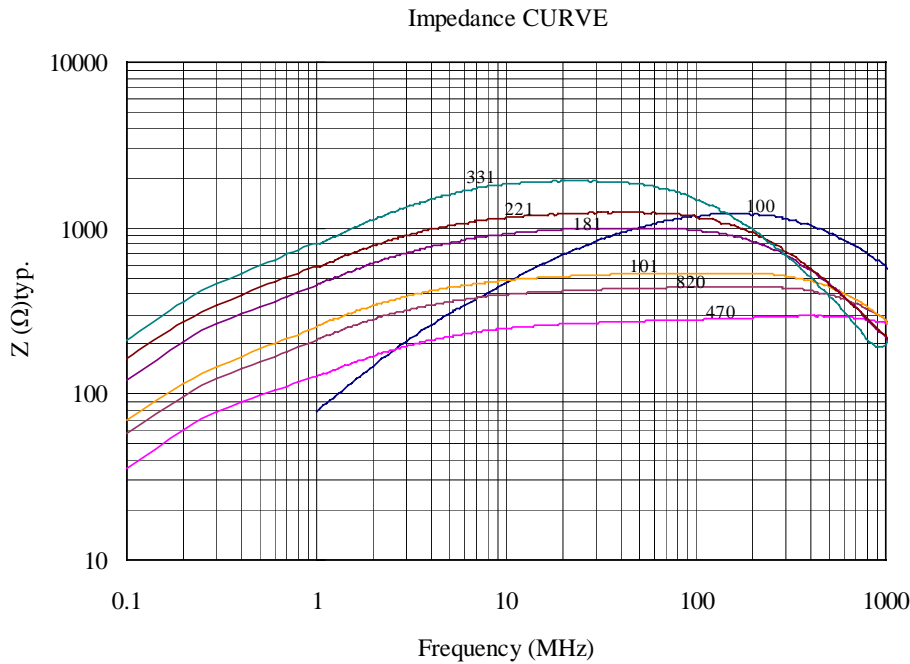

Measuring Circuit :

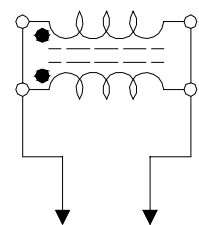

RF Impedance Analyzer

SPECIFICATION FOR APPROVAL

REF :

PAGE: 3

PROD. NAME	SMD LINE FILTER	ABC'S DWG NO.	SF0602□□□□L□
		ABC'S ITEM NO.	

PACKAGING INFORMATION

(1) Configuration

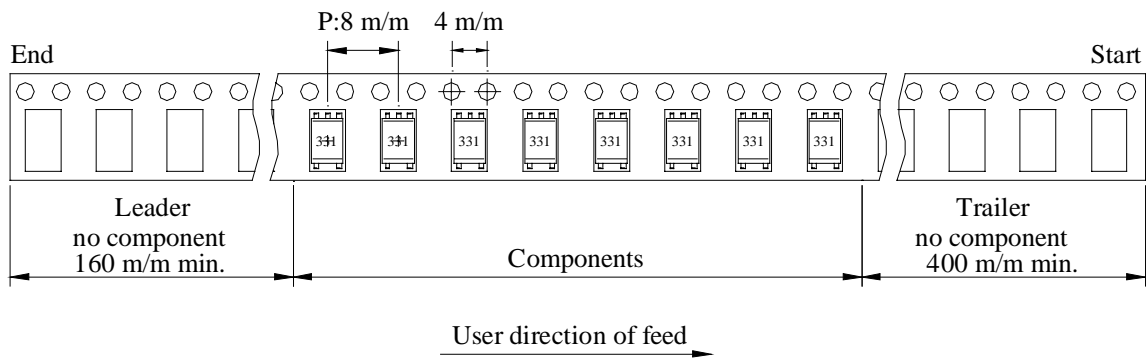
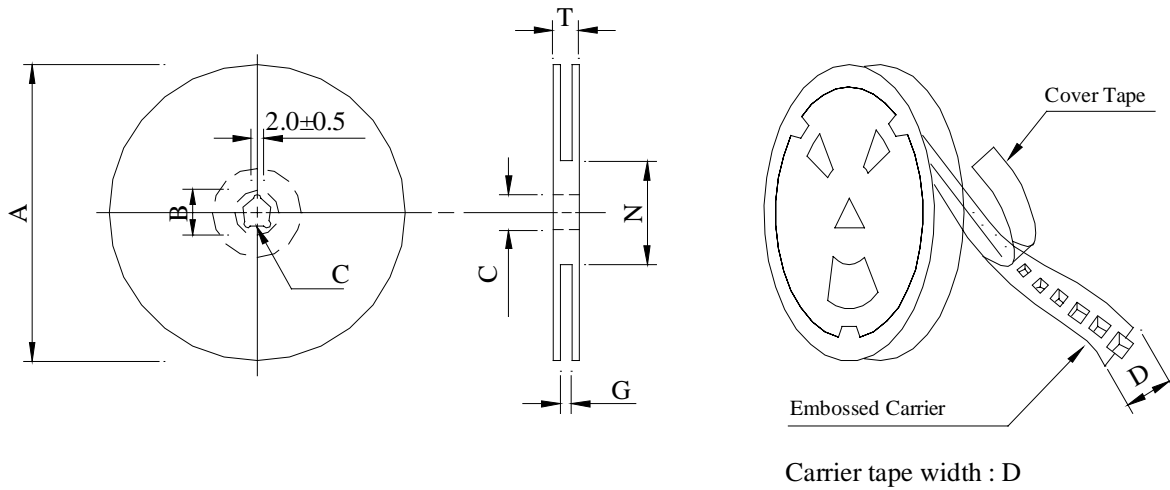

(2) Dimensions

Unit:m/m

Style	A	B	C	D	G	N	T
07 - 12	178	21±0.8	13	12	14 ⁺⁰	50 ⁻⁰	18.4

(3) Q'TY & G.W. Per package

Series	Inner : Reel			Outer : Carton		
	Q'TY (pcs)	G.W. (gw)	Style	Q'TY (pcs)	G.W. (Kg)	Size (cm)
SF0602	1,000	200	07 - 12	40,000	7.5	42x 41 x 24

AE-001A

SPECIFICATION FOR APPROVAL

REF :

PAGE: 4

PROD. NAME	SMD LINE FILTER	ABC'S DWG NO.	SF0602□□□□L□
		ABC'S ITEM NO.	

. DWG EXPRESSION :

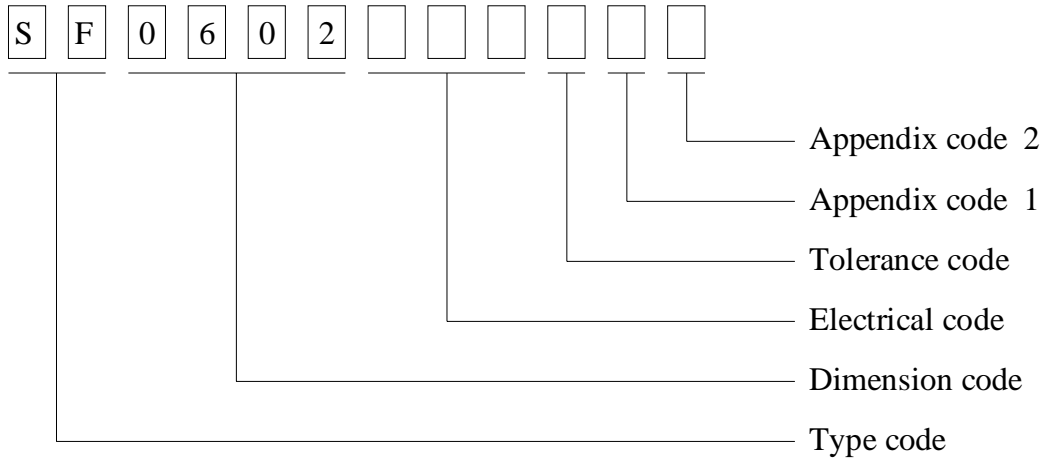

Appendix code 1 : S : Standard products

A K , M R , T Z : Special products

L : Standard Lead Free products

1 ~ 9 : Special Lead Free products

Appendix code 2 :

Code	Inner package	Inner package Q'TY	Remark
A	Empty	Empty	
B	T / R (Reel package)	1000 pcs	

SPECIFICATION FOR APPROVAL

REF :

PAGE: 5

PROD. NAME	SMD LINE FILTER	ABC'S DWG NO.	SF0602□□□□L□
		ABC'S ITEM NO.	

RELIABILITY TEST :

Test item	Specification	Test condition						
Solderability	More than 90% of the terminal electrode shall be covered With fresh solder.	Preheat : 150±25 for 60 seconds Solder : Sn96.5 / Ag3 / Cu0.5 or equivalent Solder temp. : 260±5 Flux : Rosin Dip time : 4±1 seconds						
Thermal shock test (Temp. cycle)	Inductance shall not change more than ±20%	<table style="width: 100%; border: none;"> <tr> <td style="text-align: center;">Room temp. 15 minutes</td> <td style="text-align: center;">→</td> <td style="text-align: center;">-25±2 30 minutes</td> </tr> <tr> <td style="text-align: center;">Room temp. 15 minutes</td> <td style="text-align: center;">→</td> <td style="text-align: center;">85±2 30 minutes</td> </tr> </table> <p>Total : 50 cycles</p>	Room temp. 15 minutes	→	-25±2 30 minutes	Room temp. 15 minutes	→	85±2 30 minutes
Room temp. 15 minutes	→	-25±2 30 minutes						
Room temp. 15 minutes	→	85±2 30 minutes						
Humidity Resistance test		Temperature : 40±2 Humidity : 90 ~ 95% Applied current : Per spec. Time : 500 hours						
High temp. Resistance test		Temperature : 80±2 Applied current : Per spec. Time : 500 hours						

AE-001A



SPECIFICATION FOR APPROVAL

REF :

PAGE: 6

PROD. NAME	SMD LINE FILTER	ABC'S DWG NO.	SF0602□□□□L□
		ABC'S ITEM NO.	

UL CARD :

OBMW2		June 11, 1990	
Component-Magnet Wire			
TOTOKU ELECTRIC CO LTD		E79029 (S)	
(B-cont, from A card)			
MZW	Polyurethane	Polyvinyl Butyral	— 130
LOCKW	Polyurethane	Polyvinyl	— 130
PESVW	Polyester	Polyvinyl	— 155
EILOCKW	Polyurethane	Modified Epoxy	— 200
SF-BW	Modified Polyester	—	MW26-C 155
SF.H EIW	Modified Polyesterimide	—	— 180
THW	Polyesterimide	Polyamideimide	MW35C 220
LOCK Y	Polyurethane	Polyvinyl	— 130
Report: May 9, 1983.			
71507702 H3108		Underwriters Laboratories Inc. ®	
		(Cont. on C card) D11 / 0096640	

AE-001A

