

SPECIFICATION FOR APPROVAL

REF : 20070504-B

PAGE: 1

PROD. NAME	SHIELDED SMD POWER INDUCTOR	ABC'S DWG NO. ABC'S ITEM NO.	SH4009□□□□L□-□□□
---------------	--------------------------------	---------------------------------	------------------

. CONFIGURATION & DIMENSIONS :

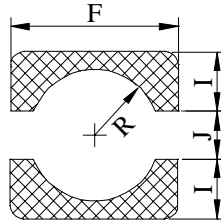
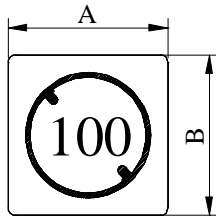

A	: 4.20 ±0.30	m/m
B	: 4.20 ±0.30	m/m
C	: 0.90 ±0.15	m/m
D	: 1.40 typ.	m/m
E	: 1.20 typ.	m/m
F	: 4.50 ref.	m/m
G	: 0.90 ref.	m/m
H	: 2.90 ref.	m/m
I	: 1.65 ref.	m/m
J	: 1.20 ref.	m/m
R	: 1.50 ref.	m/m



OR

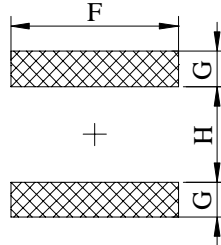
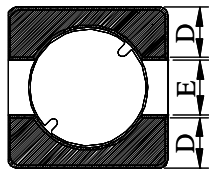

(PCB Pattern Suggestion)

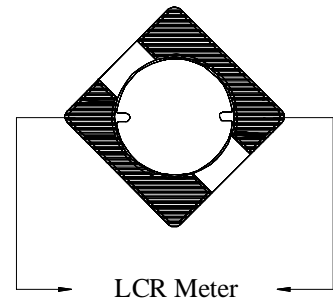

. SCHEMATIC DIAGRAM :



. MATERIALS :

- a . Core : Ferrite DR core
- b . Core : Ferrite RI core
- c . Wire : Enamelled copper wire (Class H)
- d . Adhesive : Epoxy resin
- e . Terminal : Ag / Ni / Sn
- f . Remark : Products comply with RoHS' requirements

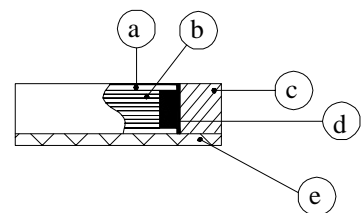

Peak Temp : 260 max.
 Max time above 230 : 50sec max.
 Max time above 200 : 70sec max.

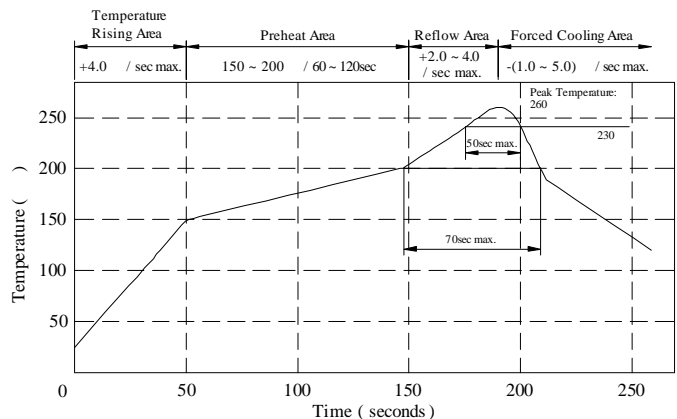

. GENERAL SPECIFICATION :

- a . Temp. rise : 40 typ.
- b . Storage temp. : -40 ----+125
- c . Operating temp. : -40 ----+105
- d . Resistance to solder heat : 260 .10 secs.

AR-001A

SPECIFICATION FOR APPROVAL

REF : 20070504-B

PAGE: 2

PROD. NAME	SHIELDED SMD POWER INDUCTOR	ABC'S DWG NO.	SH4009□□□□L□-□□□
		ABC'S ITEM NO.	

ELECTRICAL CHARACTERISTICS :

DWG No.	Inductance (μH)	Q ref.	Test Freq. (MHz)	SRF (MHz) typ.	RDC (mΩ)		I _{rms} (mA) typ.	I _{sat} (mA) typ.
					typ.	max.		
SH40091R1YL□-□□□	1.10 ± 30 %	10	7.96	150	55	76	2100	2000
SH40091R5YL□-□□□	1.50 ± 30 %	10	7.96	120	72	98	1700	1650
SH40092R5YL□-□□□	2.50 ± 30 %	8	7.96	100	125	170	1350	1300
SH40093R3YL□-□□□	3.30 ± 30 %	8	7.96	85	173	234	1200	1150
SH40094R7YL□-□□□	4.70 ± 30 %	10	7.96	65	219	300	920	900
SH40096R8YL□-□□□	6.80 ± 30 %	8	7.96	55	367	495	750	750
SH40098R0YL□-□□□	8.00 ± 30 %	8	7.96	50	424	572	680	680
SH4009100YL□-□□□	10.00 ± 30 %	16	2.52	42	545	700	600	650
SH4009150YL□-□□□	15.00 ± 30 %	16	2.52	34	857	1150	450	480
SH4009220YL□-□□□	22.00 ± 30 %	12	2.52	26	1130	1470	400	420
SH4009330YL□-□□□	33.00 ± 30 %	14	2.52	20	1640	2130	320	340

- 1). □: Packaging Information... **A**: Bulk **B**: Taping Reel
- 2). "-□□□": Reference code
- 3). Inductance Test Freq. : 100KHz /0.1V
- 4). I_{rms} base on Temp. rise 40 typ.
- 5). I_{sat} base on L / LOA=35% typ.

@ Inductance VS. DC Current Curve

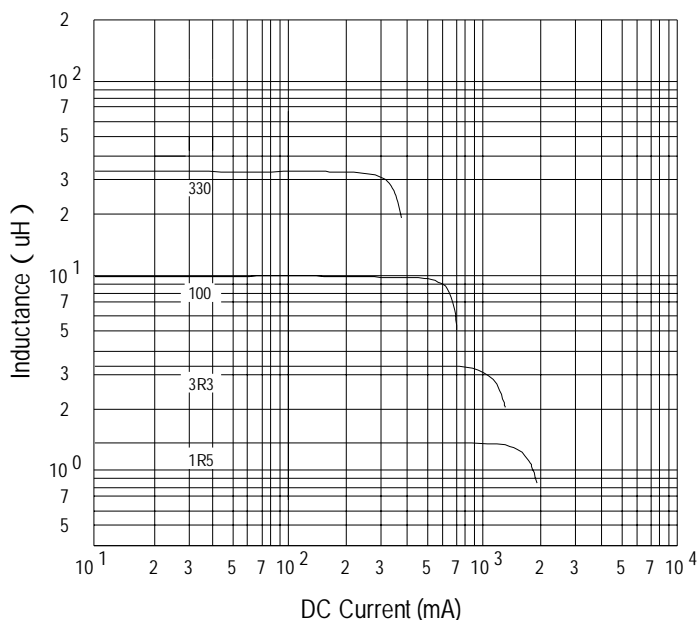

AR-001A



SPECIFICATION FOR APPROVAL

REF : 20070504-B

PAGE: 3

PROD. NAME	SHIELDED SMD POWER INDUCTOR	ABC'S DWG NO.	SH4009□□□□L□-□□□
		ABC'S ITEM NO.	

PACKAGING INFORMATION :

(1) Configuration

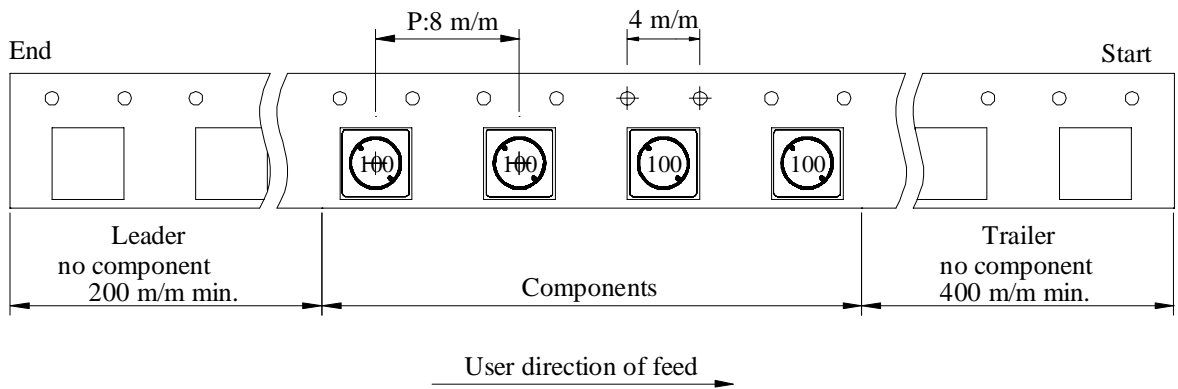
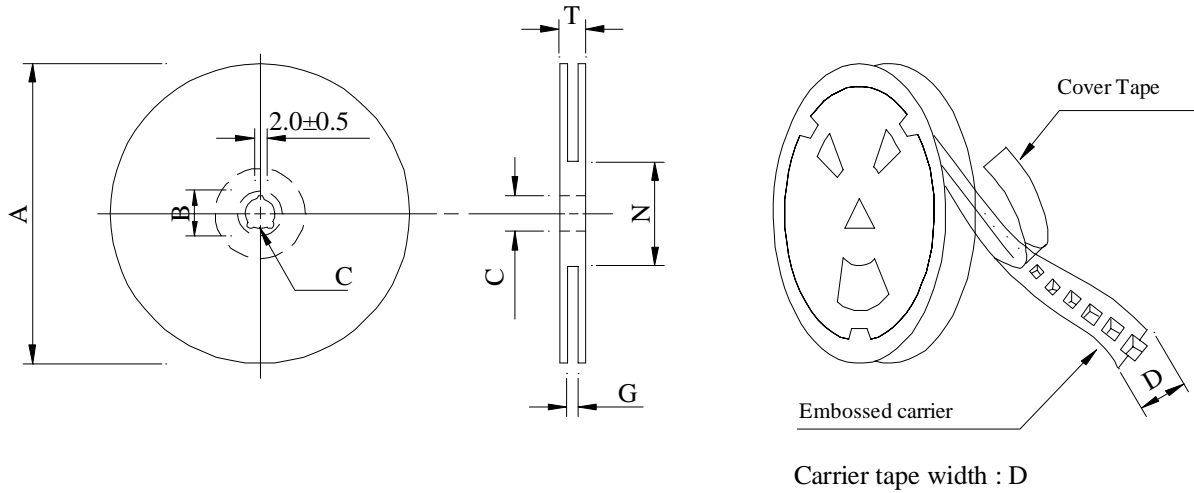

(2) Dimensions

Unit:m/m

Style	A	B	C	D	G	N	T
07 - 12	178	21±0.8	13	12	14 ⁺⁰	50 ⁻⁰	16.5

(3) Q'TY & G.W. Per package

Series	Inner : Reel			Outer : Carton		
	Q'TY (pcs)	G.W. (gw)	Style	Q'TY (pcs)	G.W. (Kg)	Size (cm)
SH4009	1,500	168	07 - 12	60,000	7.7	42 x 41 x 24

SPECIFICATION FOR APPROVAL

REF: 20070504-B

PAGE: 4

PROD. NAME	SHIELDED SMD POWER INDUCTOR	ABC'S DWG NO.	SH4009□□□□L□-□□□
		ABC'S ITEM NO.	

. DWGING NUMBER EXPRESSION :

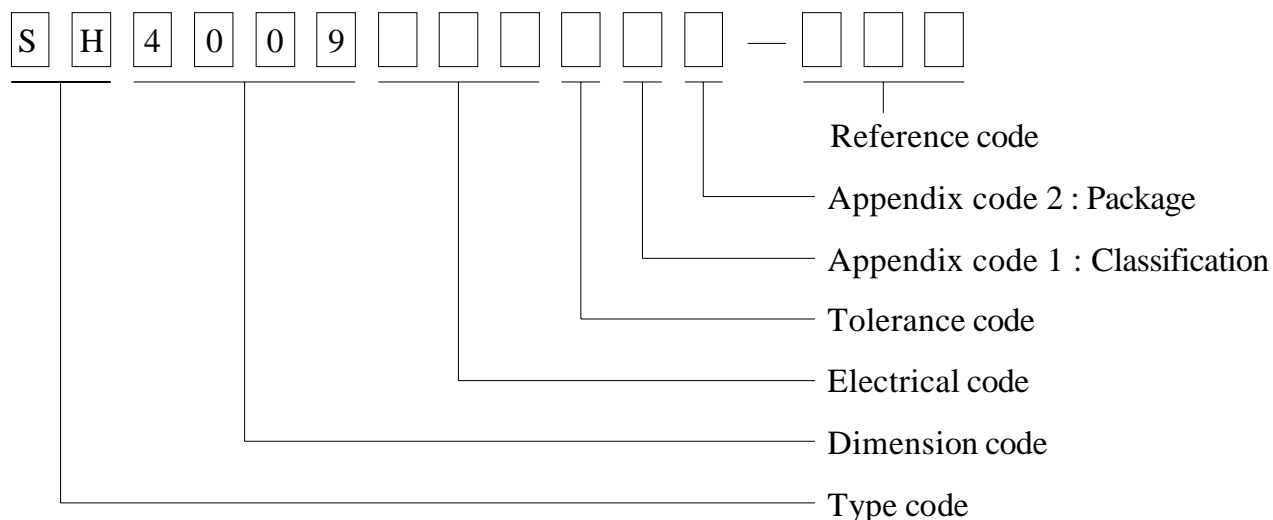

Appendix code 1 : Product Classification

L : Lead Free Standard products comply with RoHS' requirements

1 ~ 9 : Lead Free Special products comply with RoHS' requirements

Appendix code 2 : Package Information

Code	Inner package	Inner package Q'TY	Remark
A	T.B.D.	T.B.D.	
B	T / R (Reel package)	1,500 pcs	

SPECIFICATION FOR APPROVAL

REF : 20070504-B

PAGE: 5

PROD. NAME	SHIELDED SMD POWER INDUCTOR	ABC'S DWG NO.	SH4009□□□□L□-□□□
		ABC'S ITEM NO.	

RELIABILITY TEST :

Test item	Specification	Test condition						
Solderability	More than 90% of the terminal electrode shall be covered With fresh solder.	Preheat : 150±25 for 60 seconds Solder : Sn96.5 / Ag3 / Cu0.5 or equivalent Solder temp. : 235±5 Flux : Rosin Dip time : 4±1 seconds						
Thermal shock test (Temp. cycle)	Inductance shall not change more than ±20%	<table style="width: 100%; border: none;"> <tr> <td style="text-align: center;">Room temp. 15 minutes</td> <td style="text-align: center;">→</td> <td style="text-align: center;">-25±2 30 minutes</td> </tr> <tr> <td style="text-align: center;">Room temp. 15 minutes</td> <td style="text-align: center;">→</td> <td style="text-align: center;">85±2 30 minutes</td> </tr> </table> <p>Total : 50 cycles</p>	Room temp. 15 minutes	→	-25±2 30 minutes	Room temp. 15 minutes	→	85±2 30 minutes
Room temp. 15 minutes	→	-25±2 30 minutes						
Room temp. 15 minutes	→	85±2 30 minutes						
Humidity Resistance test		Temperature : 40±2 Humidity : 90 ~ 95% Applied current : Per spec. Time : 500 hours						
High temp. Resistance test		Temperature : 105±2 Applied current : Per spec. Time : 500 hours						

SPECIFICATION FOR APPROVAL

REF : 20070504-B

PAGE: 6

PROD. NAME	SHIELDED SMD POWER INDUCTOR	ABC'S DWG NO. ABC'S ITEM NO.	SH4009□□□□L□-□□□
---------------	------------------------------------	-------------------------------------	------------------

UL CARD :

OBMW2 August 27, 1999

Magnet Wire-Component

ELEKTRISOLA (MALAYSLA) SDN BHD E143312
 IALAN DAMN SATU IANDA BAIK 28750 BENTONG, PAHANG
 DARUL MAKMUR MALAYSIA

Mtl Dsg	Mark Dsg	Coating Type		ANSI Typ	Temp Class
		BC	OC		
Estersol 160	E180	Polyesterimide (solderable)	—	MW-77	180
Amldester 200	A200	Polyesterimide	—	MW-74	200
Polysol-N 155	PN155	Polyurechane	Nylon	MW-80,	155,
				MW-28	100
Polysol 155	P155	Polyurechane	—	MW-79,	155,
				MW-79	130
Polysol 155g	Pg155	Polyurechane	—	MW-79	130
Polysol 155p	Pp155,Gp155	Polyurechane	—	MW-79	155
Polysol 160	P160	Polyurechane	—	MW-79	155
Polysol 180	P180	Polyurechane	—	MW-79	155
Polysol 170	P170 or G170	Polyurechane	—	MW-79	156
Polysol-N 180	PN180	Polyurechane	Nylon	—	180

Marking : Dompny name/nateriel designation or marked designation and factory identification on package ok reel

See General Information preceding These Recognitions

For use only in equipment where the acceptability of the combination is determined by Underwriters Laboratories Inc.

AR-001A

