

SPECIFICATION FOR APPROVAL

REF :

PAGE: 1

PROD. NAME	SHIELDED SMD POWER INDUCTOR	ABC'S DWG NO. ABC'S ITEM NO.	SV6028□□□□L□-□□□
---------------	--------------------------------	---------------------------------	------------------

I . CONFIGURATION & DIMENSIONS :

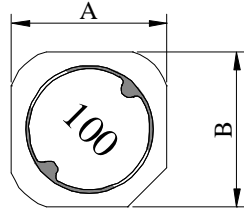

- A : 6.50±0.20 G : 1.60 ref.
- B : 6.50±0.20 H : 4.90 ref.
- C : 2.80±0.25 I : 3.20 ref.
- D : 2.85 typ. J : 2.00 ref.
- E : 1.80 typ. R : 2.65 ref.
- F1: 4.00 ref.
- F2: 7.60 ref.

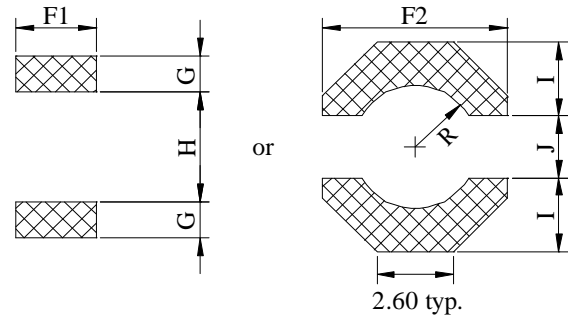
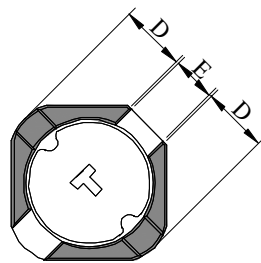
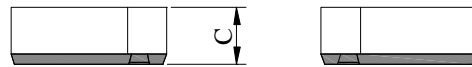

(PCB Pattern Suggestion)

II . SCHEMATIC DIAGRAM :

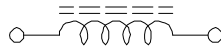

III . MATERIALS :

- a . Core : Ferrite DR core
- b . Core : Ferrite RI core
- c . Wire : Enamelled copper wire (Class H)
- d . Adhesive : Epoxy resin
- e . Terminal : Ag/Ni/Sn
- f . Remark : Products comply with RoHS' requirements

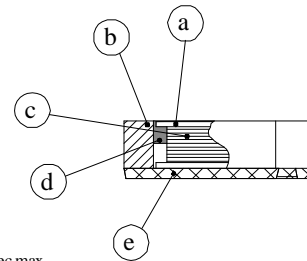

Peak Temp : 260°C max.
 Max time above 230°C : 50sec max.
 Max time above 200°C : 70sec max.

IV . GENERAL SPECIFICATION :

- a . Temp. rise : 40°C max.
- b . Storage temp. : -40°C ----+125°C
- c . Operating temp. : -40°C ----+105°C
- d . Resistance to solder heat : 260°C .10 secs.

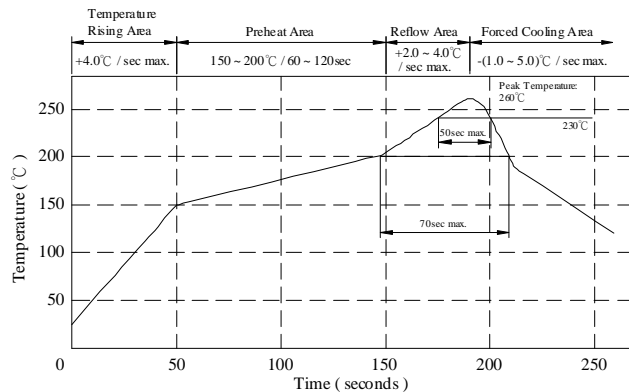

AR-001A

SPECIFICATION FOR APPROVAL

REF :

PAGE: 2

PROD. NAME	SHIELDED SMD POWER INDUCTOR	ABC'S DWG NO.	SV6028□□□□L□-□□□
		ABC'S ITEM NO.	

V . ELECTRICAL CHARACTERISTICS :

DWG No.	Inductance (μH)	Q ref.	Test Freq. (MHz)	SRF (MHz) typ.	RDC (mΩ)		Irms (mA) max.	Isat.(mA) (25°C) max.	Isat.(mA) (105°C) max.	Isat.(mA) (125°C) max.
					typ.	max.				
SV60283R6YL□-□□□	3.60 ± 30 %	12	7.96	60	33.5	44.0	2500	4100	2900	2600
SV60284R3YL□-□□□	4.30 ± 30 %	10	7.96	55	36.5	47.5	2400	3700	2600	2300
SV60285R0YL□-□□□	5.00 ± 30 %	10	7.96	50	45.0	60.0	2200	3300	2400	2100
SV60286R2YL□-□□□	6.20 ± 30 %	10	7.96	43	50.0	65.0	2100	3200	2200	1900
SV60287R2YL□-□□□	7.20 ± 30 %	10	7.96	38	55.0	70.0	2000	3000	2100	1800
SV60288R4YL□-□□□	8.40 ± 30 %	10	7.96	33	65.0	85.0	1900	2800	2000	1700
SV6028100YL□-□□□	10.00 ± 30 %	13	2.52	30	70.0	90.0	1800	2650	1900	1600
SV6028120YL□-□□□	12.00 ± 30 %	13	2.52	27	81.5	110.0	1500	2300	1700	1500
SV6028150YL□-□□□	15.00 ± 30 %	14	2.52	22	95.0	130.0	1400	2200	1500	1400
SV6028180YL□-□□□	18.00 ± 30 %	13	2.52	17	120.0	160.0	1300	1900	1400	1200
SV6028220YL□-□□□	22.00 ± 30 %	13	2.52	15	140.0	190.0	1100	1700	1200	1050
SV6028270YL□-□□□	27.00 ± 30 %	13	2.52	12	190.0	255.0	1020	1500	1100	950
SV6028330YL□-□□□	33.00 ± 30 %	13	2.52	11	220.0	290.0	940	1250	1000	850
SV6028390YL□-□□□	39.00 ± 30 %	12	2.52	10	265.0	340.0	900	1200	900	750
SV6028470YL□-□□□	47.00 ± 30 %	11	2.52	9	320.0	420.0	750	1100	850	650
SV6028560YL□-□□□	56.00 ± 30 %	10	2.52	8	380.0	500.0	680	1000	750	600
SV6028680YL□-□□□	68.00 ± 30 %	11	2.52	7	435.0	580.0	650	920	680	550
SV6028820YL□-□□□	82.00 ± 30 %	11	2.52	6	525.0	690.0	600	820	620	500
SV6028101YL□-□□□	100.00 ± 30 %	13	0.796	5	600.0	780.0	550	750	560	450

1). □: Packaging Information... [A]: Bulk [B]: Taping Reel

2). "-□□□":Reference code

3). Inductance Test Freq. : 100KHz /0.1V

4). Irms base on Temp. rise 40°C max.

5). Isat base on ΔL / L0A=35% max.

@ Inductance VS. DC Current Curve at 25°C

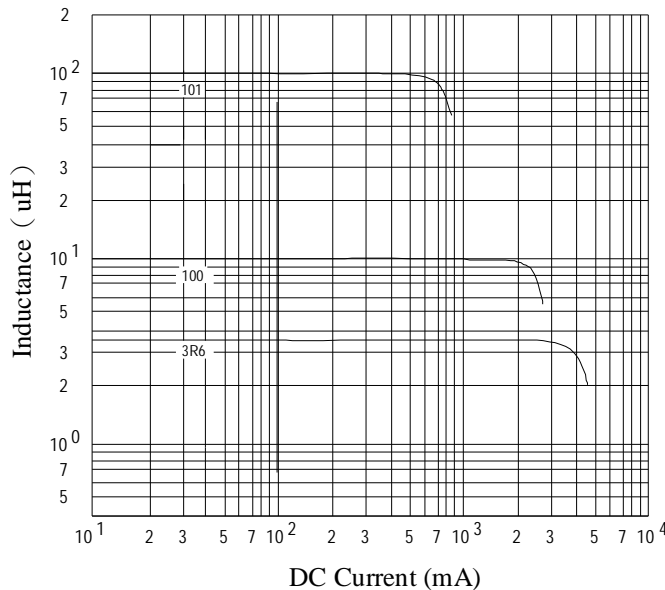

AR-001A



SPECIFICATION FOR APPROVAL

REF :

PAGE: 3

PROD. NAME	SHIELDED SMD POWER INDUCTOR	ABC'S DWG NO. ABC'S ITEM NO.	SV6028□□□□L□-□□□
---------------	--------------------------------	---------------------------------	------------------

@ Inductance VS. DC Current Curve at 105°C

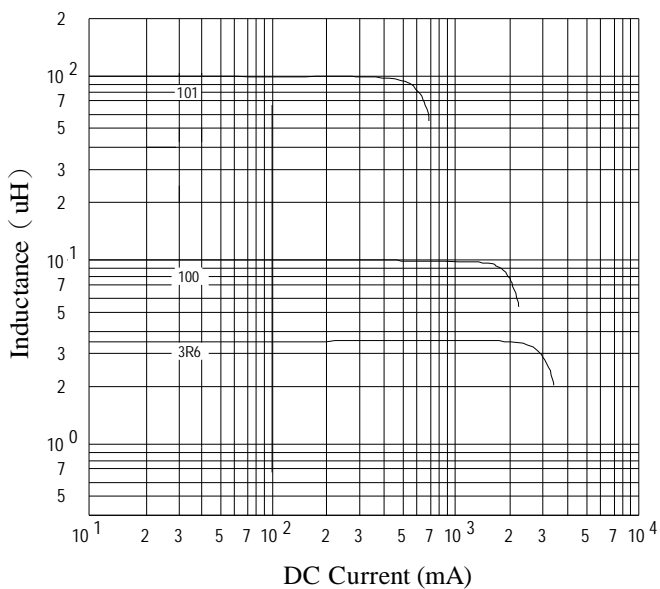

@ Inductance VS. DC Current Curve at 125°C

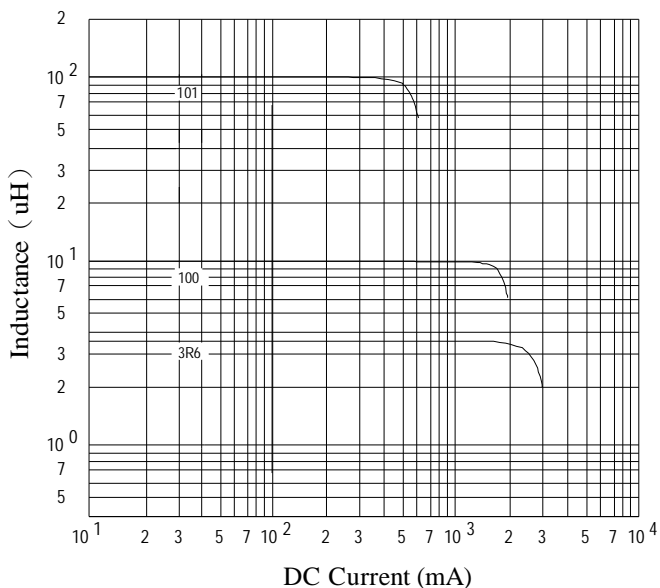

AR-001A

SPECIFICATION FOR APPROVAL

REF :

PAGE: 4

PROD. NAME	SHIELDED SMD POWER INDUCTOR	ABC'S DWG NO.	SV6028□□□□L□-□□□
		ABC'S ITEM NO.	

VI . PACKAGING INFORMATION :

(1) Configuration

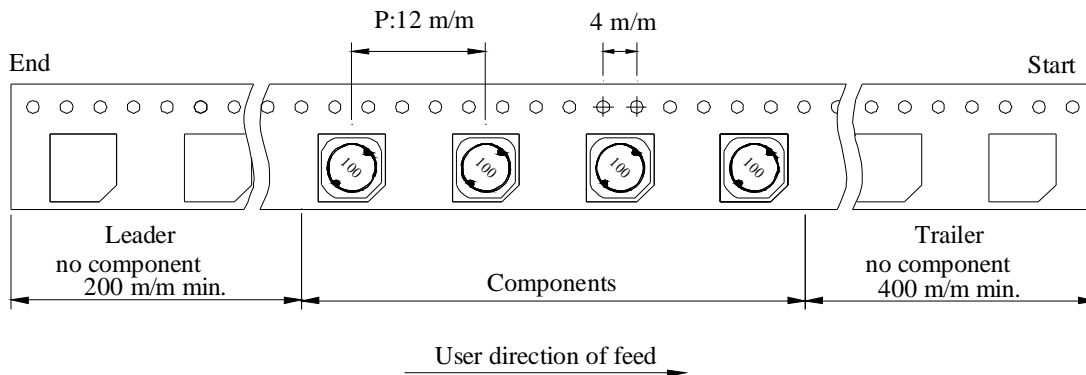
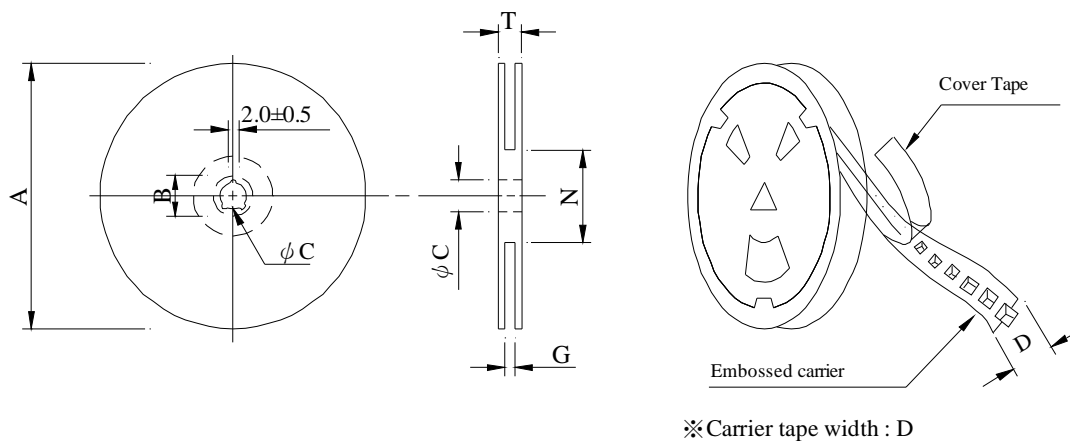

(2) Dimensions

Unit:m/m

Style	A	B	C	D	G	N	T
13 - 16	330	21±0.8	13±0.5	16	18 ⁺⁰	50 ⁻⁰	22.4

(3) Q'TY & G.W. Per package

Series	Inner : Reel			Outer : Carton		
	Q'TY (pcs)	G.W. (gw)	Style	Q'TY (pcs)	G.W. (Kg)	Size (cm)
SV6028	1,600	1,400	13 - 16	9,600	12.0	38 x 37 x 22

AR-001A

SPECIFICATION FOR APPROVAL

REF :

PAGE: 5

PROD. NAME	SHIELDED SMD POWER INDUCTOR	ABC'S DWG NO.	SV6028□□□□L□-□□□
		ABC'S ITEM NO.	

VII . DWG EXPRESSION :

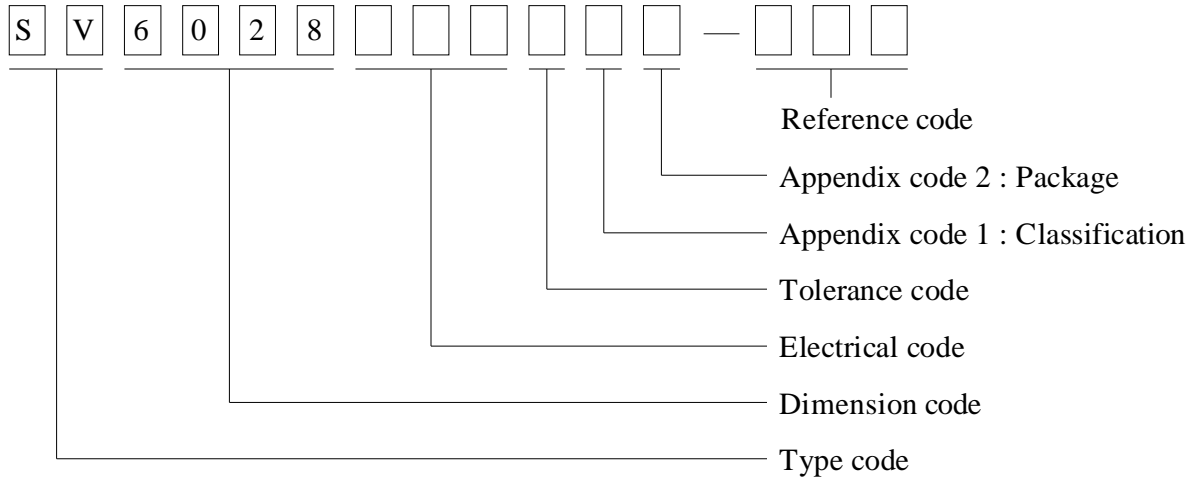

Appendix code 1 : Product Classification

- L : Lead Free Standard products comply with RoHS' requirements
- 1 ~ 9,K : Lead Free Special products comply with RoHS' requirements

Appendix code 2 :

Code	Inner package	Inner package Q'TY	Remark
A	T.B.D	T.B.D	
B	T / R (Reel package)	1,600 pcs	

SPECIFICATION FOR APPROVAL

REF :

PAGE: 6

PROD. NAME	SHIELDED SMD POWER INDUCTOR	ABC'S DWG NO.	SV6028□□□□L□-□□□
		ABC'S ITEM NO.	

VIII . RELIABILITY TEST :

Test item	Specification	Test condition						
Solderability	More than 95% of the terminal electrode shall be covered With fresh solder.	Preheat : 155°C / 4 hours. Solder : Sn96.5 / Ag3 / Cu0.5 or equivalent Solder temp. : 235±5°C Flux : Rosin Dip time : 5±0.5 seconds						
Thermal shock test (Temp. cycle)	Electrical oharacteristics shall not change more than ±20%	<table style="width: 100%; border: none;"> <tr> <td style="text-align: center;">Room temp. 15 minutes</td> <td style="text-align: center;">→</td> <td style="text-align: center;">-40 °C 30 minutes</td> </tr> <tr> <td style="text-align: center;">Room temp. 15 minutes</td> <td style="text-align: center;">→</td> <td style="text-align: center;">+105 °C 30 minutes</td> </tr> </table> <p>Total : 50 cycles</p>	Room temp. 15 minutes	→	-40 °C 30 minutes	Room temp. 15 minutes	→	+105 °C 30 minutes
Room temp. 15 minutes		→	-40 °C 30 minutes					
Room temp. 15 minutes		→	+105 °C 30 minutes					
Humidity test		Temperature : 40±2°C Humidity : 90±5% Time : 1000 hours						
High temp. Resistance test	Temperature : 105±5°C Applied current : Per spec. Time : 96 hours							

AR-001A



SPECIFICATION FOR APPROVAL

REF :

PAGE: 7

PROD. NAME	SHIELDED SMD POWER INDUCTOR	ABC'S DWG NO. ABC'S ITEM NO.	SV6028□□□□L□-□□□
---------------	--------------------------------	---------------------------------	------------------

IX . UL CARD :

OBMW2 August 27, 1999
Magnet Wire-Component

ELEKTRISOLA (MALAYSLA) SDN BHD E143312
IALAN DAMN SATU IANDA BAIK 28750 BENTONG, PAHANG
DARUL MAKMUR MALAYSIA

Mtl Dsg	Mark Dsg	Coating Type		ANSI Typ	Temp Class
		BC	OC		
Estersol 160	E180	Polyesterimide (solderable)	---	MW-77	180
Amldester 200	A200	Polyesterimide	---	MW-74	200
Polysol-N 155	PN155	Polyurethane	Nylon	MW-80, MW-28	155, 100
Polysol 155	P155	Polyurethane	---	MW-79, MW-79	155, 130
Polysol 155g	Pg155	Polyurethane	---	MW-79	130
Polysol 155p	Pp155.Gp155	Polyurethane	---	MW-79	155
Polysol 160	P160	Polyurethane	---	MW-79	155
Polysol 180	P180	Polyurethane	---	MW-79	155
Polysol 170	P170 or G170	Polyurethane	---	MW-79	156
Polysol-N 180	PN180	Polyurethane	Nylon	---	180

Marking : Dompnay name/nateriel designation or marked designation and factory identification on package ok reel

See General Information preceding These Recognitions
For use only in equipment where the acceptability of the combination is determined by Underwriters Laboratories Inc.