

# G2

## Fingerprint Time Attendance & Access Control Terminal



G2 fingerprint identification terminal features ZKTeco's innovative Silk ID fingerprint sensor. With 3D Neuron Fingerprint Verification Sensor-Activation and Anti-Interference technology, it precisely detects dry, wet, and rough fingerprints, and operates well under strong sunlight environment. With the latest core-board, the fingerprint capacity is enlarged to 20,000.

# Features



Modern Design & Interactive UI



Revolutionary SilkID Fingerprint Sensor



Multiple Verification Modes: Fingerprint / Card / Password



Outstanding Performance With Dry, Wet and Rough Fingers



Optional Wi-Fi or 3G

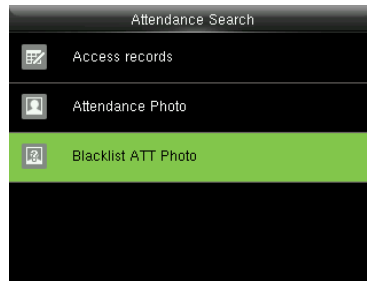
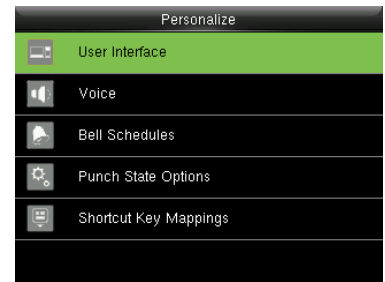

# Specifications G: GL Exclusive Feature

## Capacity

|              |                   |
|--------------|-------------------|
| Fingerprints | 20,000 (Standard) |
|              | 40,000 (Optional) |
| Cards        | 20,000            |
| Transactions | 200,000           |

## Communication

TCP/IP  
USB Host  
Wiegand Input / Output

## Access Control Interface

Lock Relay Output  
Alarm Output  
Exit Button  
Door Sensor  
External Bell Output

## Hardware

- G 1.2GHz High Speed CPU
- G Memory 128MB RAM / 256MB Flash
- SilkID Fingerprint Sensor
- 3.5 Inches TFT-LCD Screen
- Hi-Fi Voice & Indicator
- Tamper Switch Alarm

## Standard Functions

ID Card / Work Code / WDMS  
DST / SMS / Bell Schedule  
Attendance Status Auto-Switch  
Record Query / Photo ID  
Anti-Passback  
Custom Wallpaper & Screen Saver

## Optional Functions:

- HID Proxy / Mifare Card Reader
- External Printer
- G Wi-Fi / 3G

## Special Functions

- G Multiple Verification Modes
- G Alive Finger Detection

## Compatibility

ZKTime.Web  
ZKTime.Net 3.0  
ZKAccess 3.5  
WDMS

## Additional Info

Working Temperature: 0 °C ~ 45 °C  
Dimensions: 206.0 × 153.0 × 42.9 mm  
Fingerprint Algorithm ZKFinger v10.0  
FAR≤0.0001% FRR≤0.01%

## Power

Operating Voltage 12V DC  
Current Draw < 500 mA

# Configuration

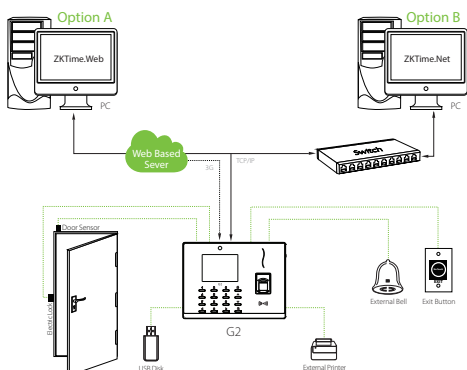

# Dimensions (mm)

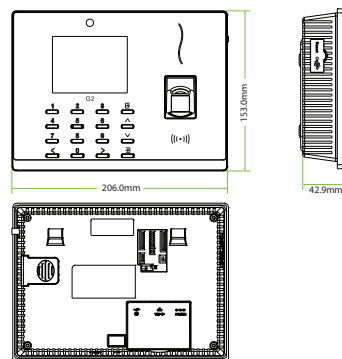

ZKTeco Inc.  
www.zkteco.com  
E-mail: sales@zkteco.com



© Copyright 2016, ZKTeco Inc. ZKTeco Logo is a registered trademark of ZKTeco or a related company. All other product and company names mentioned are used for identification purposes only and may be the trademarks of their respective owners. All specifications are subject to change without notice. All rights reserved.