

REV.	DESCRIPTION	DRAWN	CHECKED	APPROVED
A	NEW RELEASE	LL 05/05/06'		

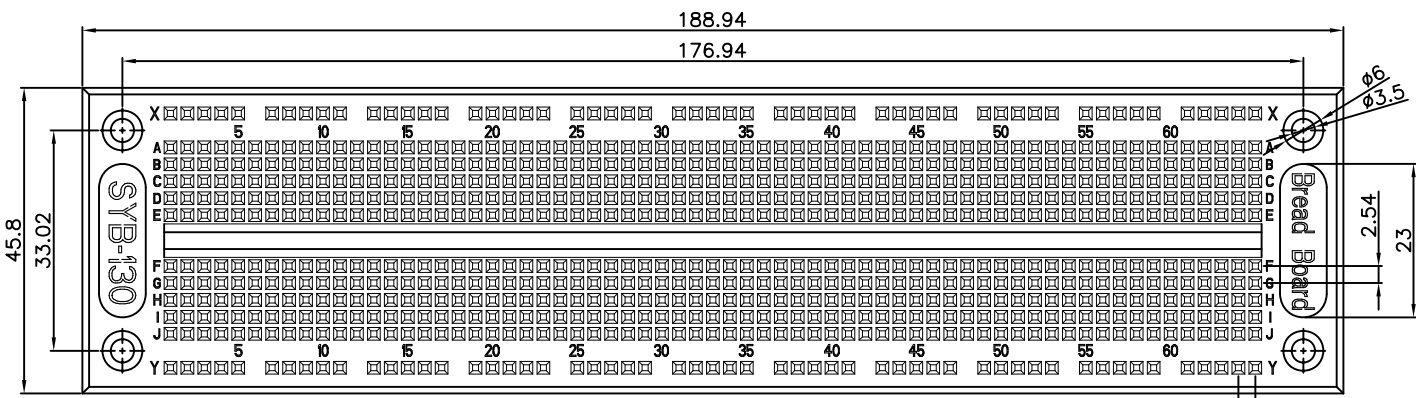

NOTES:

1. Materials
  - 1.1. Insulator: thermoplastic
2. Specifications
  - 2.1. Temperature range: -20~+80°C.
  - 2.2. Contact resistance: 100mΩ max.
  - 2.3. Insulation resistance: 1000MΩ min.
  - 2.4. Dielectric withstanding voltage: AC 500V Per minute.

3. Product number code:

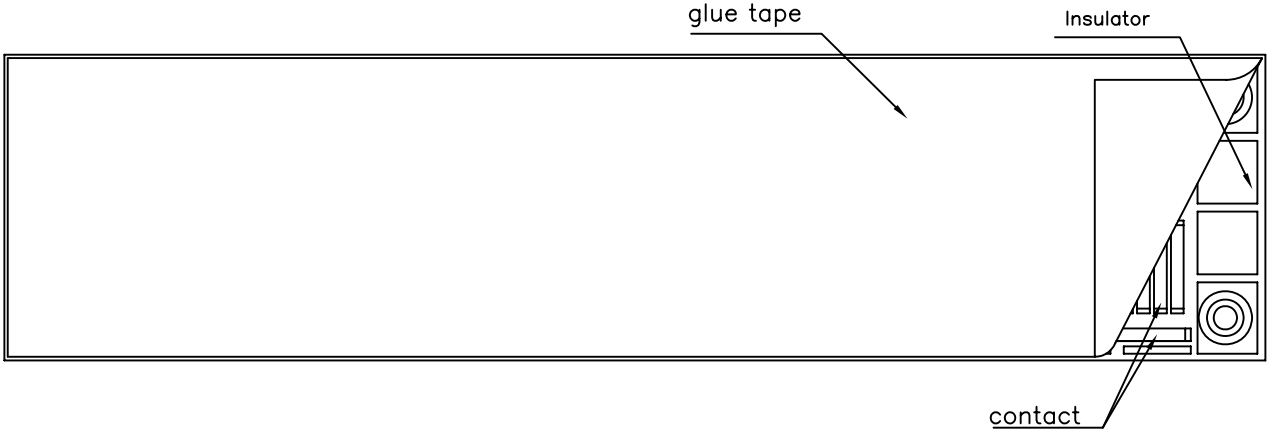
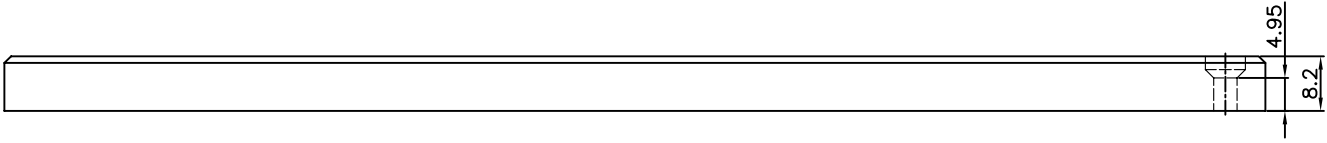
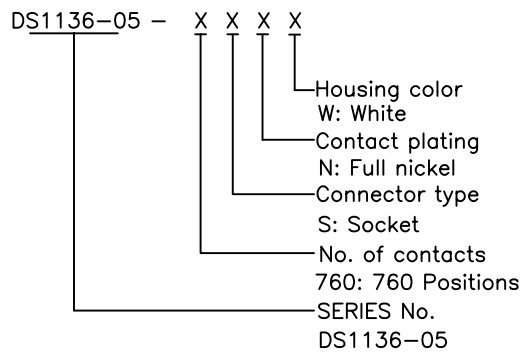

GENERAL TOLERANCE		ANGLE TOLERANCE		PROJECTION		TITLE	Bread Board pitch 2.54mm	
X.	±0.60	X.	±5°	UNITS		mm		
.X	±0.38	.X	±3°	SHEET SIZE	A4	SERIES	DS1136-05	SERIES
.XX	±0.25	.XX	±2°					
DRAWING TYPE		CUSTOMER						
SCALE		1:1	SHEET	1 OF 1				
DRAWING NO.		C-DS1136-05-XXXX						