

Recommand PCB Layout

SPECIFICATIONS

Current rating : 1A AC,DC
 Voltage rating : 100V AC,DC
 Temperature range : -25°C to +85 °C
 Contact resistance : 20m Ω Max.
 Insulation resistance : 500M Ω Min.
 Withstanding voltage : 500V AC/minute
 Material : Pin-Brass/Tin-plated
 Base-Nylon 6T, UL94V-0

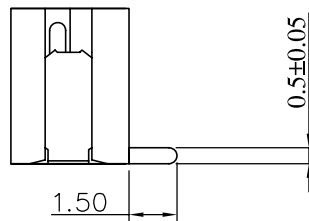
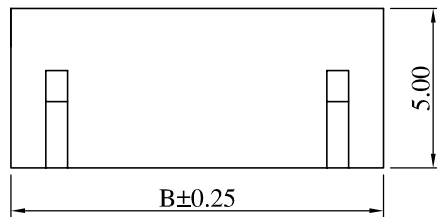

Ordering Information & Dimensions

| Poles | Part No. | Dimension (mm) | | |
|-------|------------|----------------|-------|-------|
| | | A | B | C |
| 2 | 150G1-MV02 | 1.50 | 6.00 | 3.60 |
| 3 | 150G1-MV03 | 3.00 | 7.50 | 5.10 |
| 4 | 150G1-MV04 | 4.45 | 9.00 | 6.60 |
| 5 | 150G1-MV05 | 6.00 | 10.50 | 8.10 |
| 6 | 150G1-MV06 | 7.50 | 12.00 | 9.60 |
| 7 | 150G1-MV07 | 9.00 | 13.50 | 11.10 |
| 8 | 150G1-MV08 | 10.50 | 15.00 | 12.60 |
| 9 | 150G1-MV09 | 12.00 | 16.50 | 14.10 |
| 10 | 150G1-MV10 | 13.50 | 18.00 | 15.60 |
| 11 | 150G1-MV11 | 15.00 | 19.50 | 17.10 |
| 12 | 150G1-MV12 | 16.50 | 21.00 | 18.60 |
| 13 | 150G1-MV13 | 18.00 | 22.50 | 20.10 |

| | | |
|-----|------------------|--------------------|
| Rev | Description/Date | Drawn By: Storm.li |
| △ | | Checked By: Simmon |
| △ | | Approved By: Tony |

| | |
|-----------|---------------------------------------|
| Customer: | |
| Part No.: | 150G1-MVXX |
| Title: | 1.50mm Wire to Board SMD 180° Type |

| | | |
|-----------------------------|--------------|---|
| Third angle projection | | X.± .X±0.30 .XX±0.20 .XXX±0.10 |
| General Dimension Tolerance | Units: mm | |

SGS Report No.:CE/2005/63612D