

Rev	Revisions	Rev.Drawn	Date
2			20.08.07

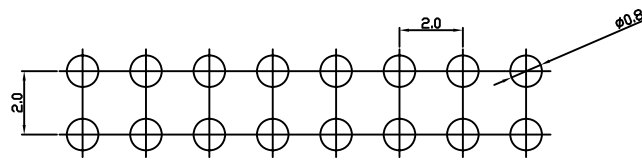
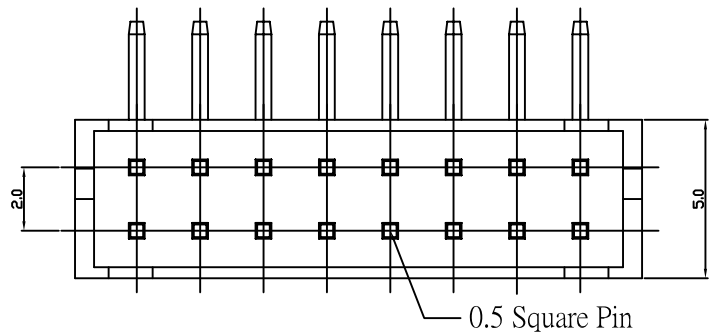

RECOMMENDED P.C.BOARD HOLE DIMM.

### SPECIFICATIONS

Electrical  
 Current Rating: 2A AC DC  
 Voltage Rating: 250V AC, DC  
 Operating Temp.: -25°C ~ +85°C  
 Contact Resistance: 20mΩ / Max.  
 Insulation Resistance: 1000MΩ / Min.

Material  
 Terminal Material: Brass/ Tin-plated/ Gold-plated  
 Material: Nylon 66, UL 94V-0+GF

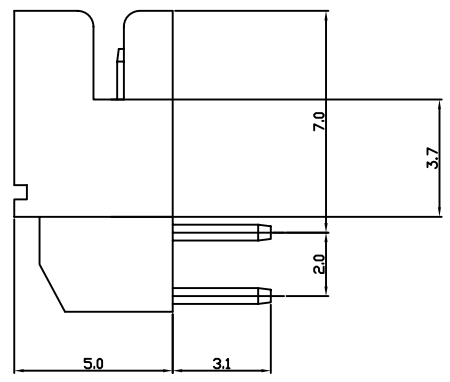
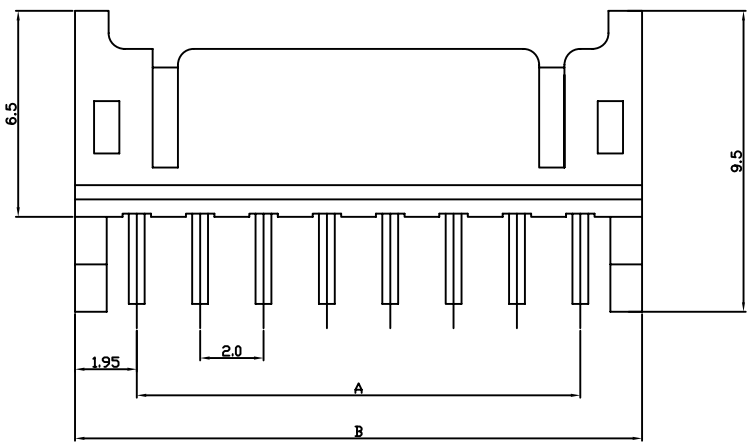

Poles	Dimension mm (in.)		Note.
	A	B	
6	4.0	8.0	
8	6.0	10.0	
10	8.0	12.0	
12	10.0	14.0	
14	12.0	16.0	
16	14.0	18.0	
18	16.0	20.0	
20	18.0	22.0	
22	20.0	24.0	
24	22.0	26.0	
26	24.0	28.0	
28	26.0	30.0	
30	28.0	32.0	
32	30.0	34.0	

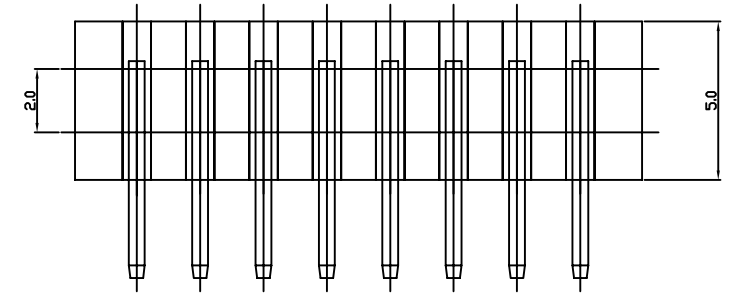

SGS Report No.:	Customer:	Part No.: 200G5-RXX
Title: 2.0mm Wire-to-Board Header 90°Dual Row type		
Drawn By: Storm.Li	SCALE: 1:1	SHEET: 1/1
Checked By: Simmon	REV: A	DWG NO.:
Approved By: Tony	TOLERANCE:	
Thire angle Projection		Units: mm
General Dimension Tolerance		
ANGLES ±		