



■ Single & Double-Ended Cordsets

Rugged, compact, sealed connectors used for trunk or drop lines. It comes in a range of lengths to match any marine installation requirements.

■ Specifications:

MECHANICAL	Pin Configuration: Contact Housing Mat'l: Overmoulding Mat'l: Contact Mat'l: Screw Nut Mat'l:	5 Contacts TPU, Black PVC, Black Copper Alloy, Gold Plated Zinc Alloy, Nickel Plated
ELECTRICAL	Rated Current: Rated Voltage:	9.0 Amps 300V
CABLE	Outer Jacket Mat'l: Conductor Insulation Mat'l: No. of Conductors: Shielding (3-Levels):	PVC, Gray PE (data), PVC (power) Power 1Px16 AWG, 1Px18 AWG, 18 AWG Drain Wire Braid (Overall), Al/My (Power), Al/My (Data)
ENVIRONMENTAL	Protection Class: Temperature Range:	IEC IP67 (mated) -20°C ~ 80°C
APPROVALS	Flame Test (Cable): Suitability:	UL1685 FT4 (UL), FT4 (CSA) Sunlight & Oil Resistance

■ Products:

P/N	Version	Description
93051103-01-3XX	Metal	5Pin Male Cordset, Single-Ended
93054103-01-3XX	Metal	5Pin Female Cordset, Single-Ended
93058108-01-3XX	Metal	5Pin M to F Cordset, Double-Ended

Note : XX-denotes Cable length in Meters (m)



T-Cable Assy

Connected at the central part of the system, the T-Cable assy is designed to prevent errors in connecting power or network cables and provide easy installation.

Specifications:

MECHANICAL	Pin Configuration: Contact Housing Mat'l: Overmoulding Mat'l: Contact Mat'l: Screw Nut Mat'l:	5 Contacts TPU, Black PVC, Black Copper Alloy, Gold Plated Zinc Alloy, Nickel Plated / Nylon+GF
ELECTRICAL	Rated Current: Rated Voltage:	9.0 Amps 300V
CABLE	Outer Jacket Mat'l: Conductor Insulation Mat'l: No. of Conductors: Shielding (3-Levels):	PVC, Gray PE (data), PVC (power) Power 1Px16 AWG, 1Px18 AWG, 18 AWG Drain Wire Braid (Overall), Al/My (Power), Al/My (Data)
ENVIRONMENTAL	Protection Class: Temperature Range:	IEC IP67 (mated) -20°C ~ 80°C
APPROVALS	Flame Test (Cable): Suitability:	UL1685 FT4 (UL), FT4 (CSA) Sunlight & Oil Resistance

Products:

P/N	Version	Description
93050122-01-3XX	Metal	5Pin Male-Female T-Cable Assy

Note : XX-denotes Cable length in Meters (m)

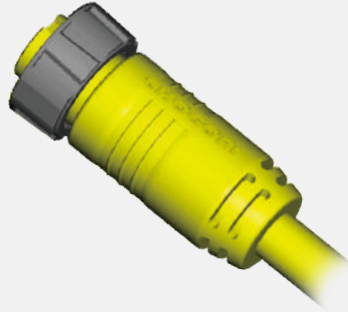

Power Cordset

The Powercord is connected to a Powertap to provide bus power to NMEA 2000 network. It connects power supply to NMEA 2000 Trunk line for a convenient plug/play connection.

Specifications:

MECHANICAL	Pin Configuration:	4 Contacts
	Contact Housing Mat'l:	TPU
	Overmoulding Mat'l:	PVC, Yellow
	Contact Mat'l:	Copper Alloy, Gold Plated
	Screw Nut Mat'l:	Zinc Alloy, Nickel Plated
	Outer Jacket Mat'l:	PVC, Yellow
	Number of Conductors:	4x16 AWG
ELECTRICAL	Rated Current:	9.0 Amps
	Rated Voltage:	600V
ENVIRONMENTAL	Protection Class:	IEC IP67 (mated)
	Temperature Range:	-20°C ~ 85°C

Products:

P/N	Version	Description
93044103-31-3XX	Metal	4Pin Female Powercord

Note : XX-denotes Cable length in Meters (m)



Field Installable Connectors

Like the cordsets, the trunk or backbone cables can also be created by running bulk cable using field installable connectors which are available in Male/Female versions. Using screw-in termination, the clamping parts are designed to yield to tensile stress when tightening the terminal screws.

Specifications:

MECHANICAL	Pin Configuration: Contact Housing Mat'l: Contact Mat'l: Screw Nut Mat'l: Max Wire Size: Cable Range:	5 Contacts Nylon+GF, Black Copper Alloy, Gold Plated Zinc Alloy, Nickel Plated 0.75mm ² (18AWG) 9~12mm
ELECTRICAL	Rated Current: Rated Voltage:	9.0 Amps 250V
ENVIRONMENTAL	Protection Class: Temperature Range:	IEC IP67 (mated) -40°C ~ 105°C

Products:

P/N	Version	Description
93054101-01	Metal	5Pin Female Field Installable Conn, Screw-In, 180°
93051101-01	Metal	5Pin Male Field Installable Conn, Screw-In, 180°



■ Termination Resistors

The NMEA 2000 network must be provided with a terminating resistor at both ends of the trunk lines in order to avoid signal reflection. For reliable and secured connections, connectors are designed with a rugged screw lock mechanism.

■ Specifications:

MECHANICAL	Pin Configuration: Contact Housing Mat'l: Contact Mat'l: Screw Nut Mat'l:	5 Contacts TPU Copper Alloy, Gold Plated Zinc Alloy, Nickel Plated
ELECTRICAL	Rated Voltage: Internal Resistor:	300V 120 Ohms (1/4 W)
ENVIRONMENTAL	Protection Class: Temperature Range:	IEC IP68 (mated) -20°C ~ 80°C

■ Products:

P/N	Version	Description
93051103-32	Metal	5Pin Male Termination Resistor
93054103-32	Metal	5Pin Female Termination Resistor



T-Adaptor / Elbow Adaptor

The T-Adaptor is required for adding components to NMEA 2000 network. It is installed on the backbone cable and uses one end of the T-Connector for the drop cable. With two female and one male connector, it can be easily connected to mini cordsets available in various lengths.

Also available in Elbow -designed adaptor used in spots where it is impossible to bend a cordset around tight corners. It easily connects to a tee or double-ended cordsets making 90°turns practical at the end or anywhere along the system.

Specifications:

MECHANICAL	Pin Configuration: Contact Housing Mat'l: Overmoulding Mat'l: Contact Mat'l: Screw Nut Mat'l:	5 Contacts TPU, Black PVC, Black Copper Alloy, Gold Plated Zinc Alloy, Nickel Plated
ELECTRICAL	Rated Current: Rated Voltage:	9A 300V
ENVIRONMENTAL	Protection Class: Temperature Range:	IEC IP67 (mated) -20°C ~ 80°C

Products:

P/N	Version	Description
93050123-01	Metal	5Pin M-F-F T-Adaptor
93058111-01	Metal	5Pin M-F Elbow Adaptor



■ Bulkhead Feed-Thru

The Bulkhead Feed-Thru allows new connection point in a network installation. It creates positive alignment of connection when use thru panels or bulkheads.

■ Specifications:

MECHANICAL	Pin Configuration: Contact Housing Mat'l: Housing Mat'l: Contact Mat'l: Screw Nut Mat'l: O-ring Mat'l:	5 Contacts Nylon Brass, Nickel Plated Copper Alloy, Gold Plated Copper Alloy, Nickel Plated Silicone
ELECTRICAL	Rated Current: Rated Voltage:	9.0 Amps 600V
ENVIRONMENTAL	Protection Class: Temperature Range:	IEC IP68 (Unmated) -40°C ~ 105°C

■ Products:

Part Numbers	Description
93050100-01	Male to Female Bulkhead Feed-Thru



Waterproof Caps

Products:

Part Numbers	Description
806-00080-00	Mini Cap for Male Conn
806-00081-00	Mini Cap for Female Conn