

REV.	DESCRIPTION	DRAWN	CHECKED	APPROVED
A	NEW RELEASE	JLZ 05/20/17'		

NOTES:

1.SPECIFICATION

- .CURRENT RATING: 5A~7A.
- .DIELECTRIC WITH STANDING VOLTAGE: 1000V(AC)
- .CONTACT RESISTANCE: 20mΩ Max.
- .INSULATION RESISTANCE: 1000MΩ(DC)Min

2.PRODUCT NUMBER CODE:

DS1110-20 - X X X X

SHELL SURFACE FINISHED
N: Nickel

CONTACT PLATING
6: Tin

COLOR OF HOUSING:
B: Black

No. OF CONTACTS

- 02: 2pin 03: 3pin
- 04: 4pin 05: 5pin
- 06: 6pin 07: 7pin
- 08: 8pin 09: 9pin
- 10: 10pin

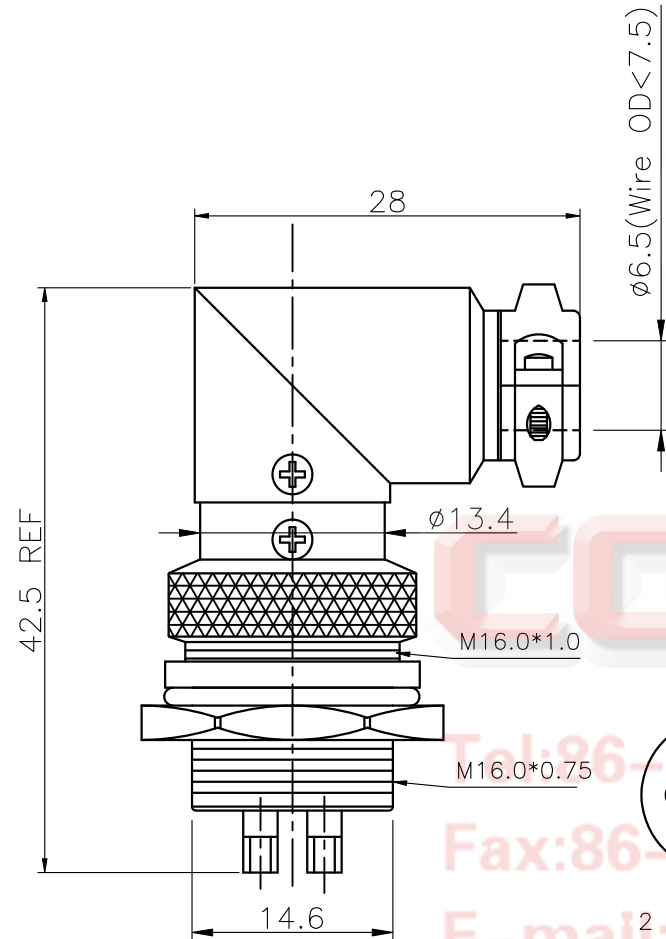

2 PIN(ø2.5 7A)

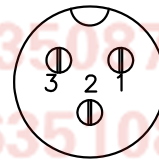

3 PIN(ø2.5 7A)

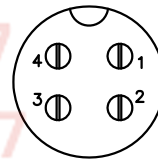

4 PIN(ø2.5 7A)

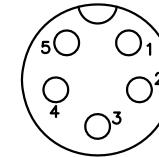

5 PIN(ø2.0 7A)

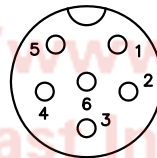

6 PIN(ø1.2 5A)

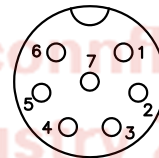

7 PIN(ø1.2 5A)

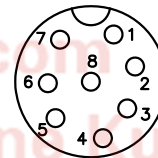

8 PIN(ø1.2 5A)

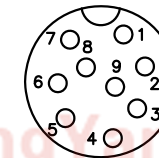

9 PIN(ø1.2 5A)

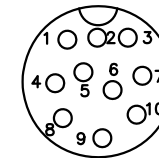

10 PIN(ø1.2 5A)

GENERAL TOLERANCE		ANGLE TOLERANCE		PROJECTION		TITLE	Micro Jack Total Length=42.5mm Ref (Pin ø1.2~2.5) R/A Threaded Type
X.	±0.60	X.	±5°	UNITS	mm		
.X	±0.38	.X	±3°	SHEET SIZE	A4	SERIES	DS1110-20 SERIES
.XX	±0.25	.XX	±2°	DRAWING TYPE CUSTOMER			
SCALE		1:1	SHEET		1 OF 1		
DRAWING NO.		C-DS1110-20-XXXX-A					



晨翔电子有限公司

CONNFLY CONNFLY ELECTRONIC CO. LTD