

PLS12 系列 2T-8T
PLS12 series 2T-8T

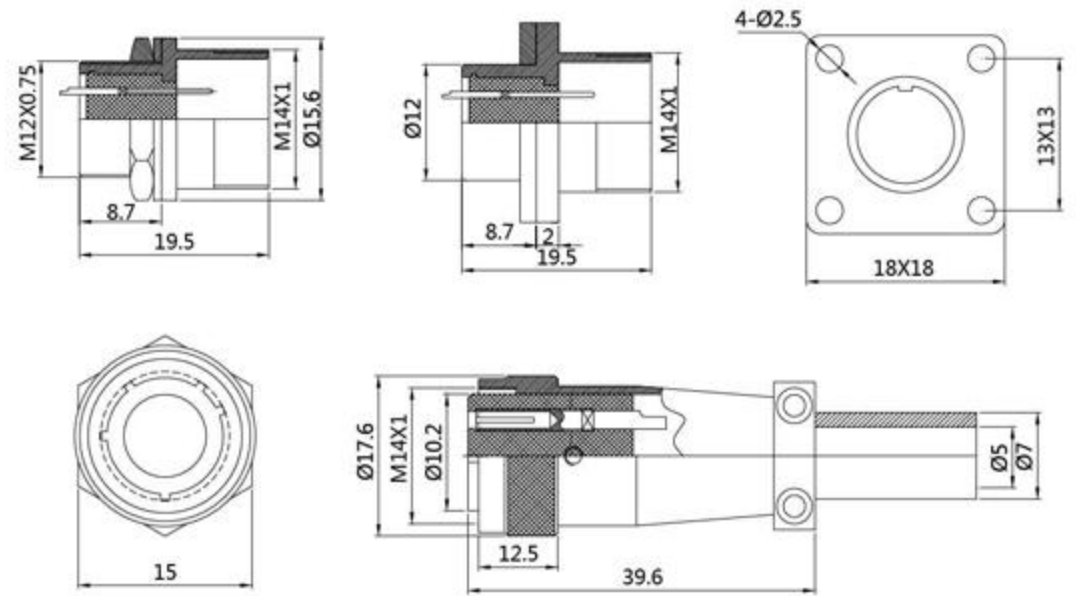

No. of contacts	PLS12-2		PLS12-3		PLS12-3		PLS12-4		PLS12-5		PLS12-6		PLS12-7		PLS12-8	
	正装	反装	正装	反装	正装	反装	正装	反装	正装	反装	正装	反装	正装	反装	正装	反装
接触对排列分布 从针的方向看 Contact Arrangements Comply with the needle direction																
额定电流/电压 Rated current/voltage	5A-125V		5A-125V		5A-125V		5A-125V		5A-125V		5A-125V		5A-125V		5A-125V	
工作电压(AC.V)分钟 Operatin limit voltage(AC.V.rms)	200		200		200		200		200		200		200		200	
耐电压(AC.V)1分钟 Withstanding voltage(AC.V.rms)1minute	1000		1000		1000		1000		1000		1000		1000		1000	
绝缘阻抗(MΩ)DV500V Insulation resistance(MΩ MIX.)At DC500V	1000		1000		1000		1000		1000		1000		1000		1000	
接触阻抗(MΩ)DC1A Contact resistance(MΩ MIX.)AT DC 1A	10		10		10		10		10		10		10		10	
焊线口径Φ(mm) Solder cup mouth aperture	1.7		1.7		0.9		0.9		0.9		0.9		0.9		0.9	
接触对孔径Φ(mm) Solder inter diameter	1.6		1.6		1		1		1		1		1		1	

PLS16 系列 2T-9T
PLS16 series 2T-9T

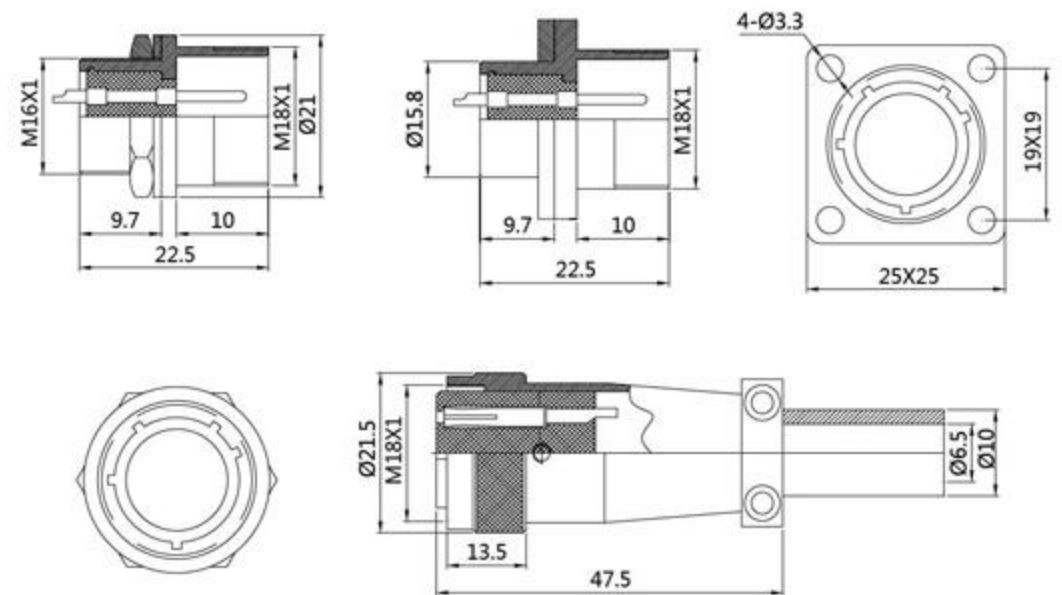

No. of contacts	PLS16-2		PLS16-3		PLS16-4		PLS16-5		PLS16-6		PLS16-7		PLS16-8		PLS16-9	
	正装	反装	正装	反装	正装	反装	正装	反装	正装	反装	正装	反装	正装	反装	正装	反装
接触对排列分布 Contact Arrangements																
额定电流/电压 Rated current/voltage	7A-150V		7A-150V		7A-150V		7A-150V		7A-150V		7A-150V		7A-150V		7A-150V	
工作电压(AC.V)分钟 Operatin limit voltage(AC.V.rms)	250		250		250		250		250		250		250		250	
耐电压(AC.V)1分钟 Withstanding voltage(AC.V.rms)1minute	1500		1500		1500		1500		1500		1500		1500		1500	
绝缘阻抗(MΩ)DV500V Insulation resistance(MΩ MIX.)At DC500V	2000		2000		2000		2000		2000		2000		2000		2000	
接触阻抗(MΩ)DC1A Contact resistance(MΩ MIX.)AT DC 1A	10		10		10		10		10		10		10		10	
焊线口径Φ(mm) Solder cup mouth aperture	1.7		1.7		1		1		1		1		1		1	
接触对孔径Φ(mm) Solder inter diameter	1.6		1.6		1		1		1		1		1		1	