

## SPECIFICATION

Current Rate: 1 AMP  
 Insulation Resistance: 1000M  $\Omega$  Min.  
 Contact Resistance: 20m  $\Omega$  Max.  
 Dielectric Voltage: 500V AC for one minute  
 Operation Temperature: -40°C to +105°C

## MATERIAL

Insulator: Polyester, UL 94V-0  
 Standard: Nylon 6T  
 Contact Pin: Copper Alloy  
 Contact Plating: Gold Flash all over

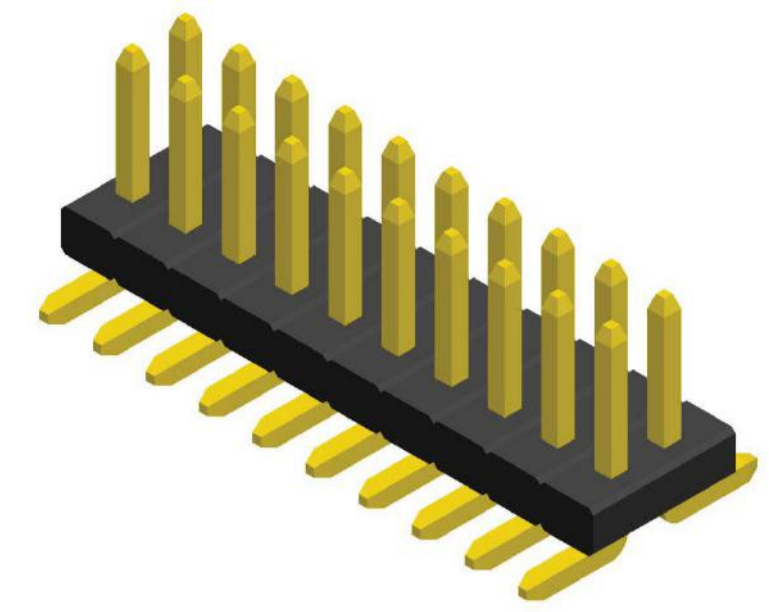

# PLLD1.27-xS

Pin Header 1.27mm SQ Pin=0.4mm 2 Row H=0.85/1.0/1.5/1.7/2.0/2.5mm SMT Type

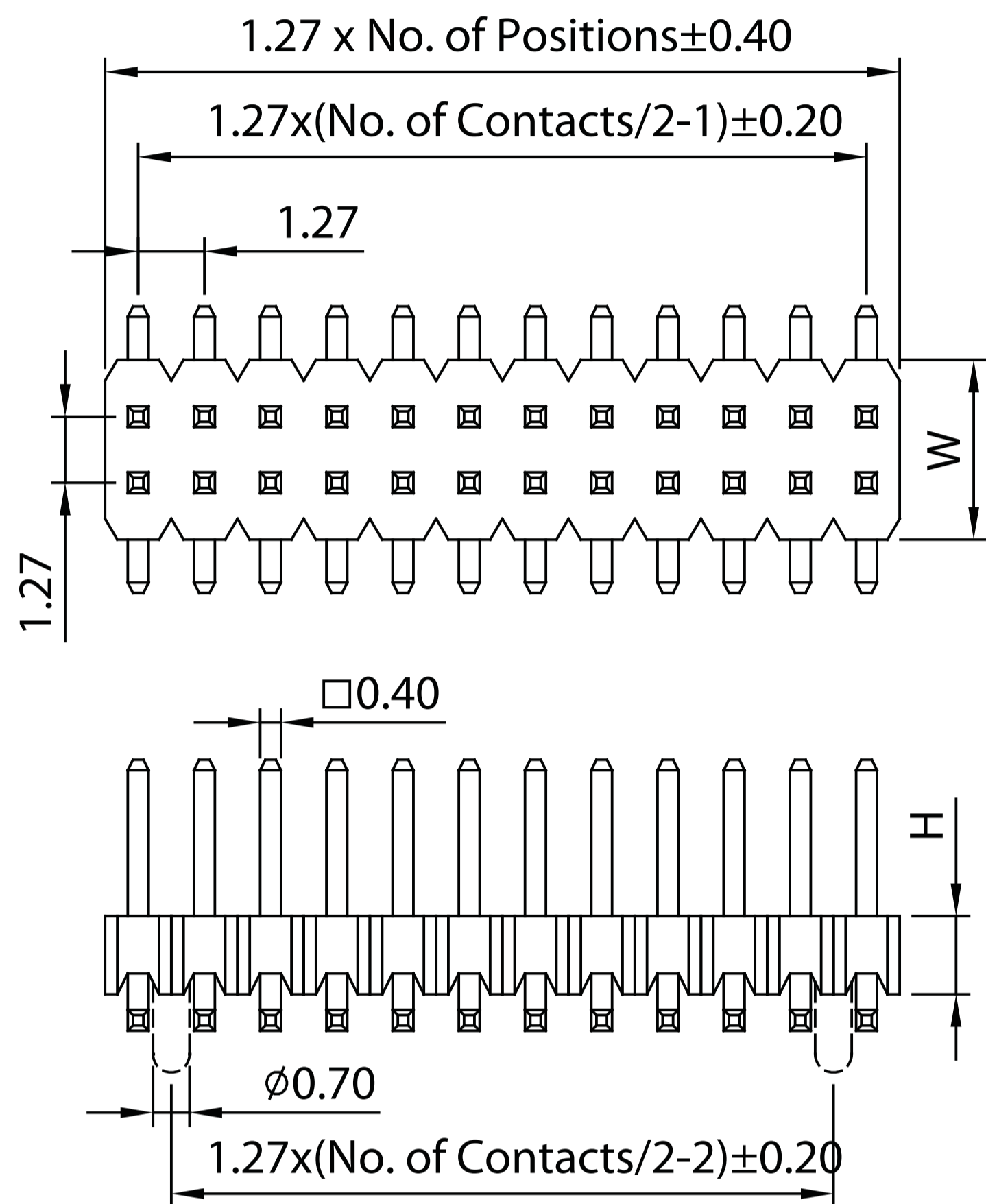

	Dim. C	Dim. W
H=0.85mm	1.30	3.40
H=1.0mm	1.50	3.40
H=1.5mm	2.00	3.40
H=1.7mm	2.20	3.00
H=2.0mm	2.50	3.00
H=2.5mm	3.00	3.00

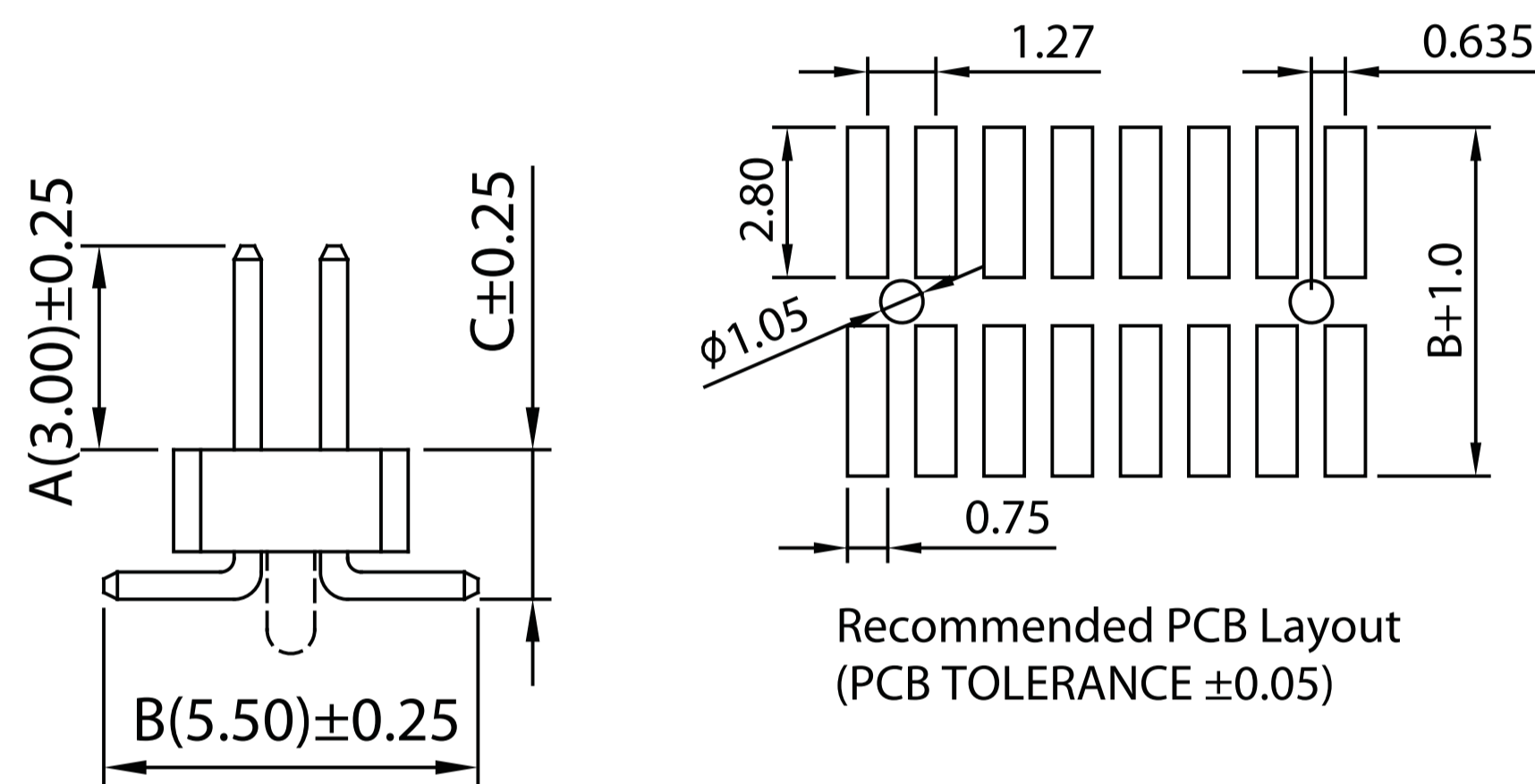

Recommended PCB Layout  
 (PCB TOLERANCE  $\pm 0.05$ )

# PLLHD1.27-xS

Pin Header 1.27mm SQ Pin=0.4mm 2 Row H=0.85/1.0/1.5/1.7/2.0/2.5mm Stack SMT Type

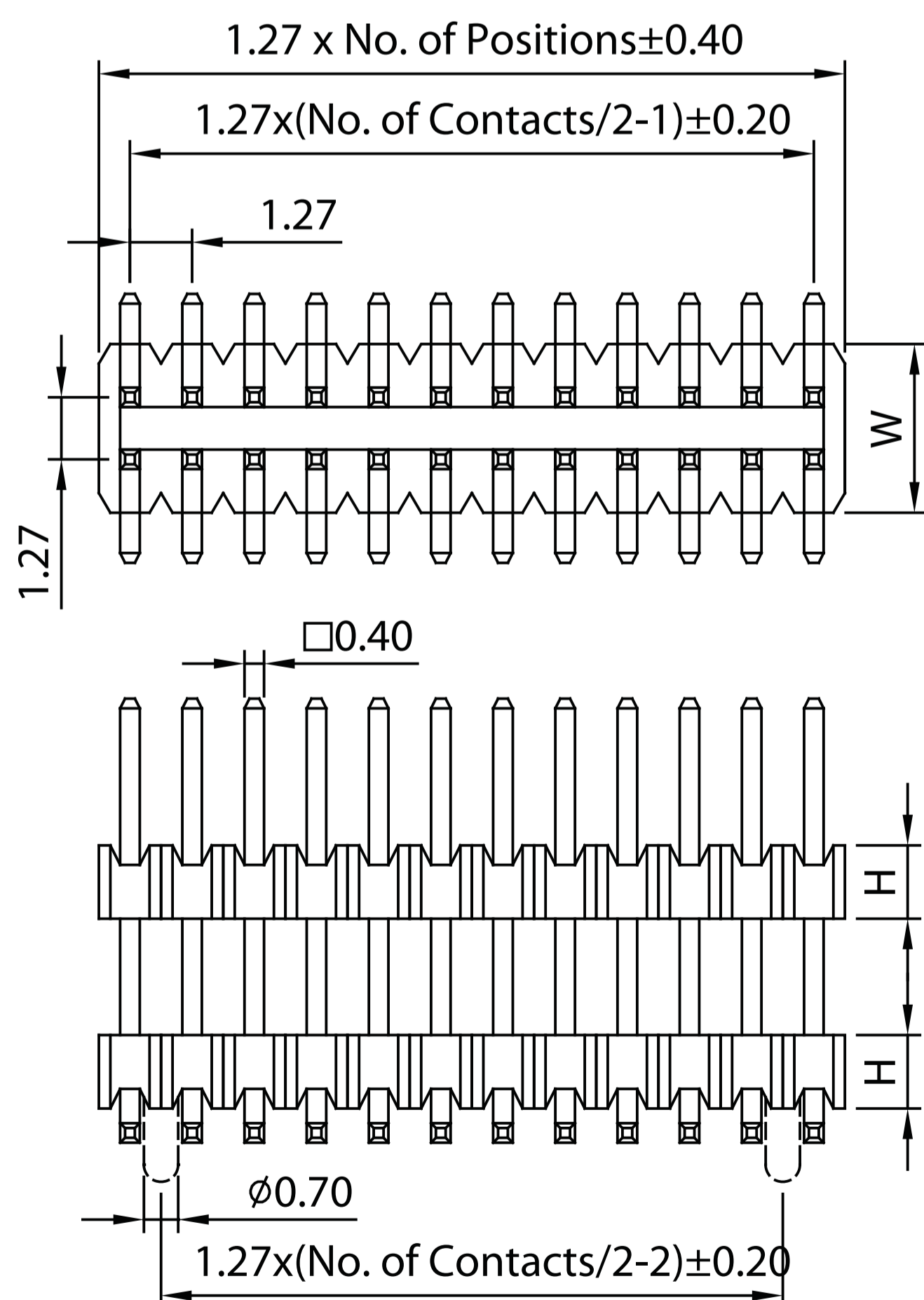

	Dim. C	Dim. W
H=0.85mm	1.30	3.40
H=1.0mm	1.50	3.40
H=1.5mm	2.00	3.40
H=1.7mm	2.20	3.00
H=2.0mm	2.50	3.00
H=2.5mm	3.00	3.00

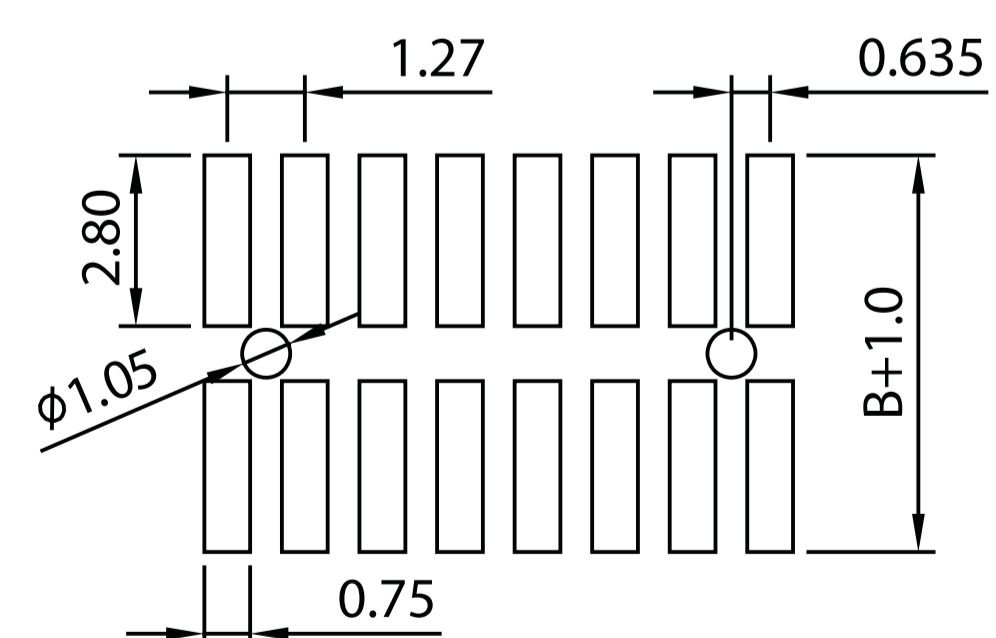
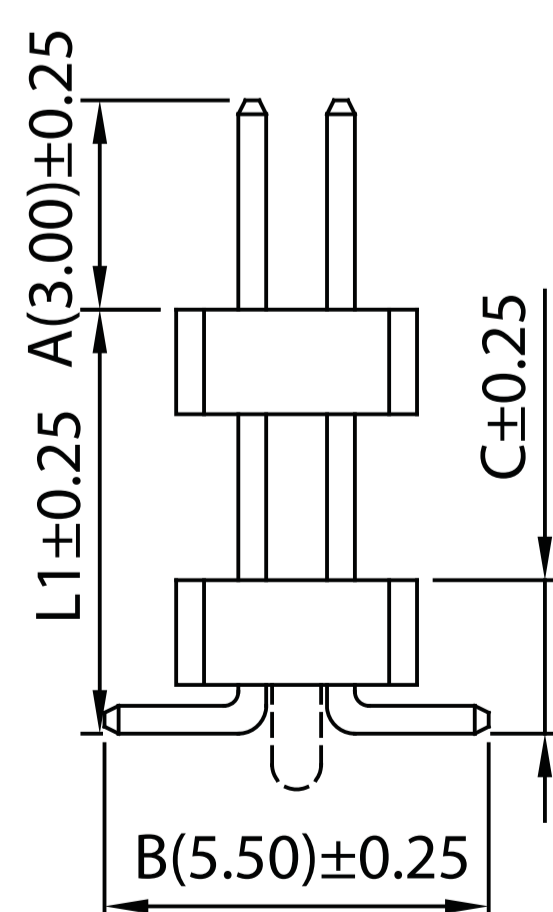

Recommended PCB Layout  
 (PCB TOLERANCE  $\pm 0.05$ )

