

1 2 3 4 5 6 7 8

A
B
C
D
E
F
G
H

A
B
C
D
E
F
G
H

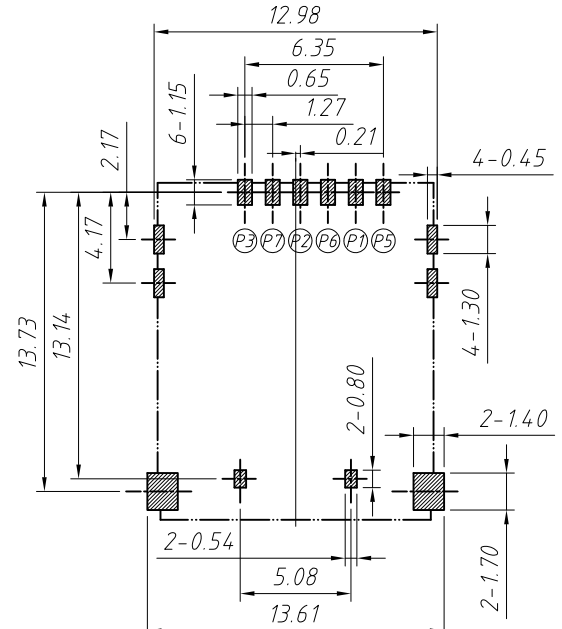
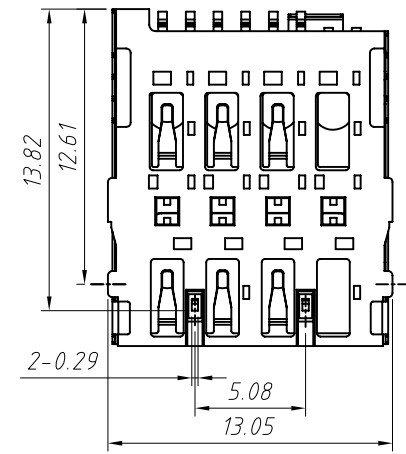
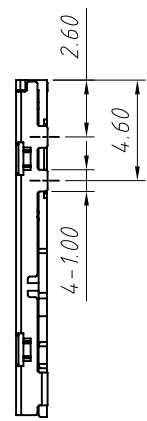
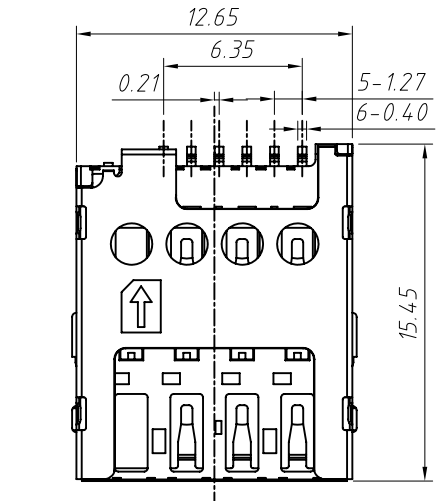

RECOMMENDED PCB LAYOUT
TOLERANCE ±0.05

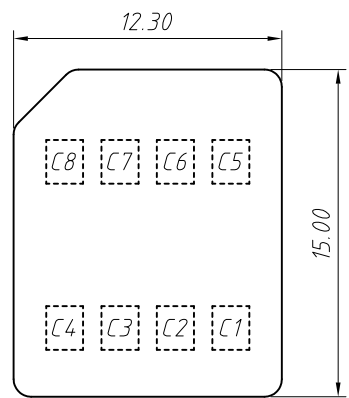
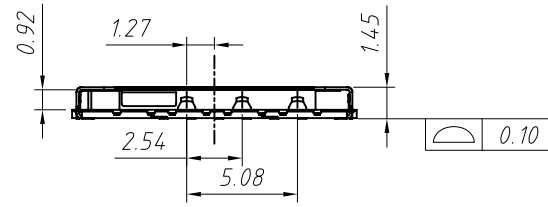

MICRO-SIM CARD DIM.(REF)

PIN ASSIGNMENT:
 PIN1:VCC
 PIN2:RST
 PIN3:CLK
 PIN4:RESERVED
 PIN5:GND
 PIN6:VPP
 PIN7:I/O
 PIN8:RESERVED

Material:
 Insulator:Hi-Temperature Plastic,UL 94 V-0.Black.
 Terminal:Copper Alloy,50u" min Nickel underplated on allover,gole plated allover.
 Shell:Stainless Steel,50u" Nickel underplated on allover,gole flash on solder latch.

Electrical:
 Current Rating:0.5 A
 Voltage Rating:5.0 V
 Insulation Resistance:500MΩ Min./500V DC
 Withstanding Voltage:250V AC For 1 minute.
 Contact Resistance:100mΩ Max.
 Operating Temp Range:-55°C TO +85°C
 Mating Cycles:5000 Insertions.

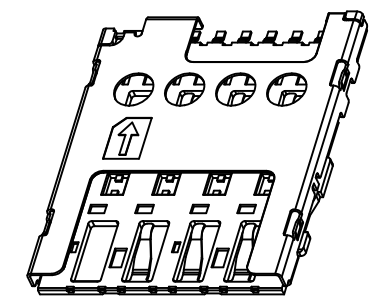

GENERAL TOLERANCE	ANGLE TOLERANCE	PROJECTION		
X ±0.15	X ±5°	UNITS	mm	Micro SIM Card CONN,6P,H1.45mm,SMD
.X ±0.03	.X ±3°	SHEET SIZE	A4	
.XX ±0.05	.XX ±2°	KLS P/N:		
Draw by: Jenny		Date:	2018-03-10	
Check by:		Date:	2018-03-10	
SCALE	SHEET 1 OF 1			



NingBo KLS ELECTRONIC CO.,L TD.

1 2 3 4 5 6 7 8