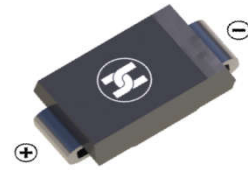
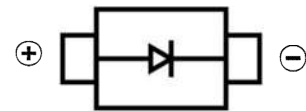

SCHOTTKY POWER RECTIFIER
FEATURES

- Highly stable oxide passivated junction
- Very low forward voltage drop

SMA

MECHANICAL DATA

- Case: SMA(DO-214AC)
- Case material: Molded plastic. UL flammability
- Classification rating: 94V-0
- Weight: 0.065 grams (approximate)

MAXIMUM RATINGS AND CHARACTERISTICS (T_A=25°C unless otherwise specified)

Parameter	Symbol	Value	Unit
Peak repetitive reverse voltage	V _{RRM}	40	V
Working peak reverse voltage	V _{RWM}		
DC blocking voltage	V _R		
Average rectified forward current (at rated V _R , T _L = 100°C)	I _O	3.0	A
Non-repetitive peak surge current (surge applied at rated load conditions half-wave, single phase, 60Hz)	I _{FSM}	100	
Storage/operating case temperature	T _{stg} , T _C	-55 ~ +150	°C
Operating junction temperature (note 1)	T _J	-55 ~ +150	°C
Voltage rate of change (rated V _R , T _J = 25°C)	dv/dt	10000	V/μs
Thermal resistance from junction to lead (note 2)	R _{θJL}	15	°C/W
Thermal resistance from junction to ambient (note 2)	R _{θJA}	81	

ELECTRICAL CHARACTERISTICS (T_A=25°C unless otherwise specified)

Parameter	Symbol	Max.	Unit	Conditions
Instantaneous Forward Voltage (Note 3)	V _F	0.45	V	I _F =3.0A, T _J =25°C
		0.39	V	I _F =3.0A, T _J =100°C
Instantaneous Reverse Current	I _R	0.3	mA	V _R =40V, T _J =25°C
		15		V _R =40V, T _J =100°C

Note: 1. The heat generated must be less than the thermal conductivity from junction-to-ambient: $dP_D/dT_J < 1/R_{\theta JA}$.

2. Mounted on 2" Square PC Board with 1 inch² total pad size, PC board FR4.

3. Pulse Test: pulse width ≤ 250μs, duty cycle ≤ 2%.

SCHOTTKY POWER RECTIFIER

Typical Characteristics

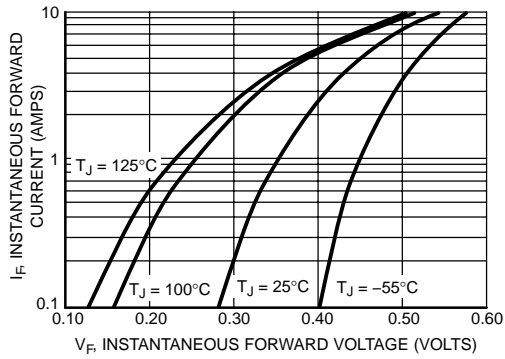

Figure 1. Typical Forward Voltage

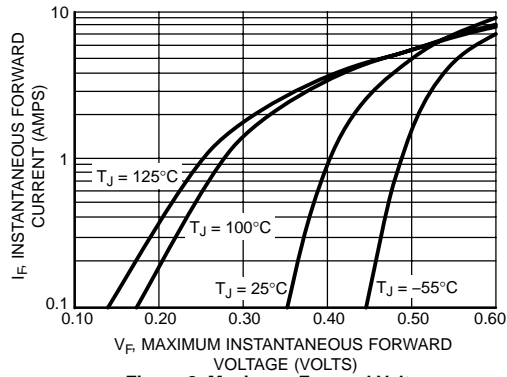

Figure 2. Maximum Forward Voltage

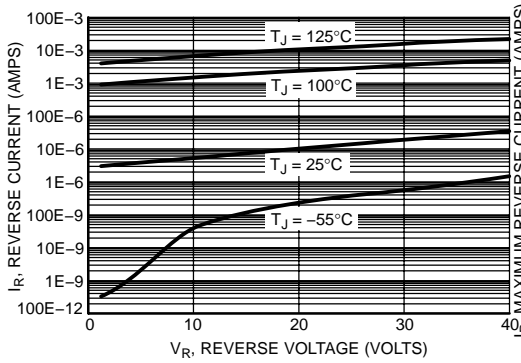

Figure 3. Typical Reverse Current

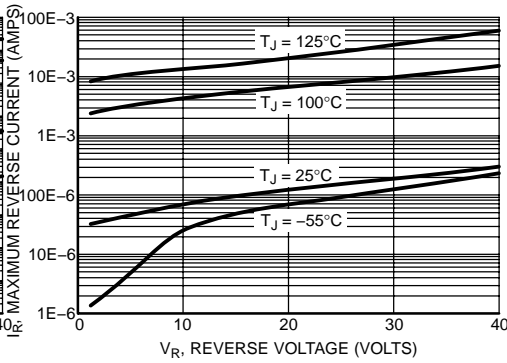

Figure 4. Maximum Reverse Current

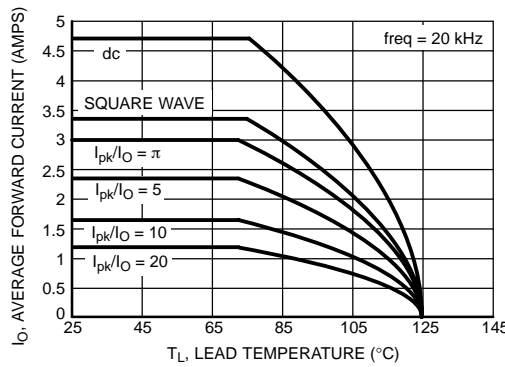

Figure 5. Current Derating

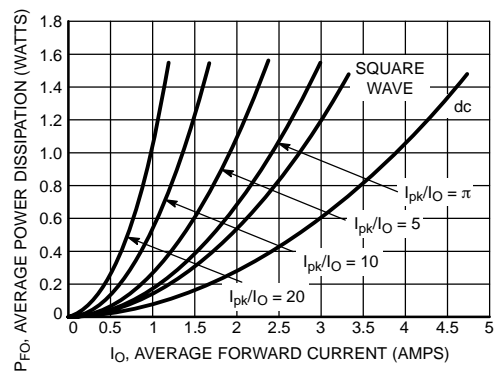

Figure 6. Forward Power Dissipation

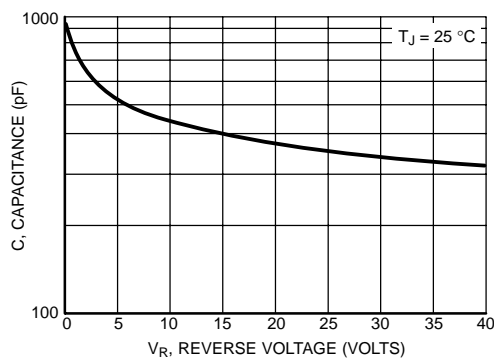

Figure 7. Capacitance

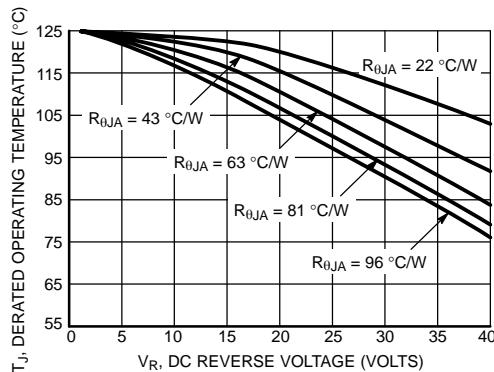

Figure 8. Typical Operating Temperature Derating

SCHOTTKY POWER RECTIFIER

Typical Characteristics (Continued)

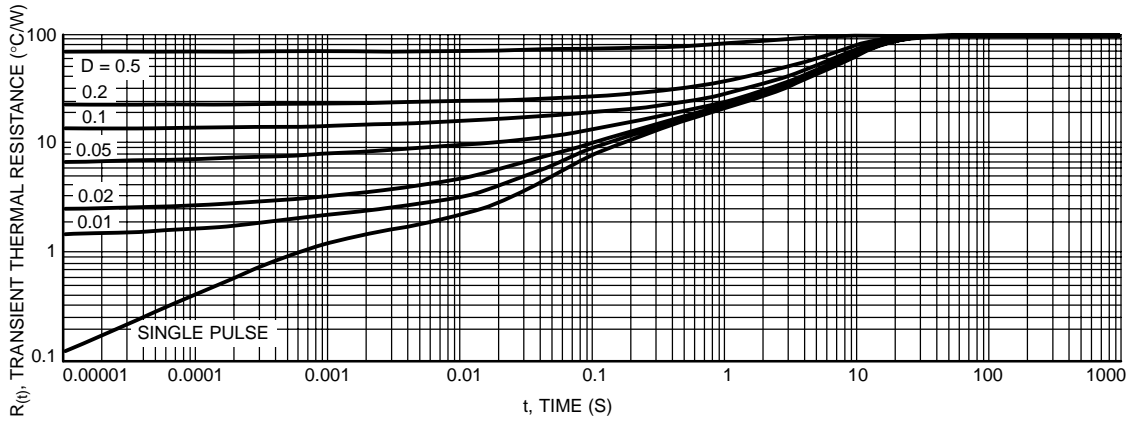

Figure 9. Thermal Response, Junction-to-Ambient (min pad)

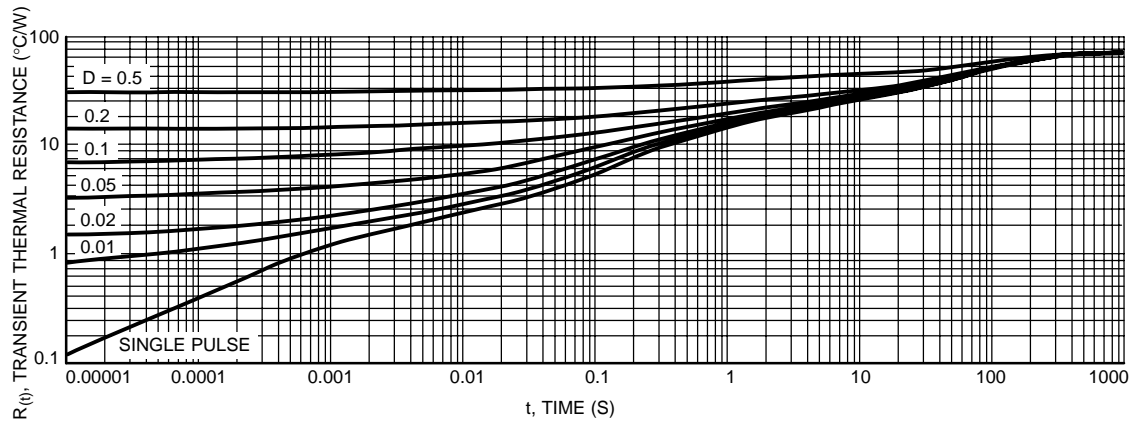
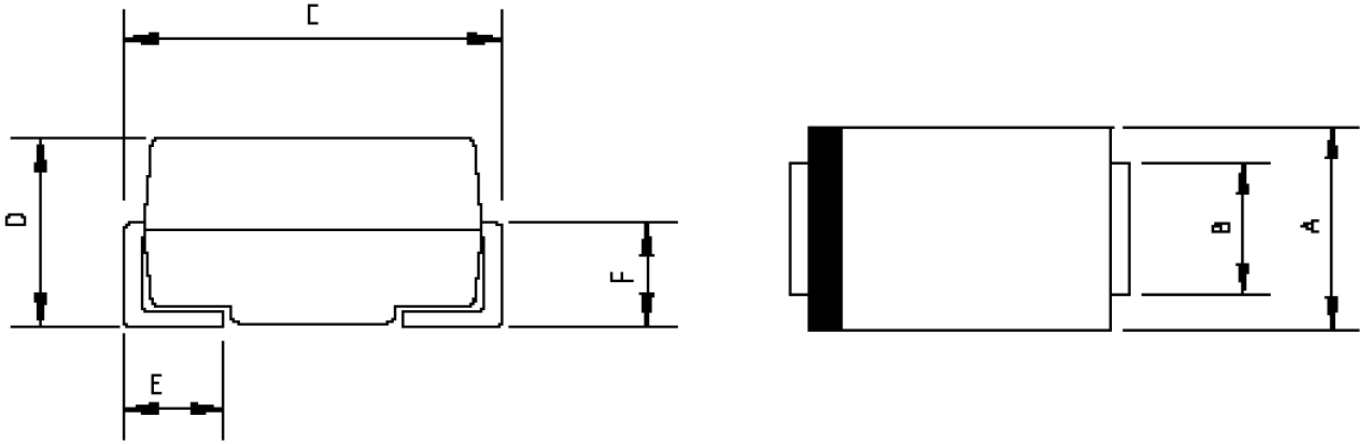

Figure 10. Thermal Response, Junction to Ambient (1 inch pad)

SCHOTTKY POWER RECTIFIER

SMA Package Outline Dimensions



Symbol	Dimensions In Millimeters		Dimensions In Inches	
	Min.	Max.	Min.	Max.
A	2.20	2.80	0.086	0.110
B	1.30	1.70	0.051	0.067
C	4.70	5.30	0.185	0.209
D	1.70	2.55	0.067	0.100
E	0.90	1.50	0.035	0.059
F	0.90	1.50	0.035	0.059

SMA Suggested Pad Layout

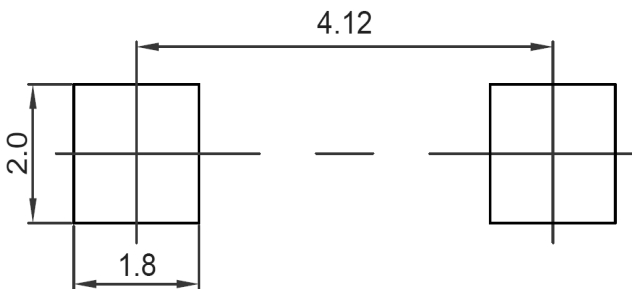

Note:

1. Controlling dimension: in millimeters
2. General tolerance: $\pm 0.05\text{mm}$
3. The pad layout is for reference purposes only

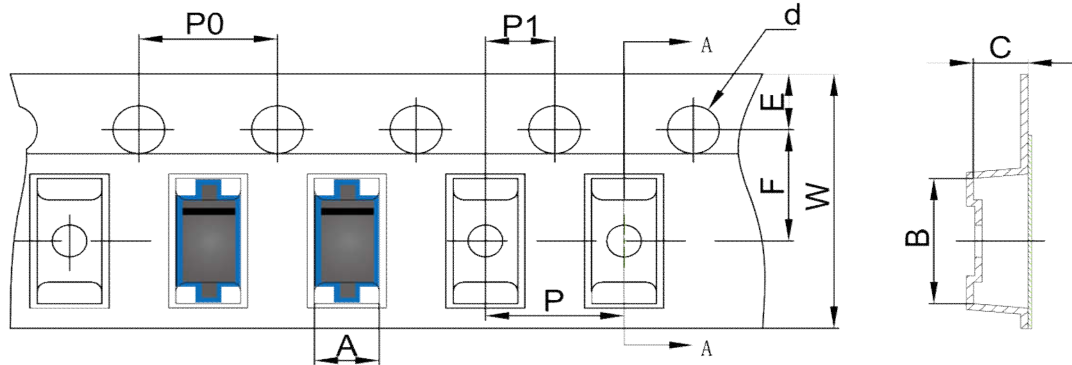
SCHOTTKY POWER RECTIFIER
SMA Tape and Reel
SMA Embossed Carrier Tape

DIMENSIONS ARE IN MILLIMETER										
TYPE	A	B	C	d	E	F	P0	P	P1	W
SMA	2.89	5.35	2.68	Ø1.50	1.75	5.50	4.00	4.00	2.00	12.00
TOLERANCE	±0.1	±0.1	±0.1	±0.1	±0.1	±0.1	±0.1	±0.1	±0.1	±0.1

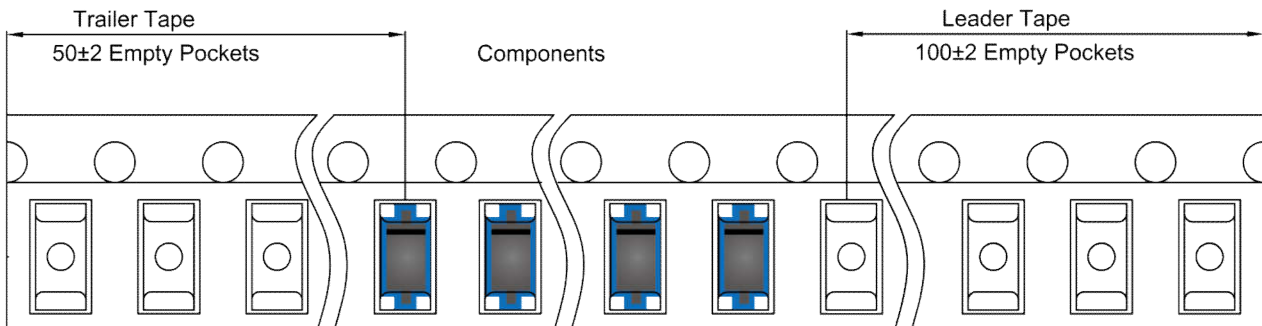
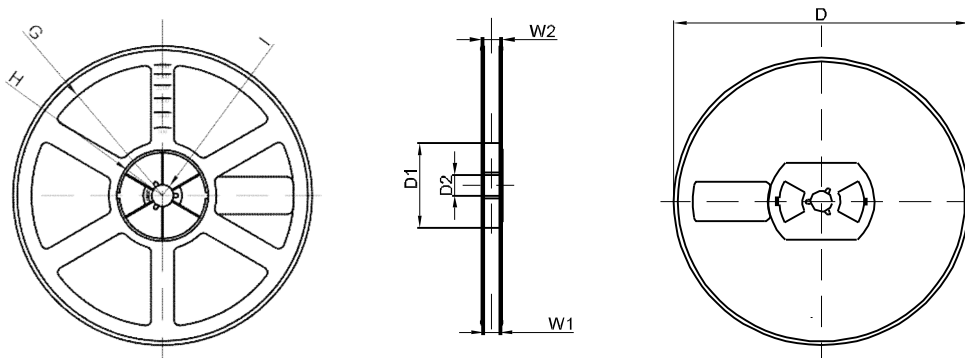
SMA Tape Leader and Trailer

SMA Reel

DIMENSIONS ARE IN MILLIMETER								
REEL OPTION	D	D1	D2	G	H	I	W1	W2
7" DIA	Ø178	54.40	13.00	R78	R25.60	R6.50	12.40	17.60
TOLERANCE	±2	±1	±1	±1	±1	±1	±1	±1