

## HA Series, Crimping connection, 10 pin, Male insert

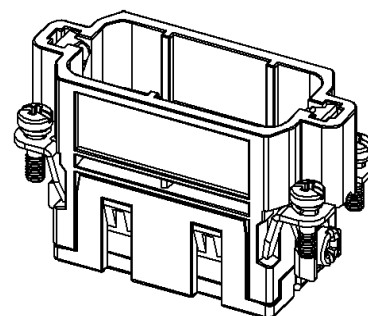
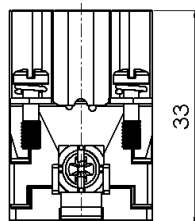
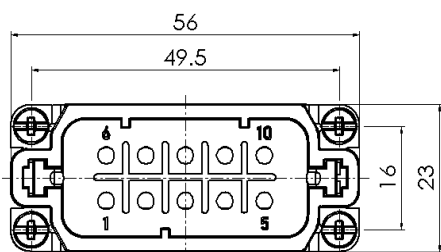

Typecode HA-010-MC  
ID 1 007 03 000007

### Technical Data

#### Product Properties

Series	HA
Mating with	H10A
Connection mode	Crimping connection
Gender	Male
Rated voltage	250 V
Rated current	16 A
Rated impulse voltage	4 kV
Mating contact series	16 A (ESM/EGM)
Number of pins	10
Core cross-section/Clamping ability	0.14~ 4 mm <sup>2</sup> / 26 AWG ~ 12 AWG
Grounding conductor	Yes
Pollution degree	3
Insulation resistance	$\geq 10^{10} \Omega$
Temperature range	-40 °C ~ +125 °C
Standard	EN 60664-1, IEC 61984

#### Insert

Material	PC
Colour	Gray (RAL 7032)

#### Commercial data

Weight	0.032 kg
Packaging unit	10 pcs
Country of origin	CN

### Features

- High quality engineering plastics
- Crimping connection
- $\geq 500$  Mating cycles
- Approval: CE
- RoHS-compliant

\*The design data are listed here, and the changes to the product are not described here. For unfinished matters, please contact customer service. It is the user's responsibility to verify functionality, compliance with applicable laws and instructions, and electrical safety in specific applications.