

## HK Series, Screw connection, 4/8 pin, Female insert

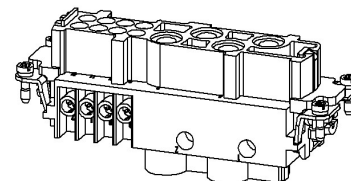
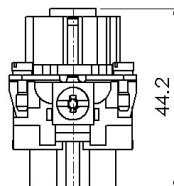
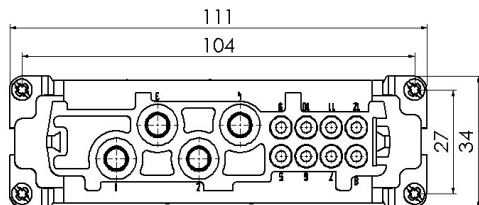

Typecode **HK-004/8-F**  
 ID **1 007 03 0000104**

### Technical Data

#### Product Properties

Series	HK
Mating with	H24B
Connection mode	Screw connection
Gender	Female
Rated voltage (power contacts)	830 V
Rated current (power contacts)	80 A
Rated voltage (control contacts)	400 V
Rated current (control contacts)	16 A
Rated impulse voltage (power contacts)	8 Kv
Rated impulse voltage (control contacts)	6 kV
Number of pins	12
Core cross-section/Clamping ability (power contacts)	1.5 ~ 16 mm <sup>2</sup> / 16 AWG~6 AWG
Core cross-section/Clamping ability (control contacts)	1.0 ~ 2.5 mm <sup>2</sup> / 18 AWG~14 AWG
Grounding conductor	Yes
Pollution degree	3
Insulation resistance	≥ 10 <sup>10</sup> Ω
Temperature range	-40 °C ~ +125 °C
Standard	EN 60664-1, IEC 61984

#### Insert

Material	PC
Colour	Gray (RAL 7032)

#### Commercial data

Weight	0.145 kg
Packaging unit	5 pcs
Country of origin	CN

### Features

- Power and control contacts
- High quality engineering plastics
- Screw connection
- ≥ 500 Mating cycles
- Approval: CE, UL
- RoHS-compliant

\*The design data are listed here, and the changes to the product are not described here. For unfinished matters, please contact customer service. It is the user's responsibility to verify functionality, compliance with applicable laws and instructions, and electrical safety in specific applications.