

GK300 series

■ Features

- AC input range selected by switch
- Class II power
- Protections : Short circuit /overload/over voltage/ over temp.
- Forced air cooling by build-in fan
- Cooling fan ON-Off auto control
- 100% full load burn-in test
- Approvals : UL/CE/CCC
- 1 year warranty



SPECIFICATION

Model		GK-300-5	GK-300-12	GK-300-24	GK-300-48
Output	DC Voltage	5V	12V	24V	48V
	Rated Current	60A	25A	12.5A	6.3A
	Current Range	0-60A	0-25A	0-12.5A	0-6.3A
	Rated Power	300W	300.8W	300.8W	302.4W
	Ripple & Noise	150mVp-p	150mVp-p	150mVp-p	240mVp-p
	Voltage ADJ. Range	4.75-5.5V	10.8-13.2V	21.6-26.4V	43.2-52.8V
	Voltage Tolerance	±1.5%	±1.0%	±1.0%	±1.0%
	Line Regulation	±0.5%	±0.5%	±0.5%	±0.5%
	Load Regulation	±1.0%	±0.5%	±0.5%	±0.5%
	Set up , rise time	300ms, 20ms/230Vac at full load			
	Hold Time	10ms/230Vac at full load			
Input	Voltage Range	85~132Vac , 185Vac~264Vac			
	Frequency Range	47~63Hz			
	Efficiency	78% 115Vac	81% 115Vac	84% 115Vac	85% 115Vac
	AC current	5A/115Vac 3A/230Vac			
	Inrush Current	Cold start 20A/115Vac 40A/230Vac			
	Leakage Current	<0.75mA 240Vac			
Protection	Over Load	105%- 150% rated output power			
		Shut off,AC recycle to re-start			
	Over Voltage	5.75~6.75V	13.8~16.2V	27.6~32.4V	55.2~64.8V
		Shut off,AC recycle to re-start ,after fault condition is removed .			
Environment	Working temp.	-10~ +60℃ (refer to output derating curve)			
	Working Humidity	20~90%RH non-condensing			
	Storage Temp., Humidity	-20~+85℃ , 10~95% RH			
	Temp. Coefficient	±0.03%/℃ (0~50℃)			
	Vibration	10~500Hz, 2G 10min./1cycle , period for 60min , each along X, Y, Z axes			
Safety & EMC	Safety Standard	UL1012, ,UL60950-1 approved .			
	Withstand Voltage	I/P-O/P:3KVac , I/P-FG:1.5KVac, O/P-FG:0.5KVac			
	Isolation Resistance	I/P-O/P,I/P-FG,O/P-FG:100M Ohms/500Vdc			
	EMI Conduction& Radiation	Compliance to EN55022 Class B			
	Harmonic Current	Compliance to EN61000-3-2,-3			
	EMS Immunity	Compliance to EN61000-4-2,3,4,5 ,EN55024			
Others	MTBF	50,000hours min 25℃			
	Dimension	215x115x50			
	Weight	0.95KGS/PC			

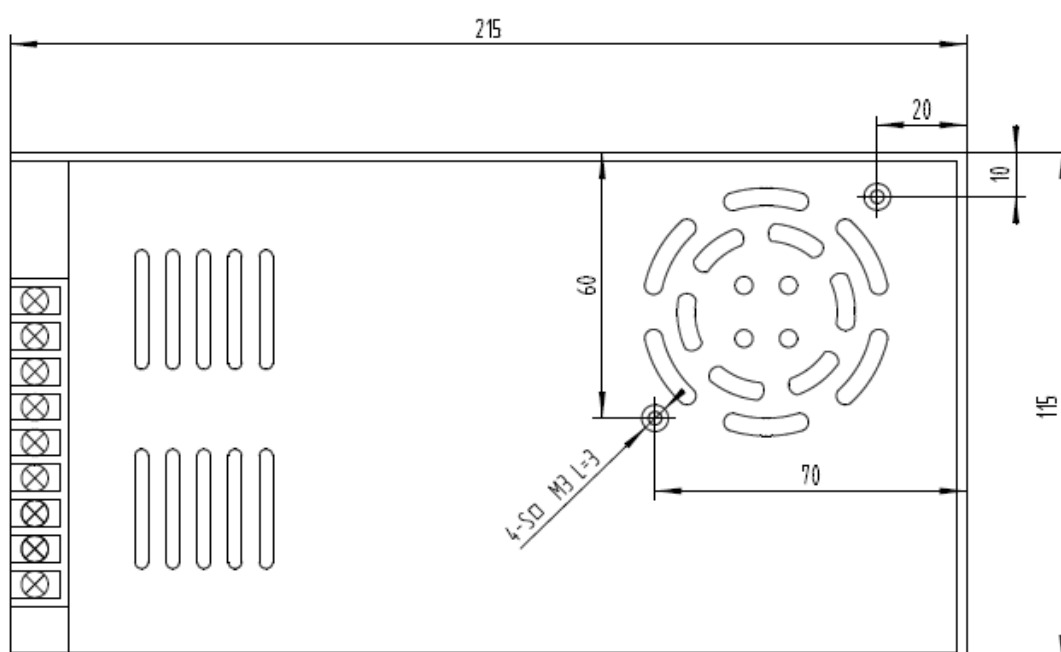
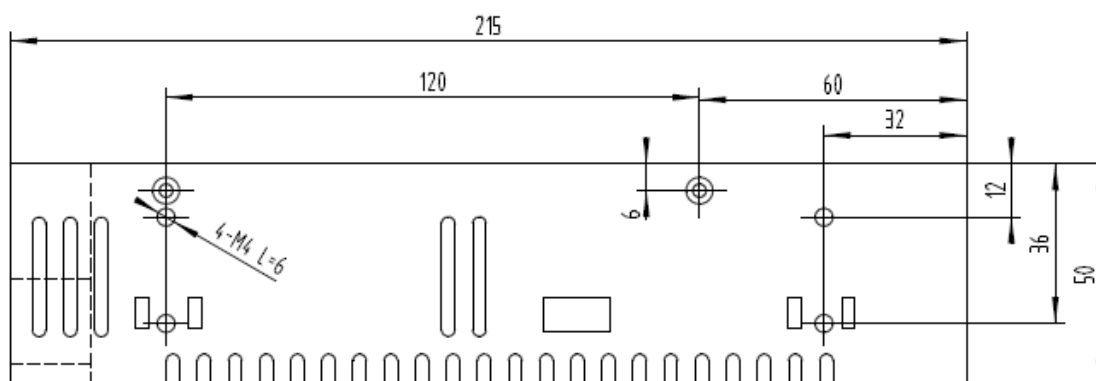

HCPOWER®

GK300