

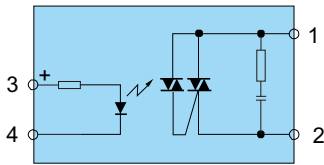

Mid-power SSR

Single-phase Mid-power SSR-4F

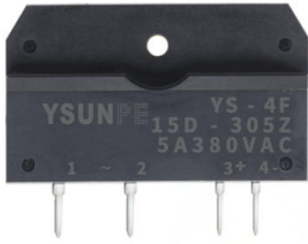

B1067040001

Product

- SIP mount
- load current: 5A, 8A
- Dielectric strength: 3000VAC
- Load voltage: 220VAC, 380VAC
- Trigger mode: Zero-cross and Non zero-cross

Ordering Reference

Input voltage	YS-4F/□-□□□
15D: 4-15VDC	32D: 15-32VDC
Load voltage	
2: 75 ~ 280VAC	3: 75 ~ 440VAC
Load current	
05: 5A	08: 8A
Trigger mode	
P: Non zero-cross	
Z: Zero-cross	

Application

- Household appliances, such as air conditioner, humidifier
- Medical treatment and medical devices
- CNC machine robot machine etc.

Model/Package

Model / Specification		Off-state peak voltage	On-state RMS current	Package quantity
Non zero-cross	Zero-cross			
15D-205P	15D-205Z	600V	5A	40 PCS/box 22 boxes/carton
32D-205P	32D-205Z			
—	15D-305Z	800V		
—	32D-305Z			
15D-208P	15D-208Z	600V	8A	
32D-208P	32D-208Z			
—	15D-308Z	800V		
—	32D-308Z			

Technical parameters

■ Max rated parameters (Environment temperature : 25°C)

Item		Symbol	15D-205	32D-205	15D-208	32D-208	15D-305	32D-305	Unit
Input	Work voltage		4 ~ 15	15 ~ 32	4 ~ 15	15 ~ 32	4 ~ 15	15 ~ 32	V
	Turn-on voltage	V_{TON}	4	15	4	15	4	4	V
	Turn-off voltage	V_{TOFF}	1	1	1	1	1	1	V
Output	On-state RMB current	$I_{T(RMS)}$	5	5	8	8	5	5	A
	Surge current(10ms)	I_{TSM}	80	80	100	100	80	80	A
	Repetitive peak off-state voltage	V_{DRM}	600				800		V_{PK}
Dielectric voltage	Input-output	V_{iso}	3000						VAC
Temperature	Work temperature	T_{opr}	-30 ~ 80						°C
	Storage temperature	T_{stg}	-40 ~ 100						°C

■ Electric parameters (Environment temperature 25°C)

Item		Symbol	Test condition	Min	Typical	Max	Unit
Input	Max input current	I_{max}	$V_{in} = Max$			25	mA
	Input resistance	R_{in}	15D		620		Ω
32D				2		K Ω	
Output	On-state voltage drop	V_T	Rated load voltage 220VAC		1.2	1.6	V
	Output leakage current	I_{leak}	Load voltage 220VAC			1.5	mA
Transmission	Turn-on time	T_{on}	Zero-cross			10	mS
			Non zero-cross			1	mS
	Turn-off time	T_{off}				10	mS
	Insulation resistance	R_{iso}	500VDC(input-output)			1000	ΩM

■ Switch Time Waveform:

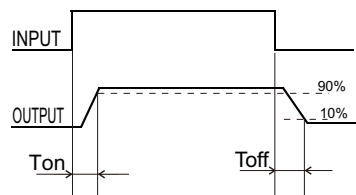

Characteristic curve

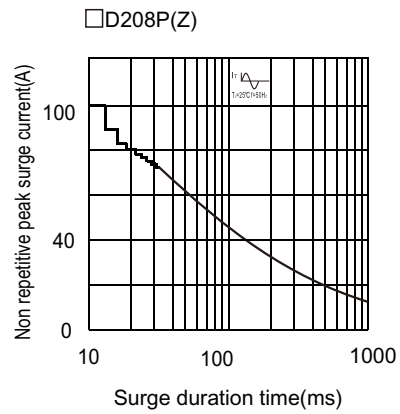
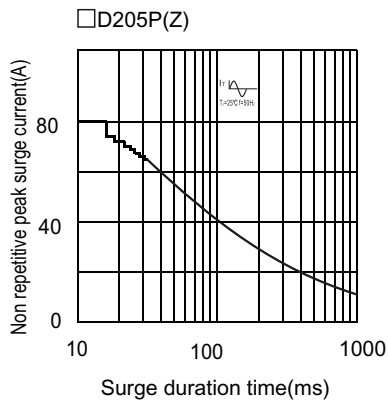
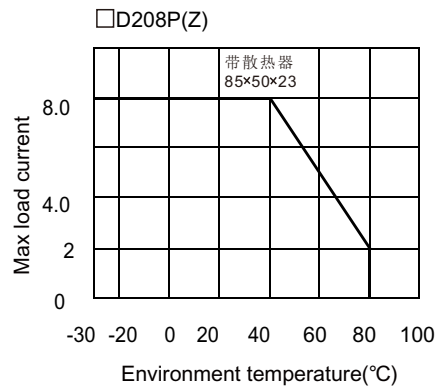
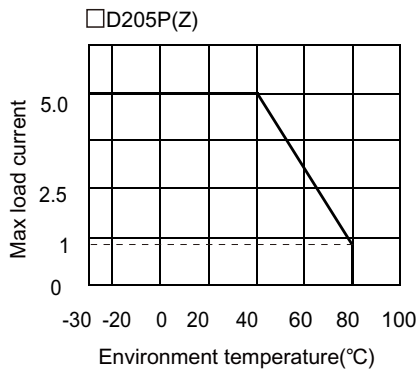

Outline dimensions

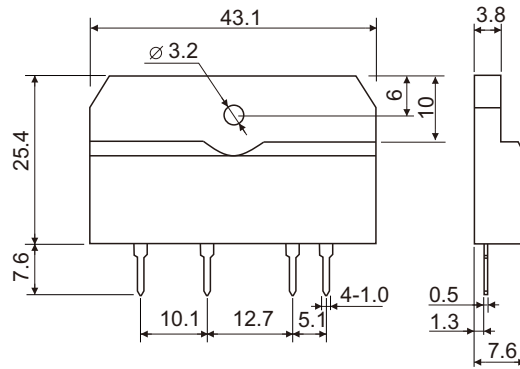

Connection diagram

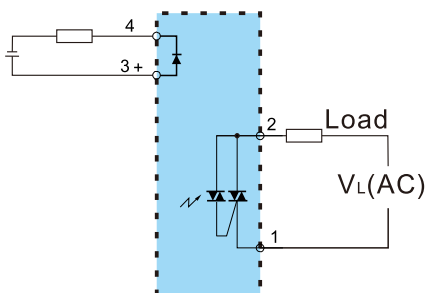

PCB dimensions(mm)

