

REV	CONTENT	CHK	DATE
V0.0	CONTENT	MYZ	21.07.03

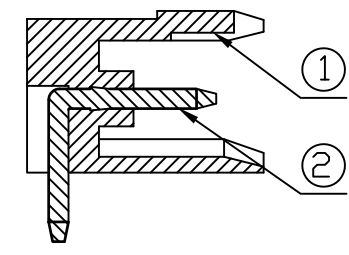

Electrical :

- 1.Rated Voltage : UL 300V IEC 320V
- 2.Rated Current : 15A 20A
- 3.Withstanding Voltage : AC1600V/1Min.
- 4.Operating Temperature : -40°C~+105°C
- 5. RoHS Compliance
- 6.Safety Approval : **UL** **CE**
- 7."★" is the key quality control point

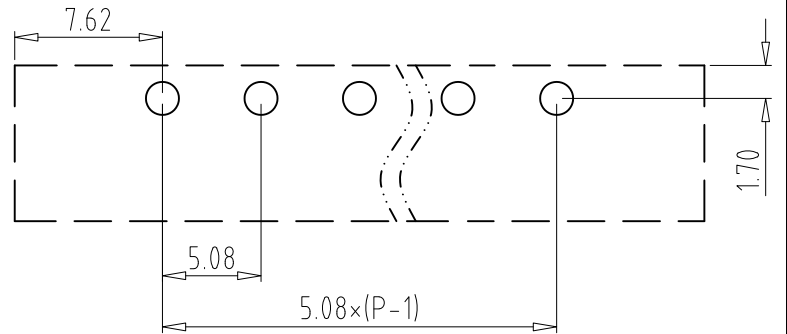
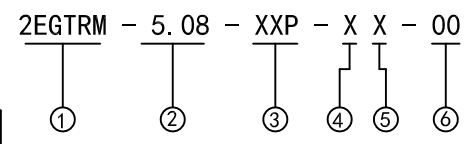
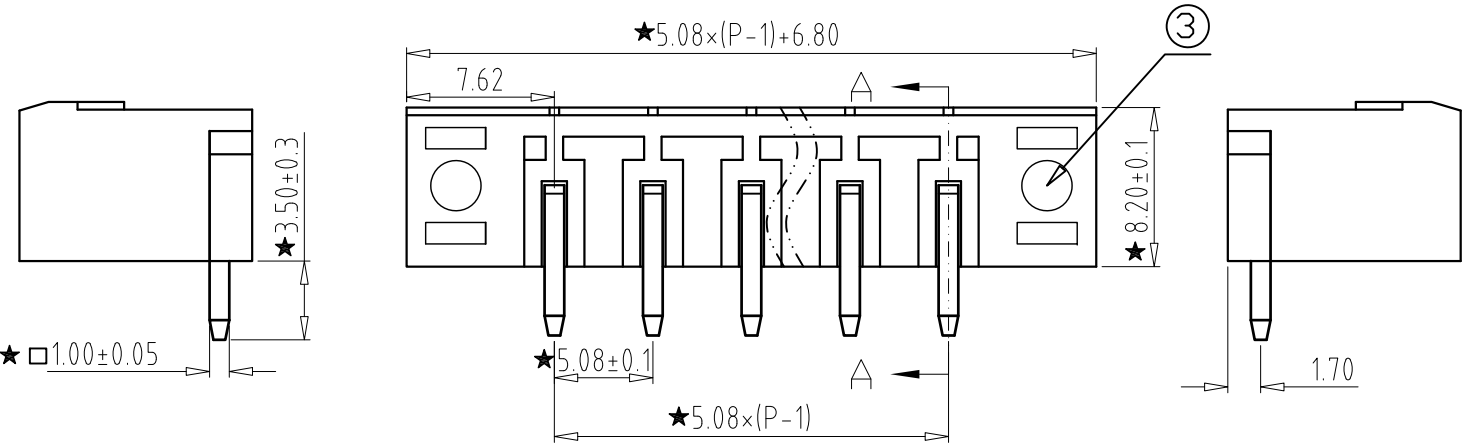

- ① Series NO.    ④ 1 Single Pitch  
                            2 Double Pitch
- ② Pitch                    ⑤ Color: 1 Grey  
                                    2 Blue  
                                    3 Black  
                                    4 Green  
③ Poles                    5 Orange  
02 02Contacts             6 Red  
03 03Contacts             7 Transparent  
...                              8 Yellow  
24 24Contacts             9 White

⑥ Customer Request: 00--Standard

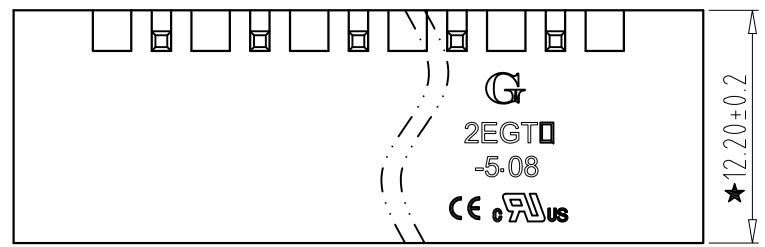

Total Pitch Tolerances in mm										Nominal dimension range in mm											⊥	=	-	//			
over 0	over 30	over 53	over 70	over 90	over 115	over 150	over 250	over 350	over 500	over 0	over 30	over 53	over 70	over 90	over 115	over 150	over 200	over 250	over 320	over 0	over 10	over 100	over 150	0	100	150	
±0.18	±0.20	±0.25	±0.3	±0.35	±0.4	±0.60	±0.70	±0.85	±0.20	±0.25	±0.30	±0.35	±0.44	±0.55	±0.70	±0.80	±0.90	0.2	0.3	0.3	0.3	0.2	0.3	0.5			

3	NUT	XX	2	Brass	/
2	PIN	XX	P	Brass	Tin Plated
1	HOUSING	XX	1	PA66(UL94V-0)	SEE NOTE
ITEM	NAME OF PART	NO. OF PART	Q'TY	MATERIAL	NOTE
DWG.	MYZ	DATE	21.07.03	SIZE	A4 UNITS mm SHEET/OF 1/1
CHK.	DATE	SCALE			1:1
APP.	DATE	NAME			2EGTRM-5.08-XXP-XX-00
				DWGNO.	XXXX