



BT169 Series 1A Sensitive SCRs

DESCRIPTION:

The BT169 SCR series provide high dv/dt rate with strong resistance to electromagnetic interference. They are especially recommended for use on residual current circuit breaker, straight hair, igniter etc.

MAIN FEATURES:

| symbol | value | unit |
|-------------------|------------|------|
| $I_{T(RMS)}$ | 1 | A |
| V_{DRM}/V_{RRM} | 600 | V |
| V_{TM} | ≤ 1.5 | V |

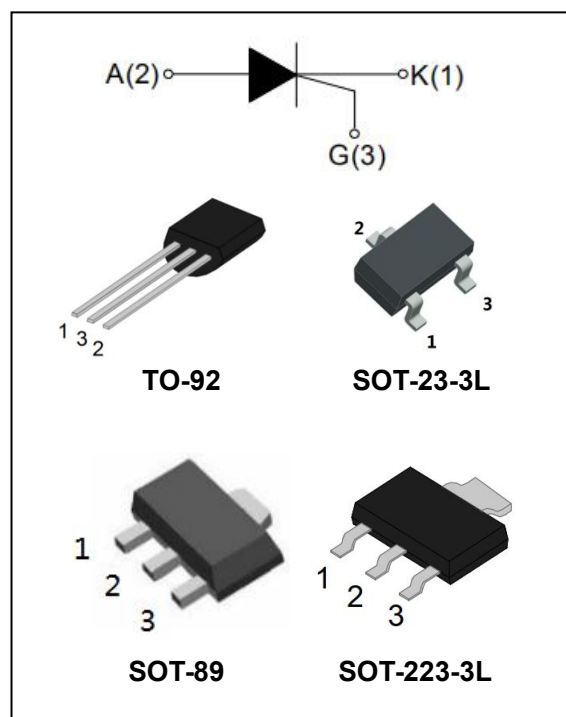

ABSOLUTE MAXIMUM RATINGS:

| Parameter | Symbol | Value | Unit |
|---|--------------|---------|-------------|
| Storage junction temperature range | T_{stg} | -40~150 | $^{\circ}C$ |
| Operating junction temperature range | T_j | -40~110 | $^{\circ}C$ |
| Repetitive peak off-state voltage ($T_j=25^{\circ}C$) | V_{DRM} | 600 | V |
| Repetitive peak reverse voltage ($T_j=25^{\circ}C$) | V_{RRM} | 600 | V |
| RMS on-state current | $I_{T(RMS)}$ | 1 | A |
| Non repetitive surge peak on-state current (full cycle, $F=50Hz$) | I_{TSM} | 10 | A |
| I^2t value for fusing ($t_p=10ms$) | I^2t | 0.50 | A^2s |
| Critical rate of rise of on-state current ($I_G=2 \times I_{GT}$) | di/dt | 50 | $A/\mu s$ |
| Peak gate current | I_{GM} | 0.2 | A |
| Average gate power dissipation | $P_{G(AV)}$ | 0.1 | W |
| Peak gate power | P_{GM} | 0.5 | W |



ELECTRICAL CHARACTERISTICS ($T_j=25^{\circ}\text{C}$ unless otherwise specified)

| Symbol | Test Condition | Value | | | Unit |
|----------|--|-------|------|-----|------------------|
| | | MIN | TYPE | MAX | |
| I_{GT} | $V_D=12\text{V}, R_L=33\Omega$ | - | 20 | 200 | μA |
| V_{GT} | | - | 0.6 | 0.8 | V |
| V_{GD} | $V_D=V_{DRM}, T_j=110^{\circ}\text{C}$ $R_L=3.3\text{k}\Omega$ | 0.2 | - | - | V |
| I_H | $I_T=50\text{mA}$ | - | - | 5 | mA |
| I_L | $I_G=1.2I_{GT}$ | - | - | 6 | mA |
| dV/dt | $V_D=0.66 \times V_{DRM}, T_j=110^{\circ}\text{C}$ G 极开路 $R_{GK}=1\text{k}\Omega$ | 10 | - | - | V/ μs |

STATIC CHARACTERISTICS

| Symbol | Test Condition | | Value | Unit |
|------------------------|---|---------------------------|-------|----------------------|
| V_{TM} | $I_{TM}=1.5\text{A}$ $t_p=380\mu\text{s}$ | $T_j=25^{\circ}\text{C}$ | MAX | 1.5 V |
| I_{DRM} I_{RRM} | $V_{DRM}=V_{RRM}$ $R_{GK}=1\text{k}\Omega$ | $T_j=25^{\circ}\text{C}$ | MAX | 5 μA |
| | | $T_j=110^{\circ}\text{C}$ | | 100 μA |

THERMAL RESISTANCES

| Symbol | Test Condition | | Value | Unit |
|---------------|----------------|-----------|-------|-----------------------------|
| $R_{th(j-c)}$ | 结到外壳(AC) | SOT-223 | 31 | $^{\circ}\text{C}/\text{W}$ |
| | | TO-92 | 75 | |
| | | SOT-23-3L | | |
| | | SOT-89 | 45 | |



Jiangsu Weida Semiconductor Co., Ltd.
BT169 Series 1A Sensitive SCRs

PACKAGE MECHANICAL DATA

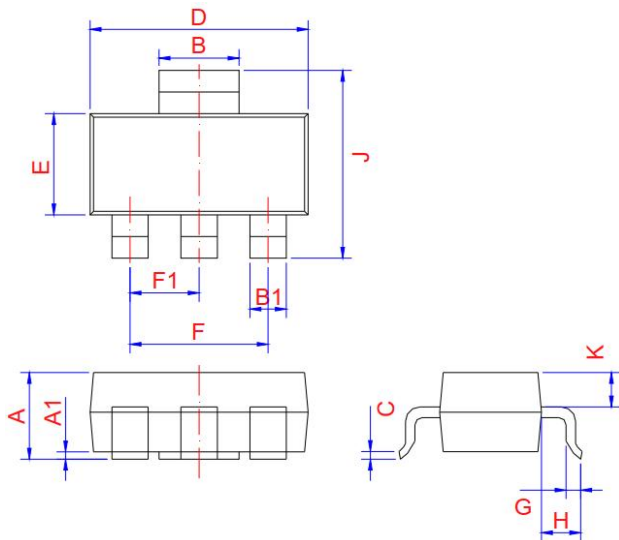

SOT-223-3L

| Ref. | Dimensions | | | | | |
|------|-------------|------|------|--------|-------|-------|
| | Millimeters | | | Inches | | |
| | Min. | Typ. | Max. | Min. | Typ. | Max. |
| A | 1.5 | 1.6 | 1.8 | 0.059 | 0.063 | 0.071 |
| A1 | 0.01 | 0.06 | 0.10 | 0.001 | 0.002 | 0.004 |
| B | 2.9 | 3.0 | 3.1 | 0.114 | 0.118 | 0.122 |
| B1 | 0.6 | 0.7 | 0.8 | 0.024 | 0.028 | 0.031 |
| C | 0.22 | 0.25 | 0.32 | 0.009 | 0.010 | 0.013 |
| D | 6.3 | 6.5 | 6.7 | 0.248 | 0.256 | 0.264 |
| E | 3.3 | 3.5 | 3.7 | 0.130 | 0.138 | 0.146 |
| F | | 4.6 | 6.8 | 0.252 | 0.181 | |
| F1 | | 2.3 | | | 0.091 | |
| G | 0.7 | 0.9 | 1.1 | 0.028 | 0.035 | 0.043 |
| H | 1.5 | 1.75 | 2.0 | 0.059 | 0.069 | 0.079 |
| J | 6.7 | 7.0 | 7.3 | 0.264 | 0.276 | 0.287 |
| K | 0.8 | 0.9 | 1.0 | 0.031 | 0.035 | 0.039 |

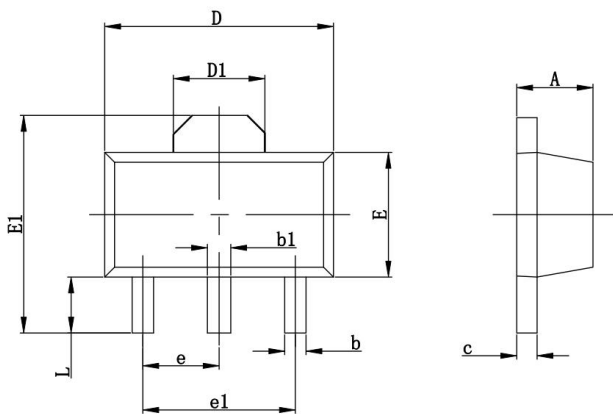

SOT-89-3L

| Ref. | Dimensions | | | | | |
|------|-------------|-------|------|--------|-------|-------|
| | Millimeters | | | Inches | | |
| | Min. | Typ. | Max. | Min. | Typ. | Max. |
| A | 1.4 | | 1.6 | 0.055 | | 0.063 |
| b | 0.35 | | 0.52 | 0.013 | | 0.197 |
| b1 | 0.4 | | 0.58 | 0.016 | | 0.023 |
| c | 0.35 | | 0.44 | 0.014 | | 0.017 |
| D | 4.4 | | 4.6 | 0.173 | | 0.181 |
| D1 | | 1.55 | | | 0.061 | |
| E | 2.35 | | 2.55 | 0.091 | | 0.102 |
| E1 | 3.94 | | 4.25 | 0.155 | | 0.167 |
| e | | 1.500 | | | 0.060 | |
| e1 | | 3.000 | | | 0.118 | |
| L | 0.9 | | 1.1 | 0.035 | | 0.047 |



Jiangsu Weida Semiconductor Co., Ltd.
BT169 Series 1A Sensitive SCRs

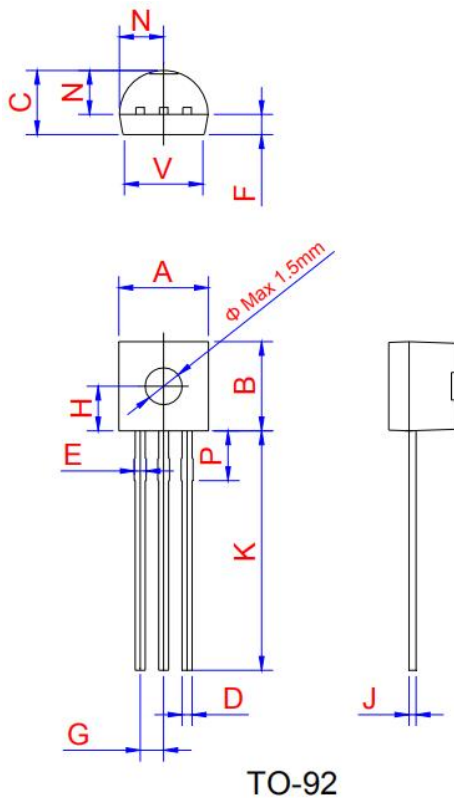

| Ref. | Dimensions | | | | | |
|------|-------------|------|-------|--------|-------|-------|
| | Millimeters | | | Inches | | |
| | Min. | Typ. | Max. | Min. | Typ. | Max. |
| A | 4.45 | 4.6 | 5.2 | 0.175 | 0.181 | 0.205 |
| B | 4.32 | 4.6 | 5.33 | 0.17 | 0.181 | 0.21 |
| C | 3.18 | 3.55 | 4.19 | 0.125 | 0.14 | 0.165 |
| D | 0.407 | | 0.533 | 0.016 | | 0.021 |
| E | 0.6 | | 0.8 | 0.024 | 0 | 0.031 |
| F | - | 1.1 | - | - | 0.043 | - |
| G | - | 1.27 | - | - | 0.05 | - |
| H | - | 2.3 | - | - | 0.091 | - |
| J | 0.36 | 0.38 | 0.5 | 0.014 | 0.015 | 0.02 |
| K | 12.7 | | 15 | 0.5 | | 0.591 |
| N | 2.04 | 2.3 | 2.66 | 0.08 | 0.091 | 0.105 |
| P | 1.86 | | 2.06 | 0.073 | | 0.081 |
| V | - | | 4.3 | - | | 0.169 |

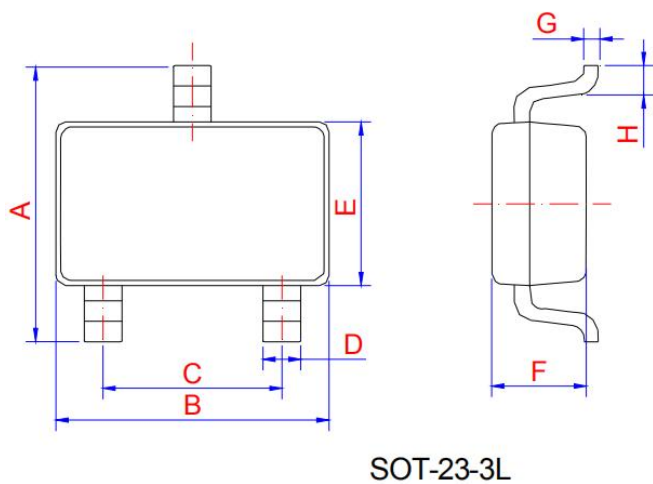

| Ref. | Dimensions | | | | | |
|------|-------------|------|------|--------|-------|-------|
| | Millimeters | | | Inches | | |
| | Min. | Typ. | Max. | Min. | Typ. | Max. |
| A | 2.65 | 2.8 | 2.95 | 0.104 | 0.11 | 0.116 |
| B | 2.82 | 2.92 | 3.02 | 0.111 | 0.115 | 0.119 |
| C | 1.8 | 1.9 | 2 | 0.071 | 0.075 | 0.079 |
| D | 0.3 | 0.35 | 0.5 | 0.012 | 0.014 | 0.02 |
| E | 1.5 | 1.6 | 1.7 | 0.059 | 0.063 | 0.067 |
| F | 1.07 | 1.17 | 1.27 | 0.042 | 0.046 | 0.05 |
| G | 0.05 | 0.15 | 0.25 | 0.002 | 0.006 | 0.01 |
| H | 0.25 | 0.4 | 0.55 | 0.01 | 0.016 | 0.022 |



Jiangsu Weida Semiconductor Co., Ltd.

BT169 Series 1A Sensitive SCRs

FIG.1: Maximum power dissipation versus RMS on-state current

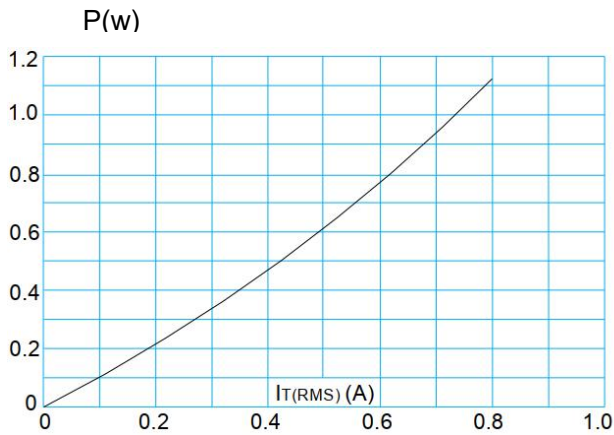

FIG.2: RMS on-state current versus case temperature

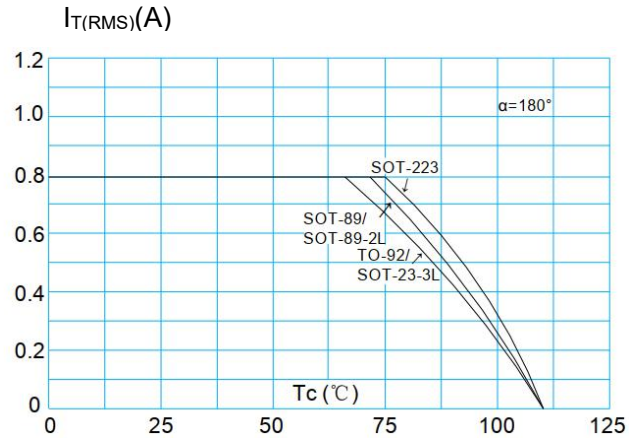

FIG.3: Surge peak on-state current versus number of cycles

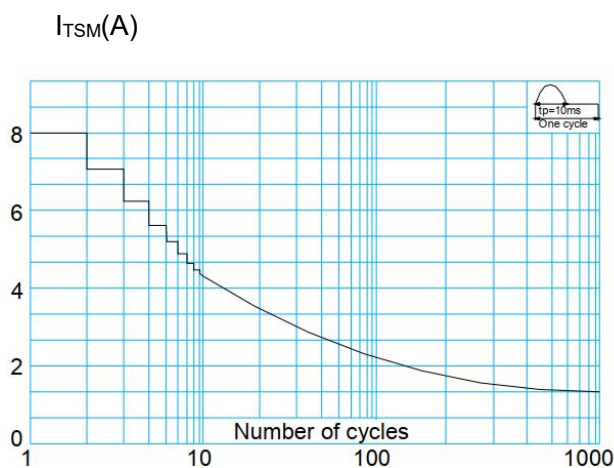

FIG.4: On-state characteristics (maximum values)

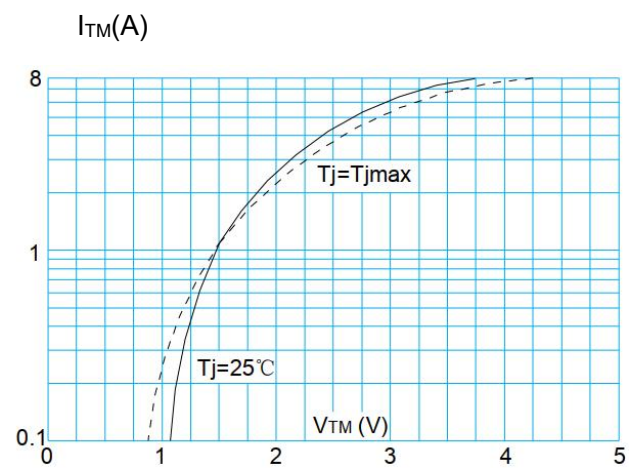

FIG.5: Non-repetitive surge peak on-state current for a sinusoidal pulse with width $t_p < 20\text{ms}$, and corresponding value of $I^2 t$ ($di/dt < 50\text{A}/\mu\text{s}$)

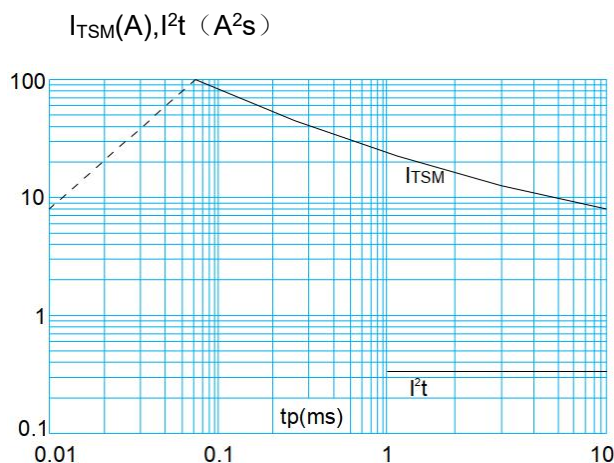
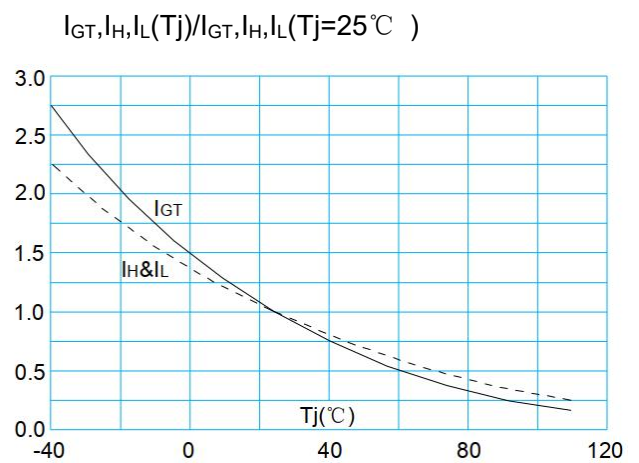

FIG.6: Relative variations of gate trigger current, holding current and latching current versus junction temperature





Jiangsu Weida Semiconductor Co., Ltd.
BT169 Series 1A Sensitive SCRs

Information furnished in this document is believed to be accurate and reliable. However, Jiangsu Weida Semiconductor Co., Ltd assumes no responsibility for the consequences of use without consideration for such information nor use beyond it.

Information mentioned in this document is subject to change without notice, apart from that when an agreement is signed, Jiangsu Weida Semiconductor Co., Ltd complies with the agreement.

Products and information provided in this document have no infringement of patents. Jiangsu Weida Semiconductor Co., Ltd assumes no responsibility for any infringement of other rights of third parties which may result from the use of such products and information.