

REV.	DESCRIPTION	DRAWN	DATE
1	INITIAL RELEASE	FROS	2016/08/17
2	CHANGE P/N	FROS	2016/10/11

PACKAGING SPECIFICATION:

- 20pcs/ Vacuum Dish
- 560pcs/ Carton
- Vacuum Dish size: 292x187x18mm
- Carton: 380x315x290mm

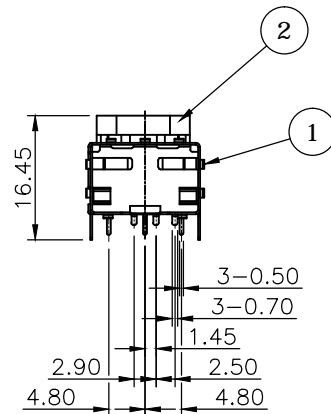
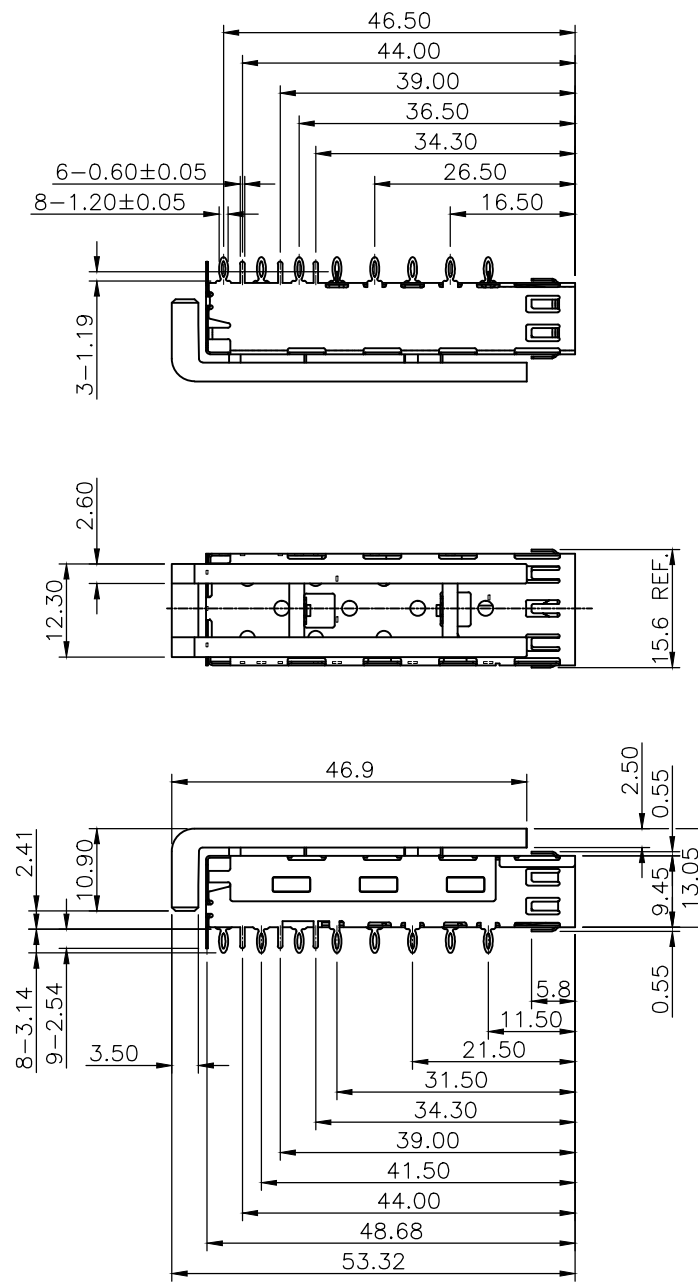
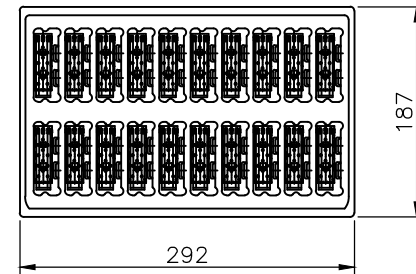

2	LIGHT PIPE	PC							
1	CAGE	Copper Alloy, Nickel Plating							
NO. PART NAME		DESCRIPTION							
UNLESS OTHERWISE SPECIFIED TOLERANCE									
UNIT:	DECIMAL	LINEAR	ANGLES						
mm	X.	±0.50	±5°						
	X.X	±0.25	±3°						
	X.XX	±0.12	±1°						
DRAWN			Fros	2016/08/17	DRAWN NAME: SFP Cage, 1x1 Press Fit Type w/Light Pipe				
CHECKED			Tim	2016/08/17					
APPROVED			Ken	2016/08/17	PRODUCT NO. 223A-1105				
SCALE			1/1	SHEET	1/2	SIZE	A4	FILE NAME	223A-1105_B_2



WWW.ATTEND.COM.TW

2/2

REV.	DESCRIPTION	DRAWN	DATE
	SEE SHEET ONE		

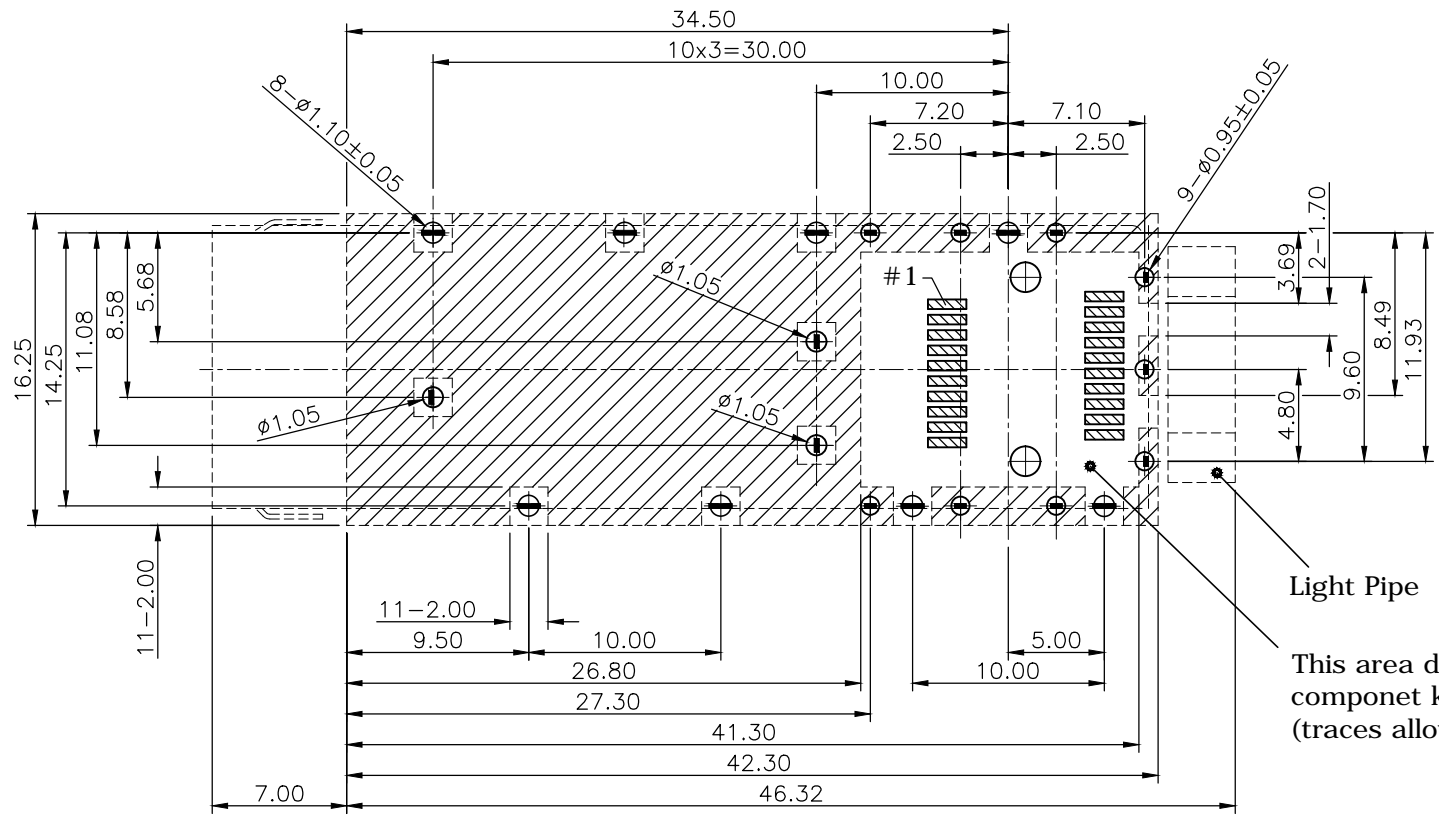

- Cage Boundary
- Component and trace keep-out (except chassis ground)
- Connector PAD

Light Pipe

This area denotes component keep-out (traces allowed)

Recommended Layout (top view)
General Tolerance: ±0.05mm

UNLESS OTHERWISE SPECIFIED TOLERANCE							
UNIT:	DECIMAL	LINEAR	ANGLES			WWW.ATTEND.COM.TW	
mm	X.	±0.50	±5°				
	X.X	±0.25	±3°				
	X.XX	±0.12	±1°				
DRAWN	Fros	2016/08/17	DRAWN NAME: SFP Cage, 1x1 Press Fit Type w/Light Pipe				
CHECKED	Tim	2016/08/17	PRODUCT NO. 223A-1105				
APPROVED	Ken	2016/08/17	FILE NAME 223A-1105_B_2				
	SCALE 2.5/1	SHEET 2/2	SIZE A4				

REV.	DESCRIPTION	DRAWN	DATE
1	INITIAL RELEASE	FROS	2016/08/17
2	CHANGE P/N	FROS	2016/10/11

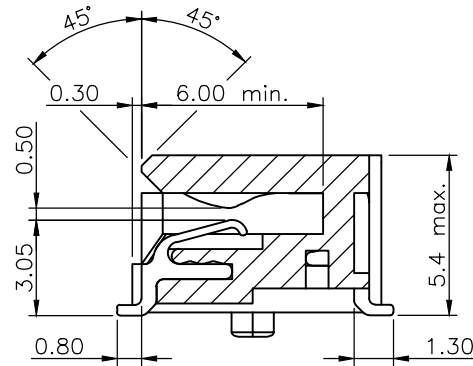
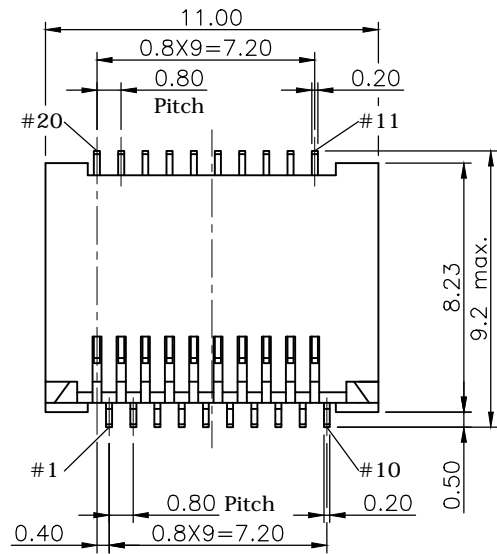

SECTION A-A

SPECIFICATION:

1. ELECTRICAL
 - 1.1 Current Rating: 0.5A MAX.
 - 1.2 Voltage Rating: 30V AC/DC
 - 1.3 Contact Resistance: 20mΩ
 - 1.4 Insulation Resistance: 500MΩ
 - 1.5 Differential Impedance: 100Ω

2. MECHANICAL

- 2.1 MATERIAL:
 - Housing: LCP UL94V-0, Black
 - Contact: Phosphor Bronze, 0.2T
- 2.2 Operating Life : 250 Cycles Min.

3. ENVIRONMENTAL

- 3.1 Operating temperature range: -40°C ~ +85°C
- 3.2 Storage temperature range: -40°C ~ +85°C
- 3.3 IR Temperature: 255°C±5°C (5 to 10 sec)

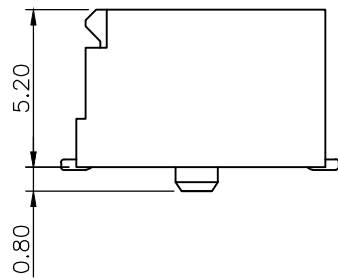
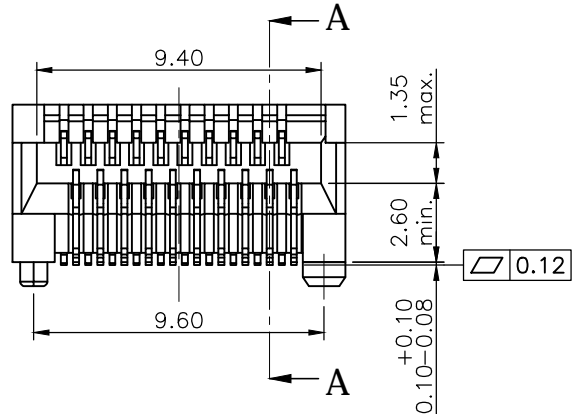

How to order

223A- 00 C 0

Connector 5u" Gold plating

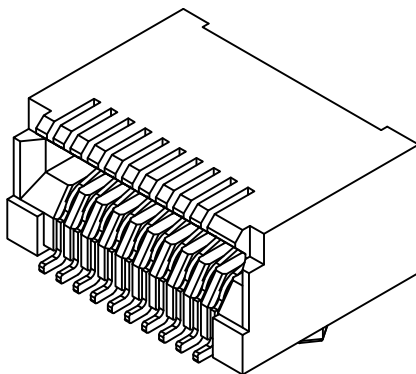
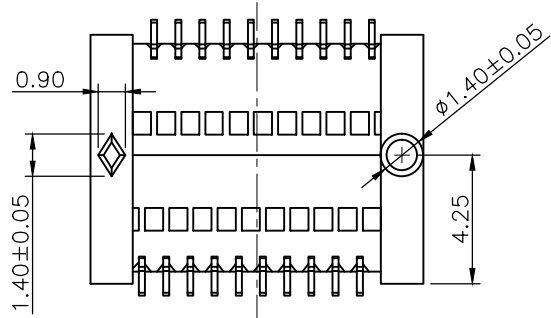

UNLESS OTHERWISE SPECIFIED TOLERANCE							
UNIT:	DECIMAL	LINEAR	ANGLES			WWW.ATTEND.COM.TW	
mm	X.	±0.50	±5°	DRAWN: Willis 2009/10/14 CHECKED: Angel 2009/10/14 APPROVED: Ken 2009/10/14 SCALE: 4/1 SHEET: 1/2 SIZE: A4			
	X.X	±0.25	±3°			DRAWN NAME: 1x1 SFP Connector 20Pin	
	X.XX	±0.12	±1°			PRODUCT NO. 223A-00C0	
DRAWN		Willis	2009/10/14	FILE NAME: 223A-00C0_B_1			
CHECKED		Angel	2009/10/14				
APPROVED		Ken	2009/10/14				

REV.	DESCRIPTION	DRAWN	DATE
	SEE SHEET ONE		

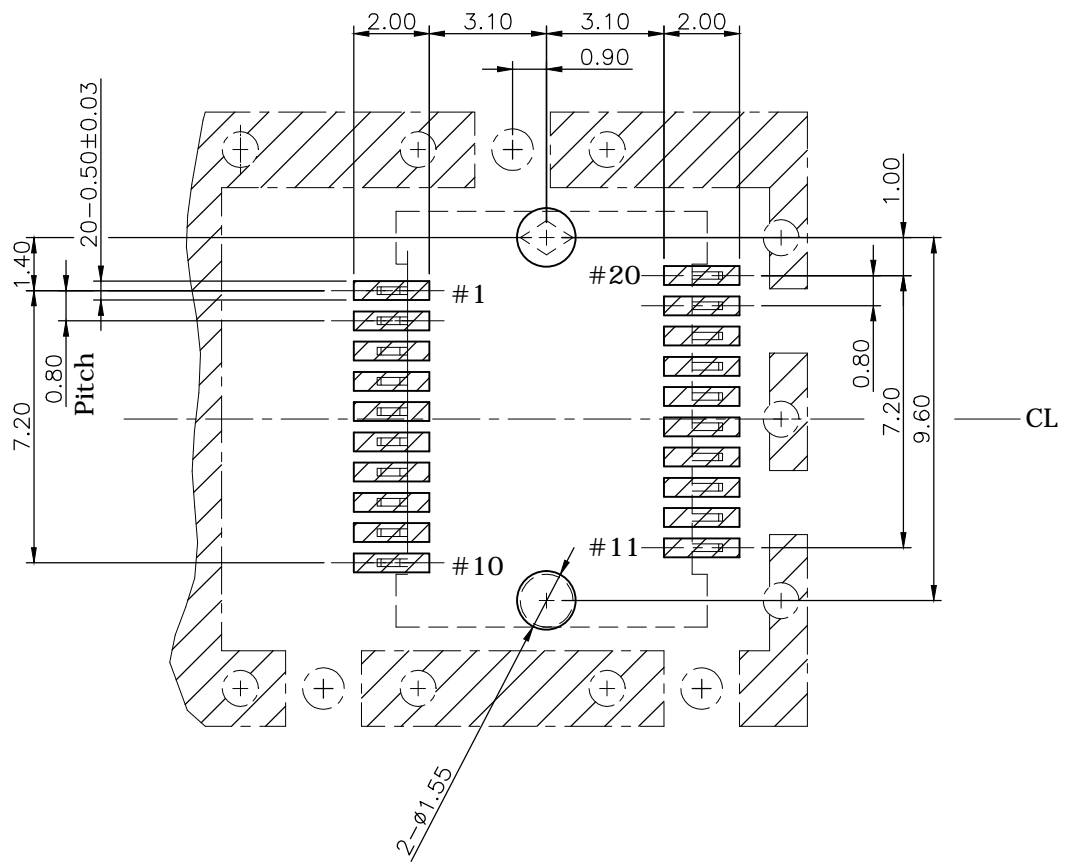

- SFP CONNECTOR
- PAD
- CAGE

RECOMMENDED LAYOUT (TOP VIEW)
GENERAL TOLERANCE: ±0.05mm

UNLESS OTHERWISE SPECIFIED TOLERANCE					
UNIT:	DECIMAL	LINEAR	ANGLES		
mm	X.	±0.50	±5°	WWW.ATTEND.COM.TW	
	X.X	±0.25	±3°		
	X.XX	±0.12	±1°		
DRAWN	Willis	2009/10/14	DRAWN NAME: 1x1 SFP Connector 20Pin		
CHECKED	Angel	2009/10/14			
APPROVED	Ken	2009/10/14	PRODUCT NO.	223A-00C0	2
	SCALE 5/1	SHEET 2/2	SIZE A4	FILE NAME	223A-00C0_B_1 2