

REV.	DESCRIPTION	DRAWN	DATE
1	INITIAL RELEASE	FROS	2016/08/17
2	CHANGE P/N	FROS	2016/10/11

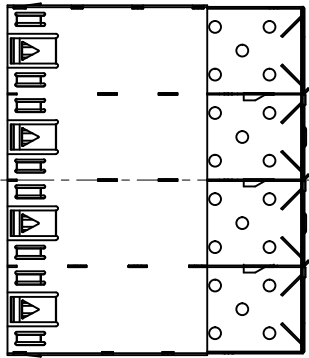

BOTTOM VIEW

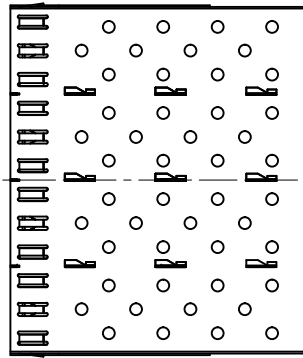

TOP VIEW

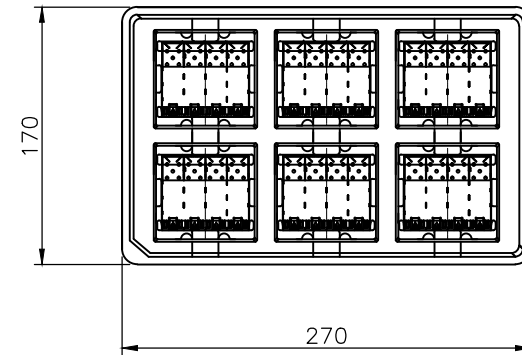

PACKAGING SPECIFICATION:

- 6pcs/ Vacuum Dish
- 204pcs/ Carton
- Vacuum Dish size: 270x170x16.5mm
- Carton: 365*295*365mm

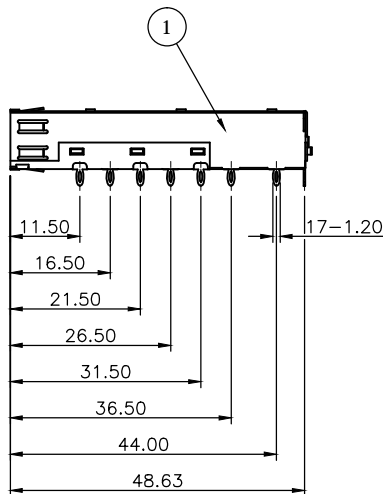
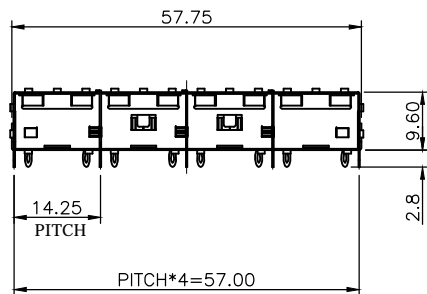

SEE BOTTOM VIEW

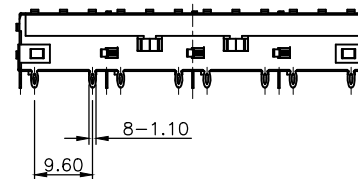

1	CAGE	Copper alloy, Nickel plating		
NO.	PART NAME	DESCRIPTION		
UNLESS OTHERWISE SPECIFIED TOLERANCE				
UNIT:	DECIMAL	LINEAR	ANGLES	
mm	X.	±0.50	±5°	
	X.X	±0.25	±3°	
	X.XX	±0.12	±1°	
WWW.ATTEND.COM.TW				
DRAWN	Fros	2016/08/17	DRAWN NAME:	
CHECKED	Tim	2016/08/17	SFP Cage 1x4 Press Fit Type	
APPROVED	Ken	2016/08/17	PRODUCT NO.	223A-1401
SCALE 1/1		SHEET 1/2	SIZE A4	FILE NAME 223A-1401_B_2



REV.	DESCRIPTION	DRAWN	DATE
	SEE SHEET ONE		

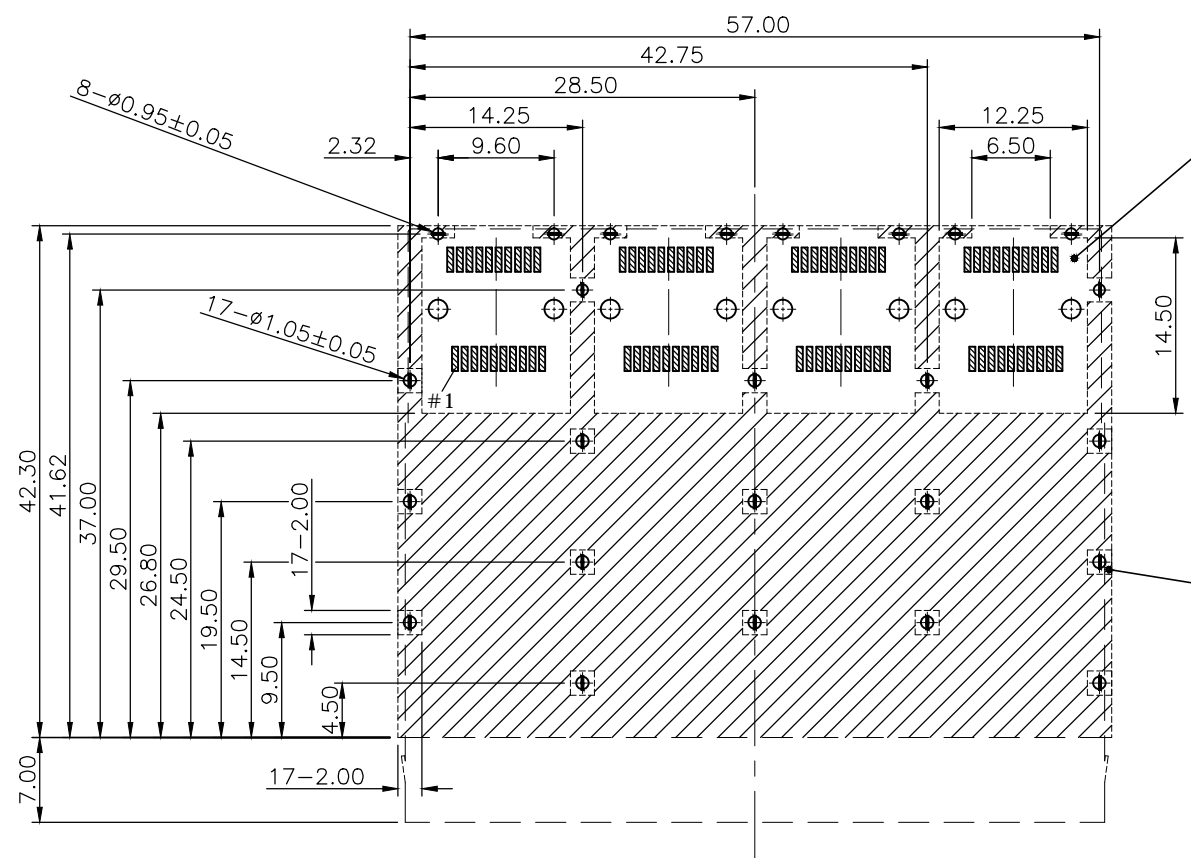

This area denotes component keep-out (traces allowed)

- Cage Boundary
- Component and trace keep-out (except chassis ground)
- Connector PAD

PADS and VIAS are chassis ground

Recommended Layout (top view)
General Tolerance: ±0.05mm

UNLESS OTHERWISE SPECIFIED TOLERANCE							
UNIT:	DECIMAL	LINEAR	ANGLES			WWW.ATTEND.COM.TW	
mm	X.	±0.50	±5°			DRAWN NAME: SFP Cage 1x4 Press Fit Type	
	X.X	±0.25	±3°			DRAWN: Fros 2016/08/17	
	X.XX	±0.12	±1°	CHECKED: Tim 2016/08/17			
DRAWN	Fros	2016/08/17	APPROVED: Ken 2016/08/17		PRODUCT NO. 223A-1401		
CHECKED	Tim	2016/08/17	SCALE 1.6/1		FILE NAME 223A-1401_B_2		
APPROVED	Ken	2016/08/17	SHEET 2/2	SIZE A4			

REV.	DESCRIPTION	DRAWN	DATE
1	INITIAL RELEASE	FROS	2016/08/17
2	CHANGE P/N	FROS	2016/10/11

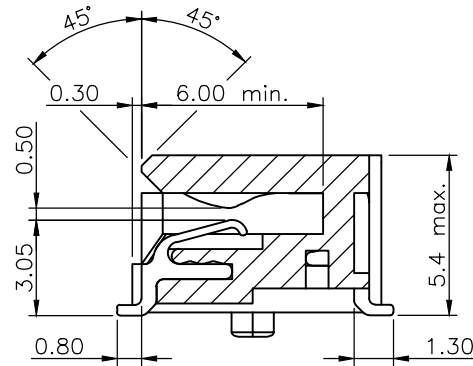
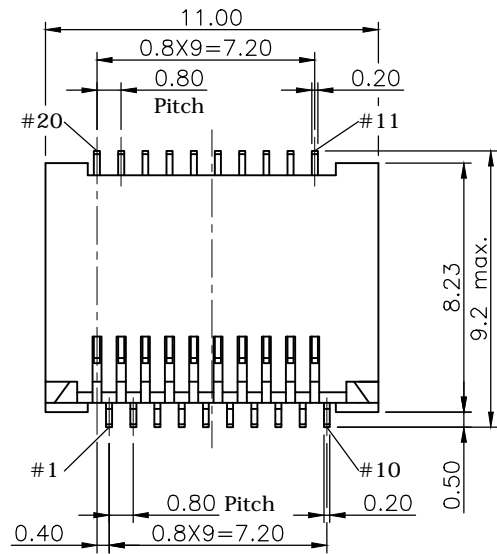

SECTION A-A

SPECIFICATION:

1. ELECTRICAL
 - 1.1 Current Rating: 0.5A MAX.
 - 1.2 Voltage Rating: 30V AC/DC
 - 1.3 Contact Resistance: 20mΩ
 - 1.4 Insulation Resistance: 500MΩ
 - 1.5 Differential Impedance: 100Ω

2. MECHANICAL

- 2.1 MATERIAL:
 - Housing: LCP UL94V-0, Black
 - Contact: Phosphor Bronze, 0.2T
- 2.2 Operating Life : 250 Cycles Min.

3. ENVIRONMENTAL

- 3.1 Operating temperature range: -40°C ~ +85°C
- 3.2 Storage temperature range: -40°C ~ +85°C
- 3.3 IR Temperature: 255°C±5°C (5 to 10 sec)

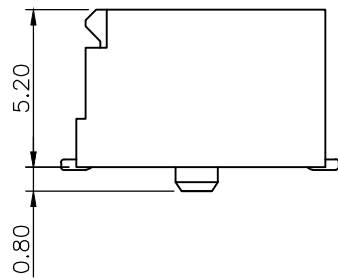
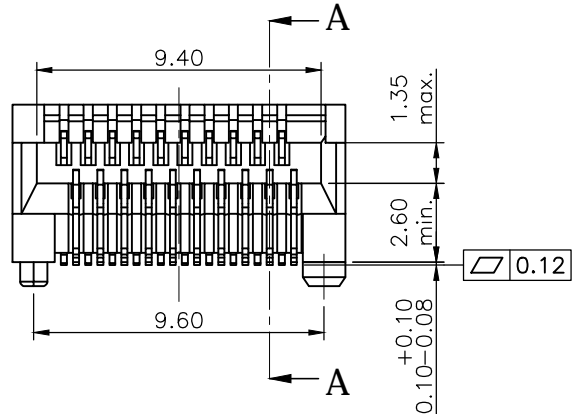

How to order

223A- 00 C 0

Connector 5u" Gold plating

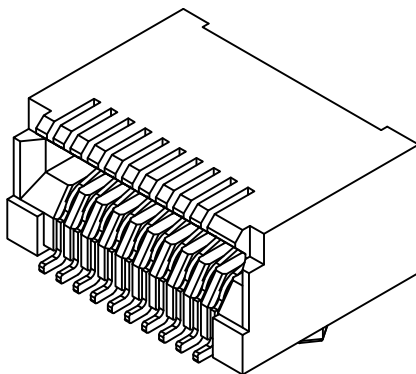
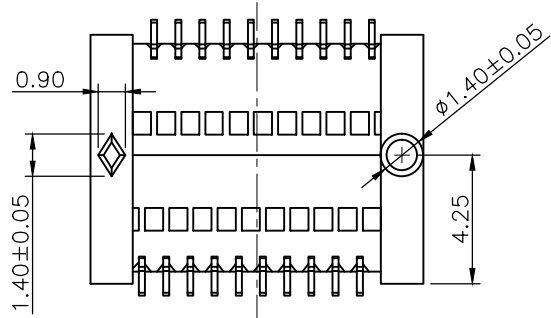

UNLESS OTHERWISE SPECIFIED TOLERANCE					
UNIT:	DECIMAL	LINEAR	ANGLES		
mm	X.	±0.50	±5°	WWW.ATTEND.COM.TW	
	X.X	±0.25	±3°		
	X.XX	±0.12	±1°		
DRAWN	Willis	2009/10/14	DRAWN NAME: 1x1 SFP Connector 20Pin		
CHECKED	Angel	2009/10/14			
APPROVED	Ken	2009/10/14	PRODUCT NO.	223A-00C0	
SCALE	4/1	SHEET	1/2	SIZE	A4
			FILE NAME	223A-00C0_B_1	

REV.	DESCRIPTION	DRAWN	DATE
	SEE SHEET ONE		

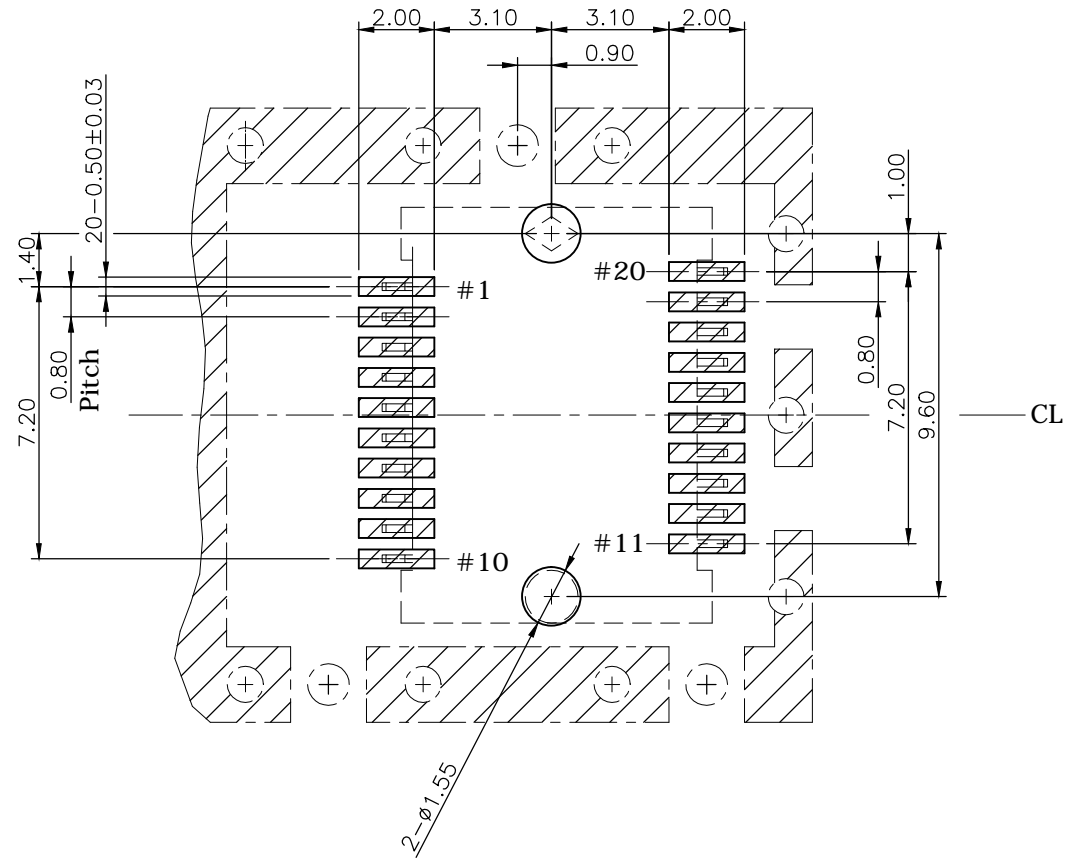

- SFP CONNECTOR
- PAD
- CAGE

RECOMMENDED LAYOUT (TOP VIEW)
GENERAL TOLERANCE: ±0.05mm

UNLESS OTHERWISE SPECIFIED TOLERANCE							
UNIT:	DECIMAL	LINEAR	ANGLES			WWW.ATTEND.COM.TW	
mm	X.	±0.50	±5°			DRAWN NAME: 1x1 SFP Connector 20Pin	
	X.X	±0.25	±3°				
	X.XX	±0.12	±1°				
DRAWN	Willis	2009/10/14	DRAWN NAME: 1x1 SFP Connector 20Pin				
CHECKED	Angel	2009/10/14	DRAWN NAME: 1x1 SFP Connector 20Pin				
APPROVED	Ken	2009/10/14	PRODUCT NO.	223A-00C0	2		
	SCALE	5/1	SHEET	2/2	SIZE	A4	
			FILE NAME	223A-00C0_B_1	2		